

V_{RRM}	=	4500 V
I_{FAVM}	=	810 A
I_{FSM}	=	24 kA
V_{F0}	=	2.42 V
r_F	=	1.1 m Ω
V_{DClink}	=	2800 V

Fast Recovery Diode

5SDF 10H4502

PRELIMINARY

Doc. No. 5SYA1115-03 Sep. 01

- Patented free-floating technology
- Industry standard housing
- Cosmic radiation withstand rating
- Low on-state and switching losses
- Optimized to use in snubberless operation

Blocking

V_{RRM}	Repetitive peak reverse voltage	4500 V	Half sine wave, $t_p = 10$ ms, $f = 50$ Hz	
I_{RRM}	Repetitive peak reverse current	≤ 30 mA	$V_R = V_{RRM}, T_J = 115^\circ\text{C}$	
V_{DClink}	Permanent DC voltage for 100 FIT failure rate	2800 V	100% Duty	Ambient cosmic radiation at sea level in open air.
V_{DClink}	Permanent DC voltage for 100 FIT failure rate	3200 V	5% Duty	

Mechanical data

F_m	Mounting force	min.	42 kN	
		max.	46 kN	
a	Acceleration: Device unclamped Device clamped		50 m/s ²	
			200 m/s ²	
m	Weight		0.83 kg	
D_s	Surface creepage distance	\geq	30 mm	
D_a	Air strike distance	\geq	20 mm	

ABB Semiconductors AG reserves the right to change specifications without notice.



On-state (see Fig. 1, 2)

I_{FAVM}	Max. average on-state current	810 A	Half sine wave, $T_c = 70^\circ\text{C}$	
I_{FRMS}	Max. RMS on-state current	1270 A		
I_{FSM}	Max. peak non-repetitive surge current	24 kA	$t_p = 10\text{ ms}$	Before surge: $T_c = T_j = 115^\circ\text{C}$
		40 kA	$t_p = 1\text{ ms}$	
$\int i^2 dt$	Max. surge current integral	$2.88 \cdot 10^6\text{ A}^2\text{s}$	$t_p = 10\text{ ms}$	After surge: $V_R \approx 0\text{ V}$
		$0.8 \cdot 10^6\text{ A}^2\text{s}$	$t_p = 1\text{ ms}$	
V_F	Forward voltage drop	$\leq 4.85\text{ V}$	$I_F = 2200\text{ A}$	$T_j = 115^\circ\text{C}$
V_{F0}	Threshold voltage	2.42 V	Approximation for	
r_F	Slope resistance	1.1 m Ω	$I_F = 400 \dots 3000\text{ A}$	

Turn-on (see Fig. 3, 4)

V_{fr}	Peak forward recovery voltage	$\leq 370\text{ V}$	$di/dt = 1000\text{ A}/\mu\text{s}$, $T_j = 115^\circ\text{C}$
----------	-------------------------------	---------------------	---

Turn-off

di/dt_{crit}	Max. decay rate of on-state current	$\leq 650\text{ A}/\mu\text{s}$	$I_F = 2200\text{ A}$, $V_{Dclink} = 2800\text{ V}$	$T_j = 115^\circ\text{C}$
I_{rr}	Reverse recovery current	$\leq 1150\text{ A}$		
Q_{rr}	Reverse recovery charge	$\leq 2200\text{ }\mu\text{C}$		
E_{rr}	Turn-off energy	$\leq 4.5\text{ J}$		

Thermal

T_j	Operating junction temperature range	-40...115 $^\circ\text{C}$		
T_{stg}	Storage temperature range	-40...125 $^\circ\text{C}$		
R_{thJC}	Thermal resistance junction to case	$\leq 24\text{ K/KW}$	Anode side cooled	$F_m =$ 42... 46 kN
		$\leq 24\text{ K/KW}$	Cathode side cooled	
		$\leq 12\text{ K/KW}$	Double side cooled	
R_{thCH}	Thermal resistance case to heatsink	$\leq 6\text{ K/KW}$	Single side cooled	
		$\leq 3\text{ K/KW}$	Double side cooled	

Analytical function for transient thermal impedance.

$$Z_{thJC}(t) = \sum_{i=1}^n R_i (1 - e^{-t/\tau_i})$$

i	1	2	3	4
$R_i(\text{K/KW})$	5.64	2.01	0.74	0.40
$\tau_i(\text{s})$	0.524	0.0632	0.0065	0.0015
$F_m = 42 \dots 46\text{ kN}$ Double side cooled				

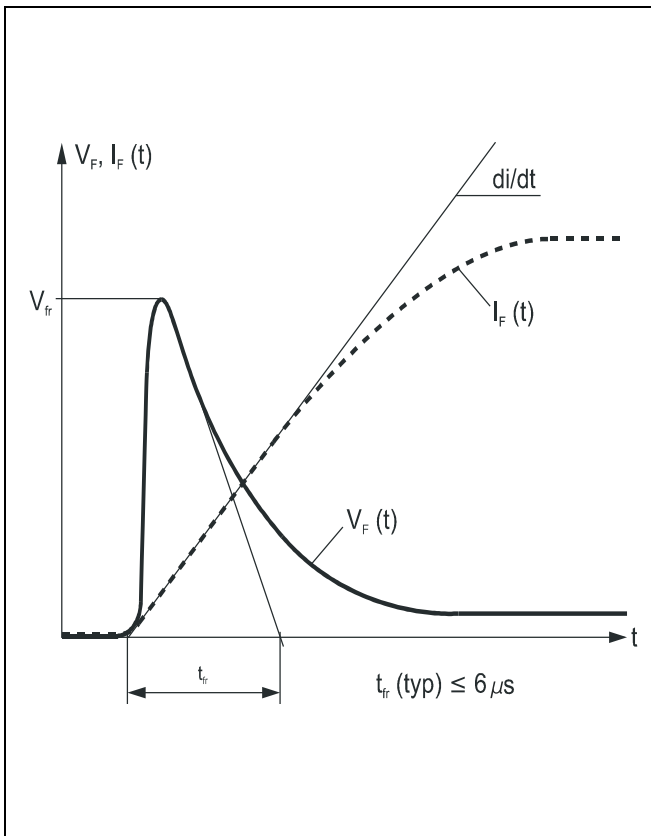

Fig. 1 Typical forward voltage waveform when the diode is turned on with high di/dt.

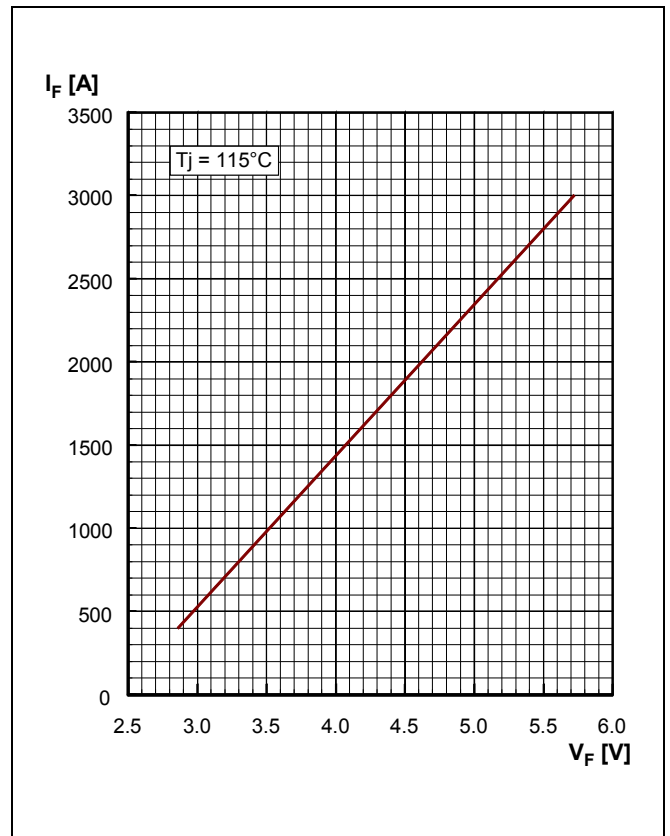

Fig. 2 Forward current vs. forward voltage.

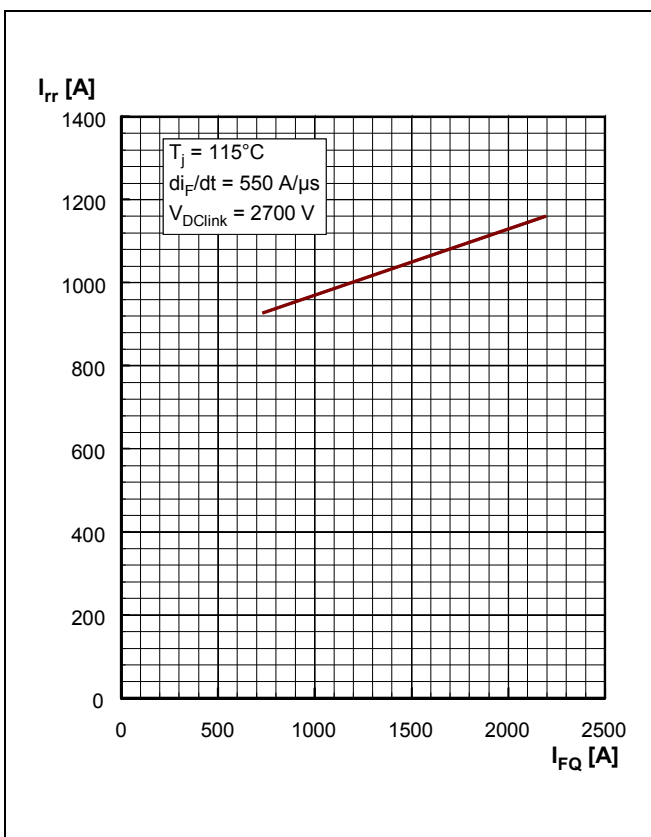

Fig. 3 Diode reverse recovery current vs. turn-off current.

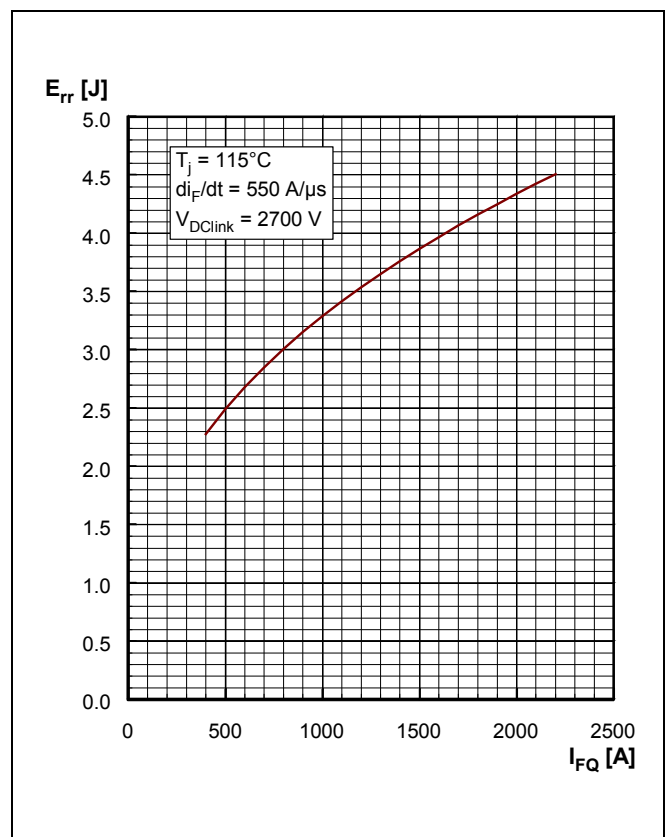

Fig. 4 Diode turn-off energy per pulse vs. turn-off current.

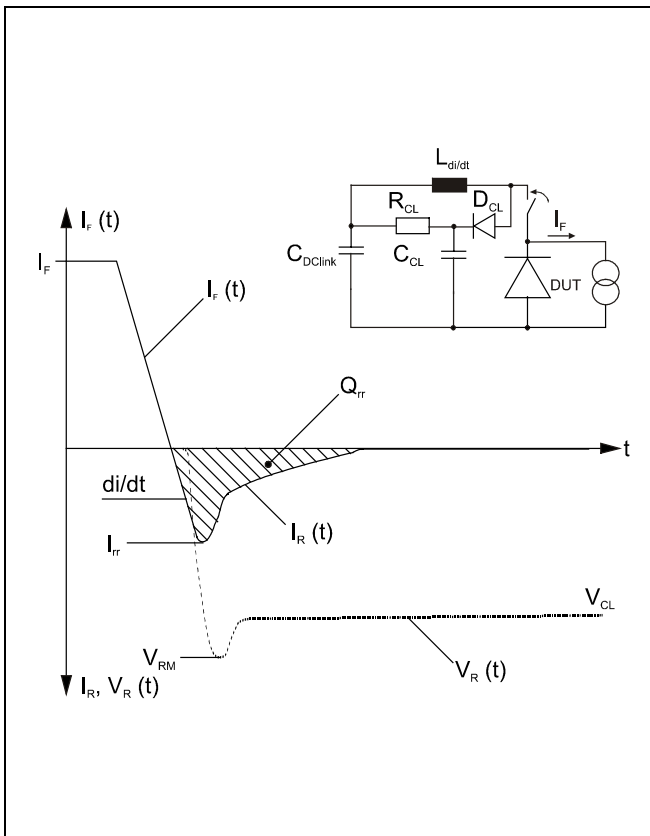

Fig. 5 Typical current and voltage waveforms at turn-off in a circuit with voltage clamp.

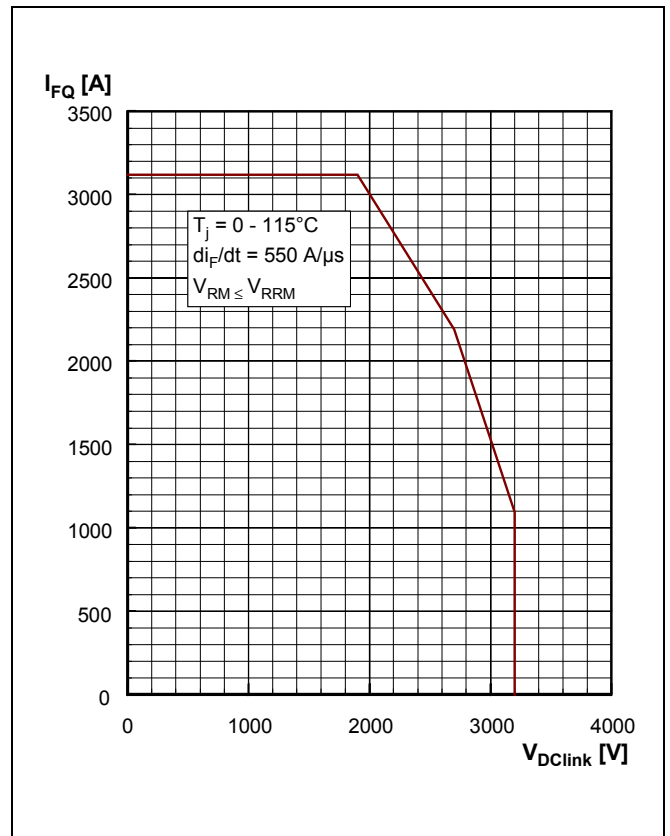

Fig. 6 Max. repetitive diode forward current.

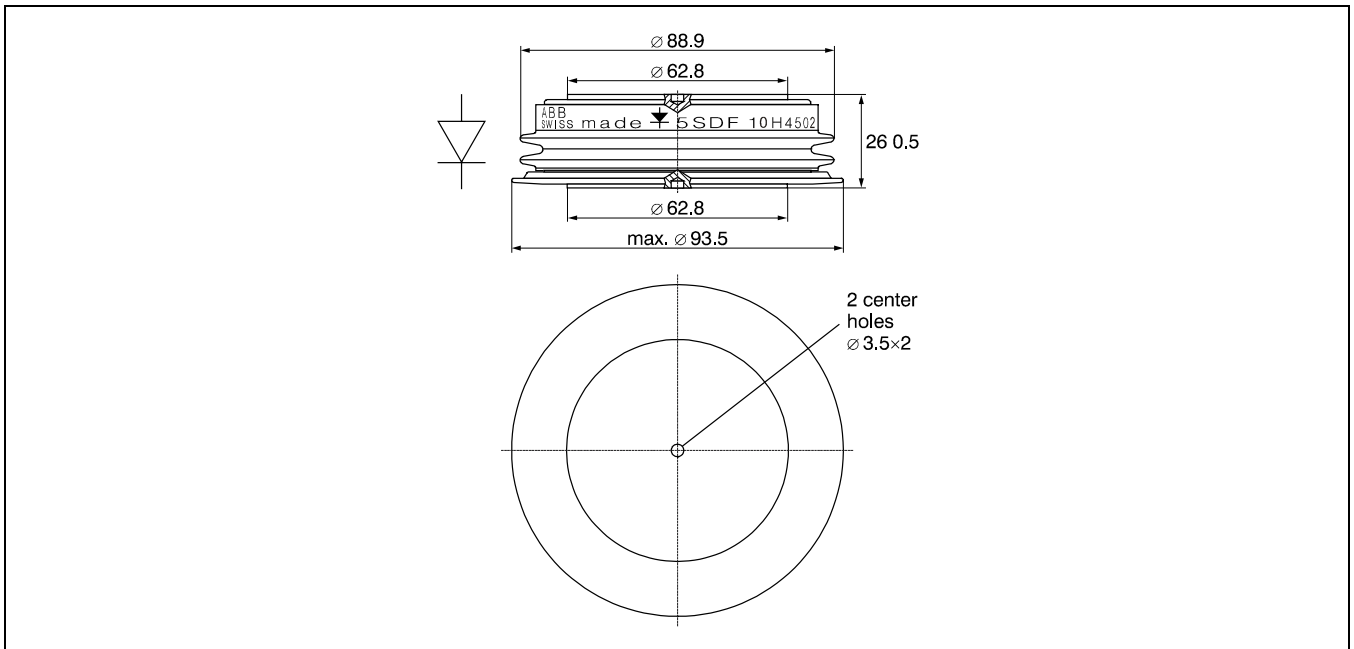

Fig. 7 Outline drawing. All dimensions are in millimeters and represent nominal values unless stated otherwise.

ABB Semiconductors AG reserves the right to change specifications without notice.

ABB

ABB Semiconductors AG
 Fabrikstrasse 3
 CH-5600 Lenzburg, Switzerland

Doc. No. 5SYA1115-03 Sep. 01

Telephone +41 (0)62 888 6419
 Fax +41 (0)62 888 6306
 Email abbsem@ch.abb.com
 Internet www.abbsem.com