

サイリスタ・モジュール

東 芝

MSG60()41

- 電力制御用
- 絶縁耐圧 MSG60G41~MSG60L41 2000V
MSG60N41~MSG60U41 2500V

■外形図

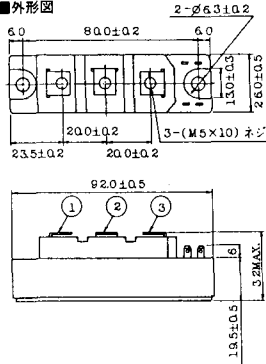

■接続図

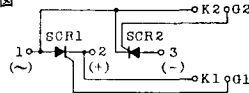

■最大定格

記号	G	J	L	N	Q	S	U		単位
V_{RSM}	500	720	960	1200	1440	1600	1750		V
V_{RRM}	400	600	800	1000	1200	1400	1600		V
V_{DRM}	400	600	800	1000	1200	1400	1600		V
$I_{T(AV)}$	30 (单相半波, $T_r=84^\circ\text{C}$)								
$I_{T(RMS)}$	47								
I_{TSM}	600/660:50Hz:60Hz, 正弦半波1サイクル波高値)								
$I^2 \cdot t$	1800								
di/dt	100 ($V_D = \frac{1}{2} V_{DRM}$)								
P_{GM}	5								
$P_{GM(AV)}$	0.5								
V_{GDM}	5								
I_{GFM}	2								
T_j	-40 ~ +125								
T_{stg}	-40 ~ +125								

■電気的特性

記号	測定条件	最小	標準	最大	単位
I_{RRM}	$T_j = 125^\circ\text{C}, V_D = V_{RRM}$			6	mA
I_{DRM}	$T_j = 125^\circ\text{C}, V_D = V_{DRM}$			6	mA
V_{TM}	$T_a = 25^\circ\text{C}, I_{TM} = 100\text{A}$			1.5	V
V_{GT}	$T_a = 25^\circ\text{C}, V_D = 6\text{V}$			1.5	V
I_{GT}	$R_L = 10\Omega$			80	mA
V_{GD}	$T_r = 125^\circ\text{C}, V_D = \frac{1}{2} V_{DRM}$	0.25			V
I_{GD}					mA
dv/dt	$T_r = 125^\circ\text{C}, V_D = \frac{1}{2} V_{DRM}$	500			V/ μs
I_H	$T_a = 25^\circ\text{C}, R_L = 100\Omega$			150	mA
R_{th}	接合部-ケース間			0.8	$^\circ\text{C}/\text{W}$

MSG100()41

- 電力制御用
- 絶縁耐圧 MSG100G41~MSG100L41 2000V
MSG100N41~MSG100U41 2500V

■外形図

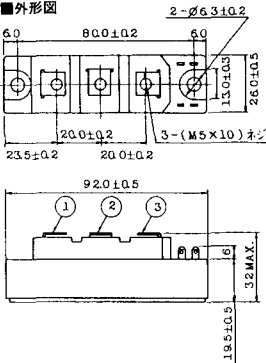

■接続図

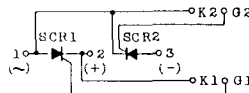

■最大定格

記号	G	J	L	N	Q	S	U		単位
V_{RSM}	500	720	960	1200	1440	1600	1750		V
V_{RRM}	400	600	800	1000	1200	1400	1600		V
V_{DRM}	400	600	800	1000	1200	1400	1600		V
$I_{T(AV)}$	50 (单相半波, $T_r=86^\circ\text{C}$)								
$I_{T(RMS)}$	79								
I_{TSM}	1000/1100 (50Hz:60Hz, 正弦半波1サイクル波高値)								
$I^2 \cdot t$	5000								
di/dt	100 ($V_D = \frac{1}{2} V_{DRM}$)								
P_{GM}	5								
$P_{GM(AV)}$	0.5								
V_{GDM}	5								
I_{GFM}	2								
T_j	-40 ~ +125								
T_{stg}	-40 ~ +125								

■電気的特性

記号	測定条件	最小	標準	最大	単位
I_{RRM}	$T_j = 125^\circ\text{C}, V_D = V_{RRM}$			10	mA
I_{DRM}	$T_j = 125^\circ\text{C}, V_D = V_{DRM}$			10	mA
V_{TM}	$T_a = 25^\circ\text{C}, I_{TM} = 150\text{A}$			1.5	V
V_{GT}	$T_a = 25^\circ\text{C}, V_D = 6\text{V}$			1.5	V
I_{GT}	$R_L = 10\Omega$			80	mA
V_{GD}	$T_r = 125^\circ\text{C}, V_D = \frac{1}{2} V_{DRM}$	0.25			V
I_{GD}					mA
dv/dt	$T_r = 125^\circ\text{C}, V_D = \frac{1}{2} V_{DRM}$	500			V/ μs
I_H	$T_a = 25^\circ\text{C}, R_L = 100\Omega$			150	mA
R_{th}	接合部-ケース間			0.5	$^\circ\text{C}/\text{W}$

FD-1



FD-2

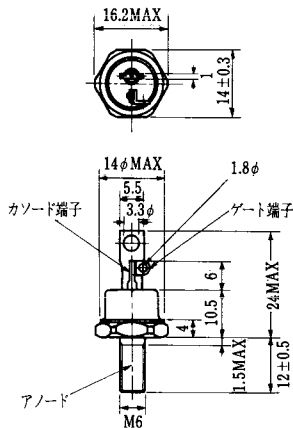

FD-3

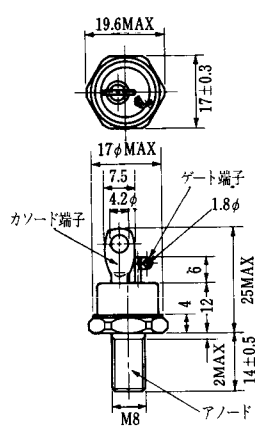

FD-4

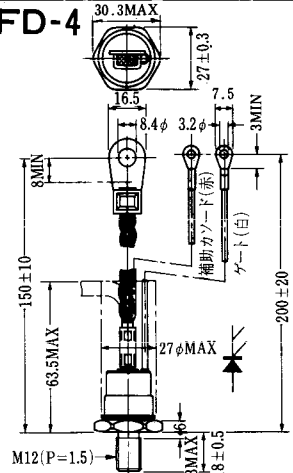

FD-5



FD-6



FD-7

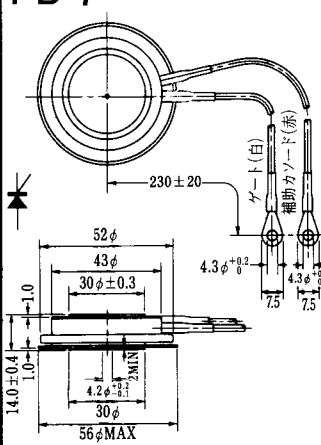

FD-8

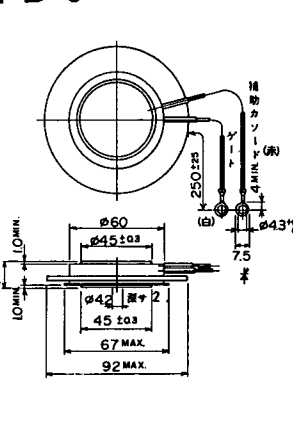

FD-9



FD-10



FD-12



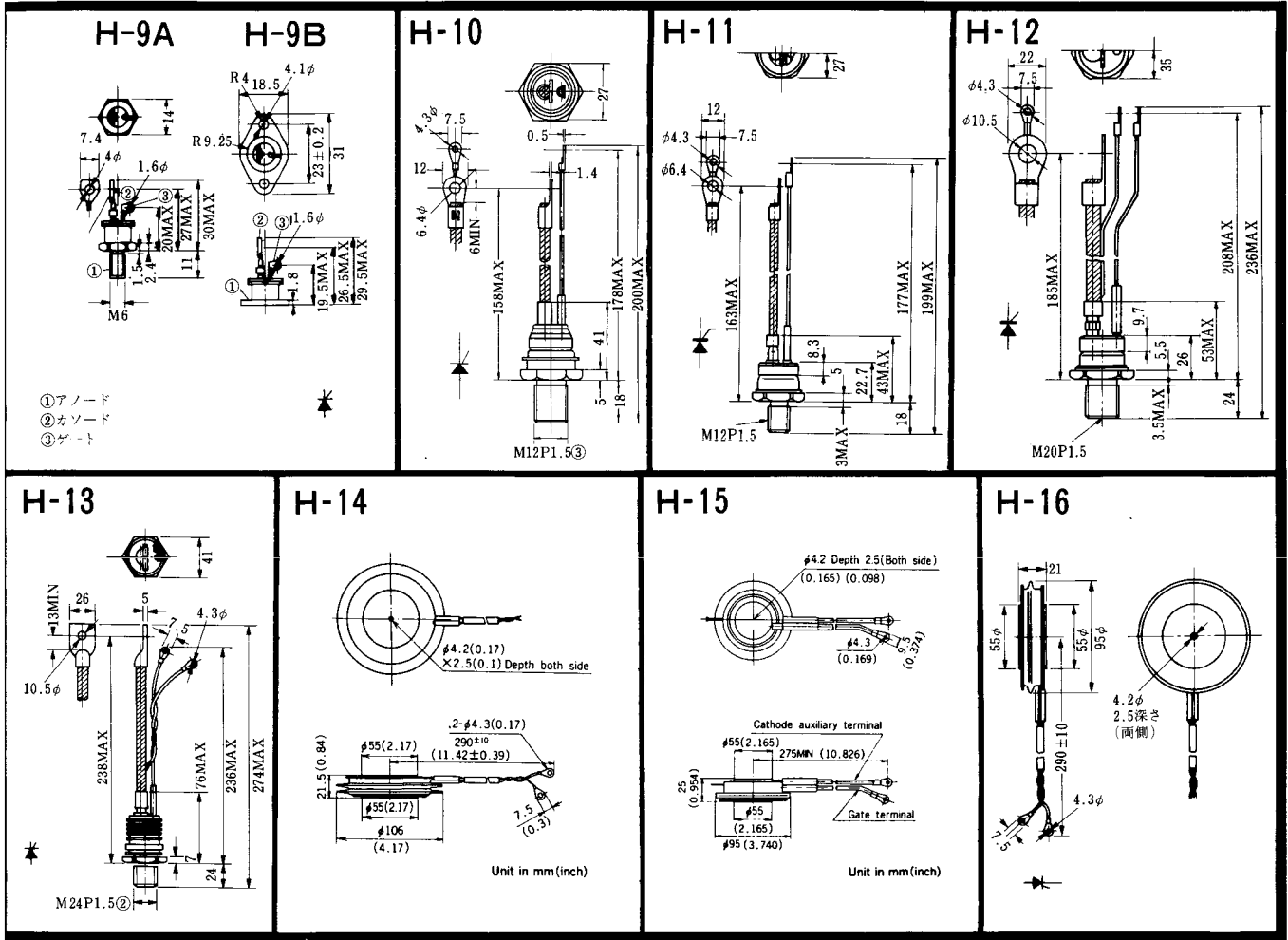

H-17

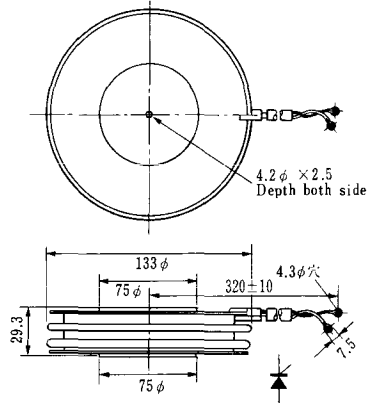

H-18

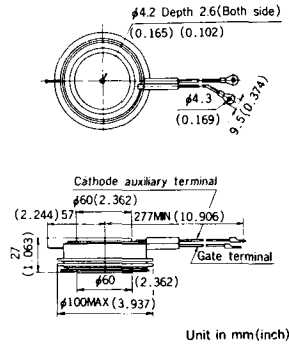

H-19

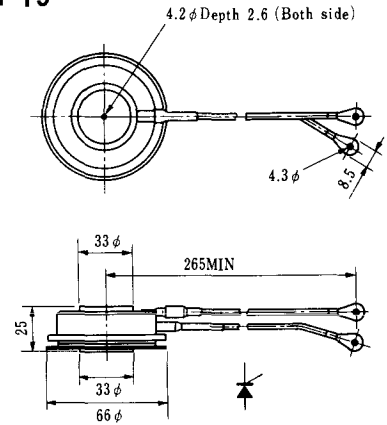

H-20

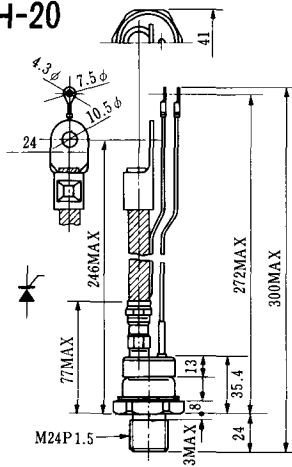

H-21

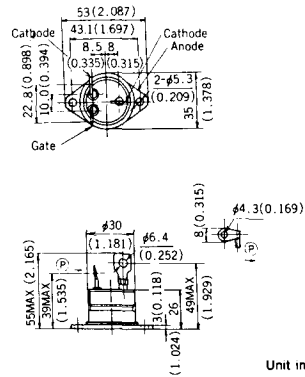

H-22

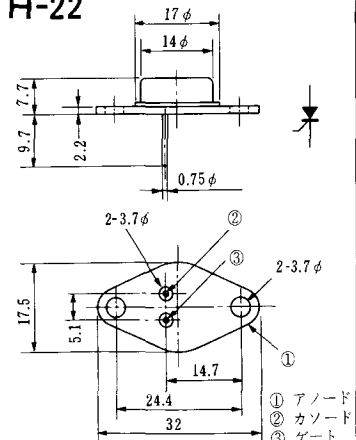

- ① アノード
- ② カソード
- ③ ゲート

H-23



H-24

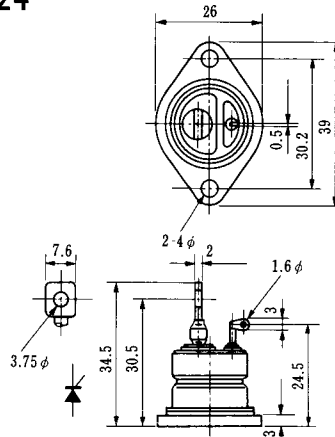

H-25

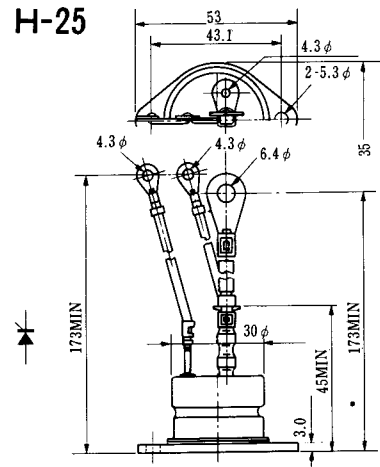

H-26

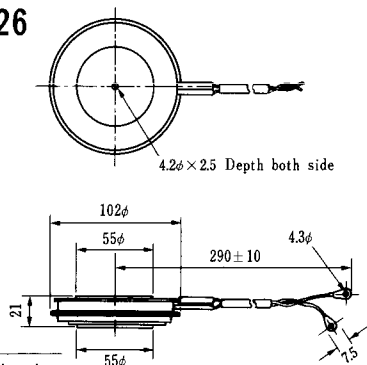

Type	Direction of polarity
------	-----------------------

CA12	
------	--

H-27

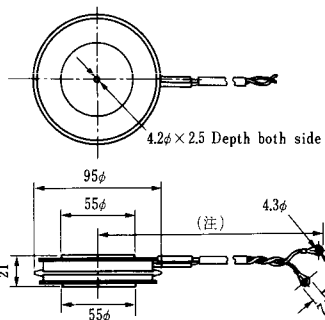

Type	Direction of polarity
------	-----------------------

CF11V	
-------	--

(注) CC11V : 400 ± 10
CF11V : 250 ± 10

H-28

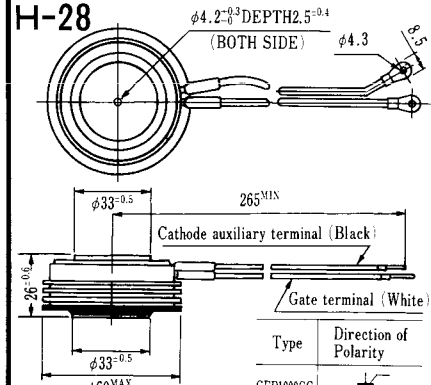

Type	Direction of Polarity
------	-----------------------

GFP100GG	
----------	--

Weight: 360(g)

Note: The thickness is a dimension in press at the rated mounting force.



Note : The thickness is a dimension in press at the rated mounting force. Weight: 870(g)



Note : The thickness is a dimension in press at the rated mounting force. Weight: 1,460(g)

HT-1

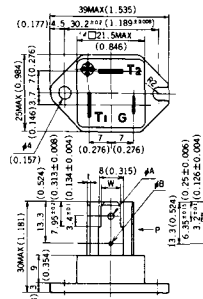

TERMINAL	t	W	φA	φB
T ₁	0.8 ± 0.025 (0.031 ± 0.001)	6.35 ± 0.1 (0.250 ± 0.004)	2.00 ± 0.1 (0.079 ± 0.004)	1.3 (0.051)
T ₂	0.8 ± 0.025 (0.031 ± 0.001)	6.35 ± 0.1 (0.250 ± 0.004)	2.00 ± 0.1 (0.079 ± 0.004)	1.3 (0.051)
G	0.5 ± 0.025 (0.020 ± 0.001)	4.75 ± 0.1 (0.187 ± 0.004)	1.55 ± 0.1 (0.061 ± 0.004)	1.3 (0.051)

Unit in mm(.inch)

HT-2

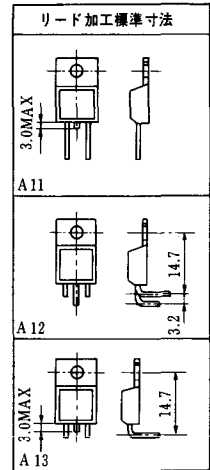
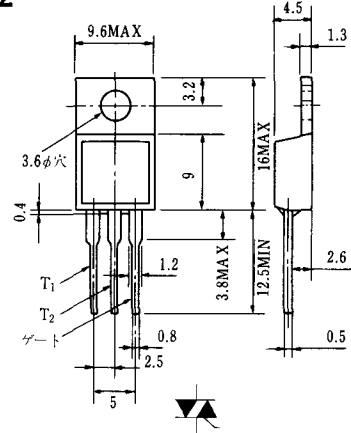

HT-3

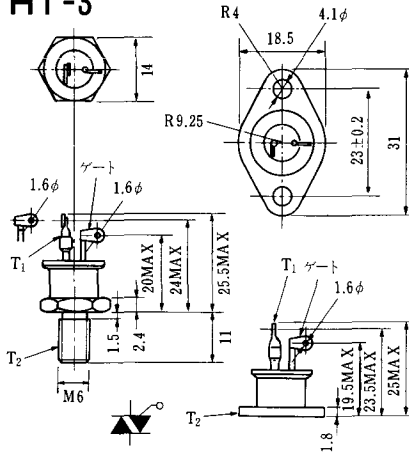

HT-4

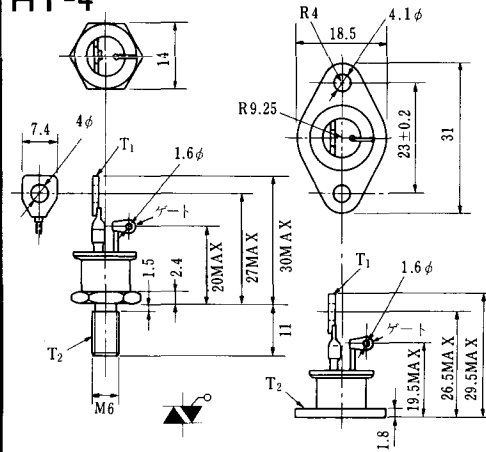

HT-5

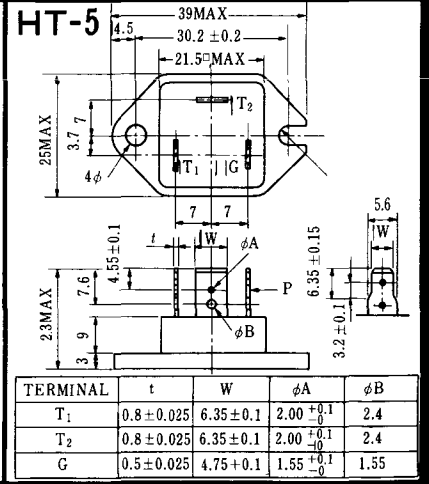

TERMINAL	t	W	φA	φB
T ₁	0.8 ± 0.025	6.35 ± 0.1	2.00 +0.1 -0	2.4
T ₂	0.8 ± 0.025	6.35 ± 0.1	2.00 +0.1 -0	2.4
G	0.5 ± 0.025	4.75 ± 0.1	1.55 +0.1 -0	1.55

〈寸法図単位：mm〉

M-1



M-2



M-3



M-4



M-5

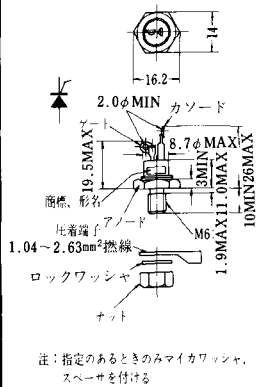

M-6



M-7



M-8



M-9



M-10

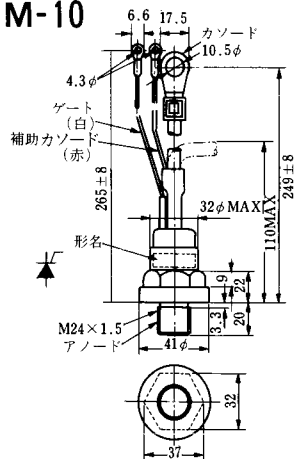

M-11



M-12



M-13



M-14



M-15

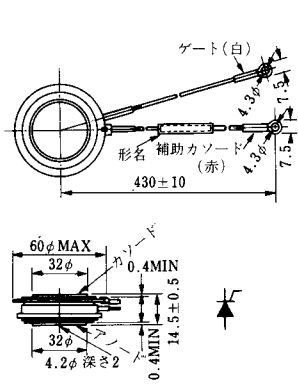

M-16





M-25



M-26



M-27

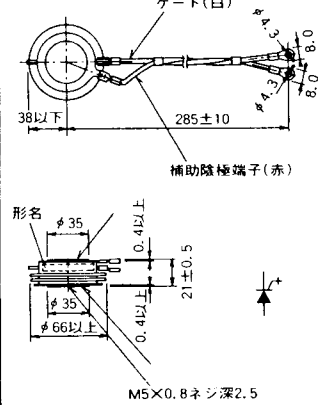

M-28



M-29

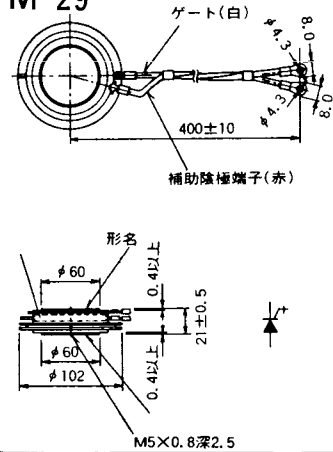

M-30

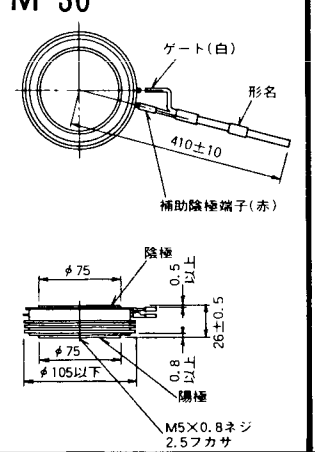

M-31

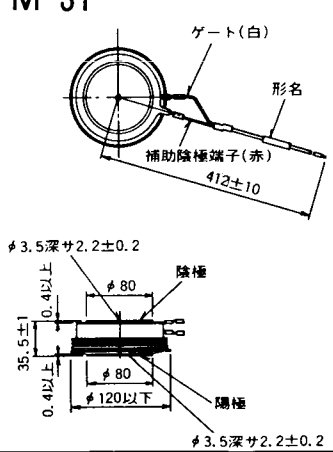

M-32

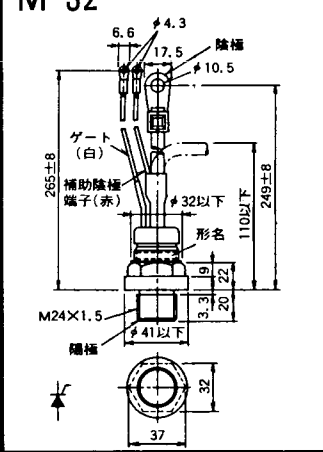

M-33



M-34



MT-1



MT-2



MT-3

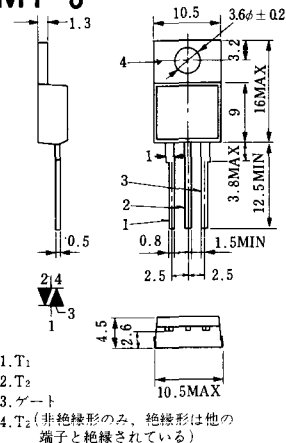

MT-4



MT-5



MT-6

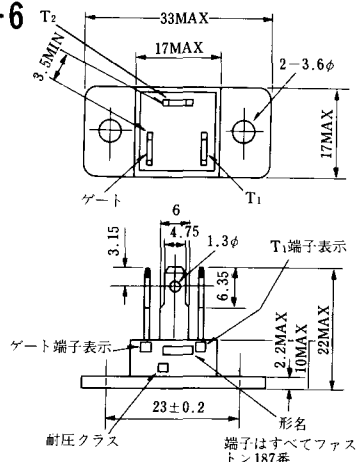

MT-7

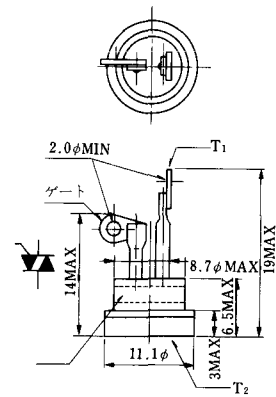

MT-8



MT-9

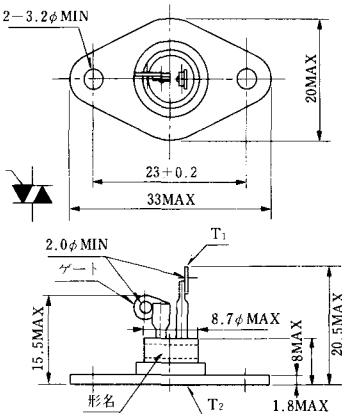

MT-10

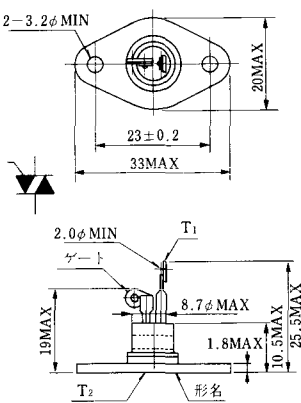

MT-11

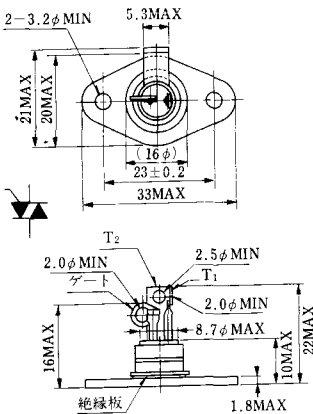

MT-12

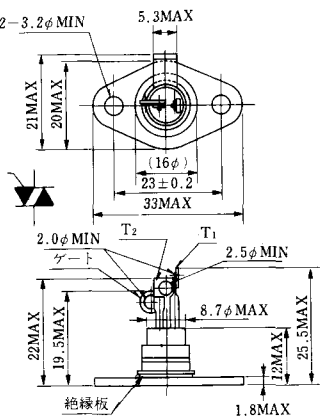

MT-13

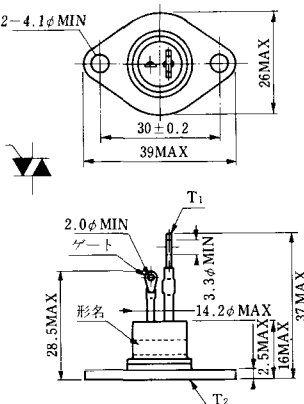

MT-14

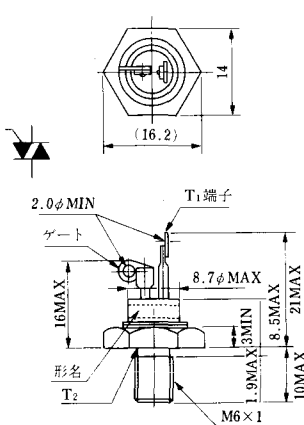

MT-15

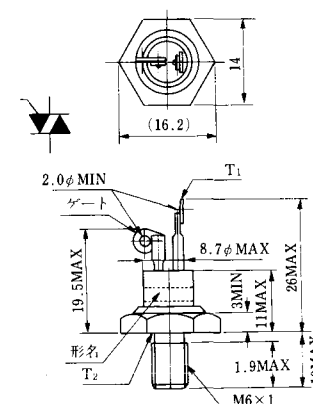

MT-16



MT-17

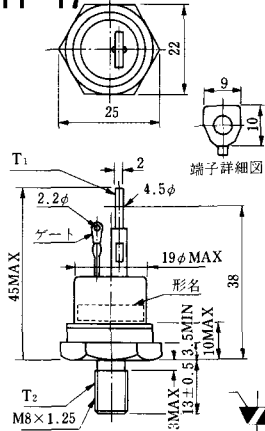

MT-18

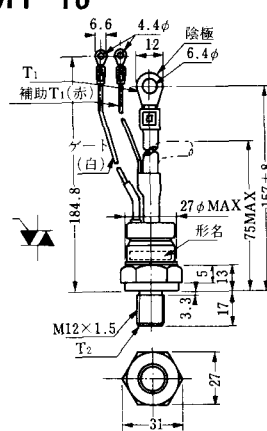

MT-19

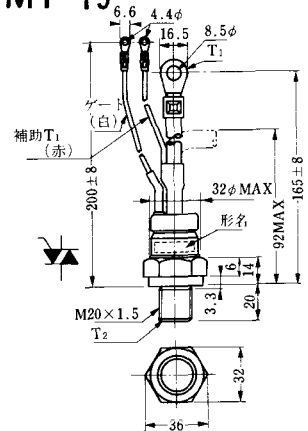

MT-20

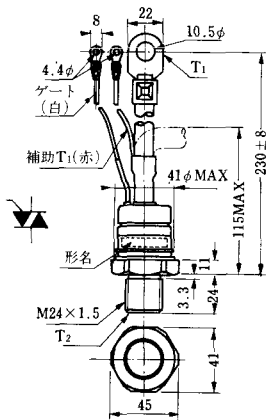

MT-21

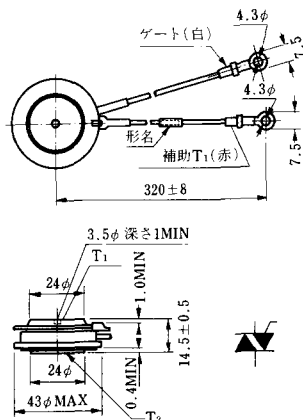

MT-22

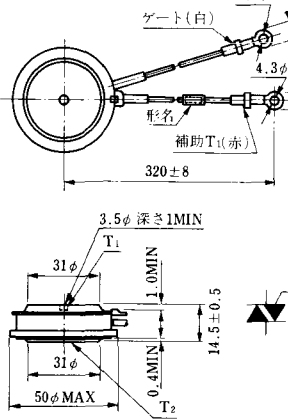

MT-23

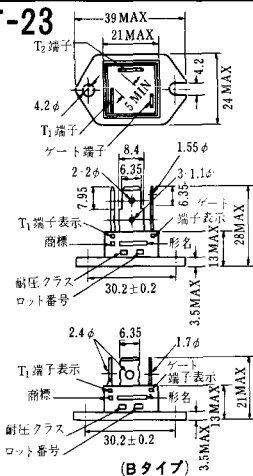

MT-24

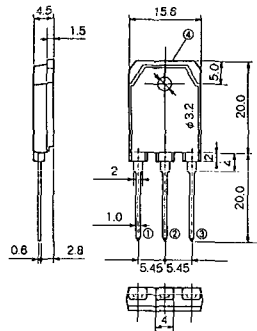

- ① T1 端子
 - ② T2 端子
 - ③ ゲート端子
 - ④ T2 端子
- TO - 3P

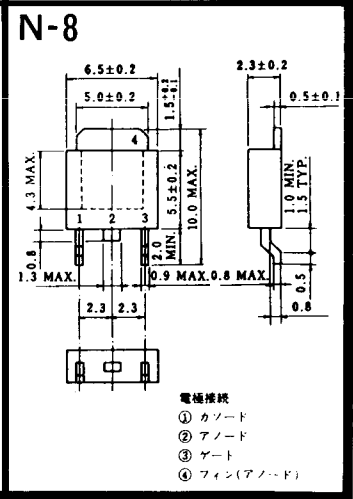
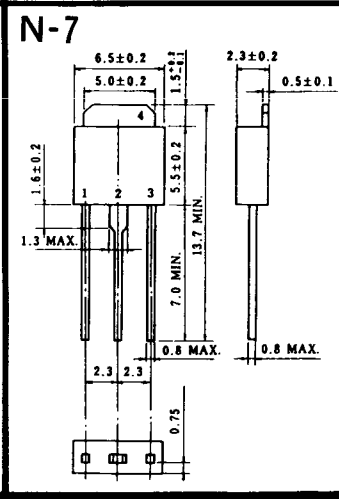
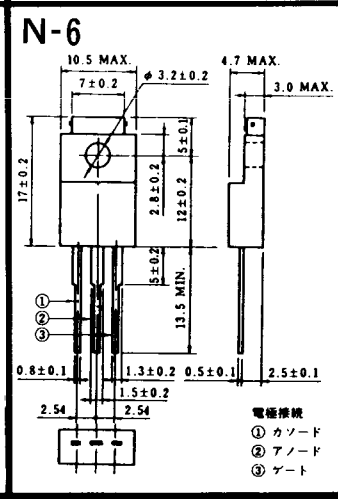
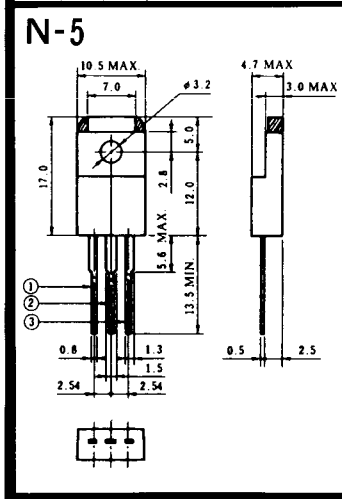
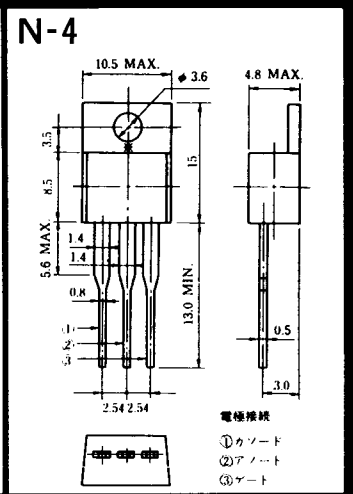
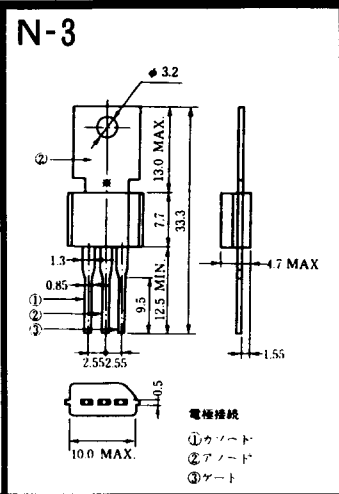
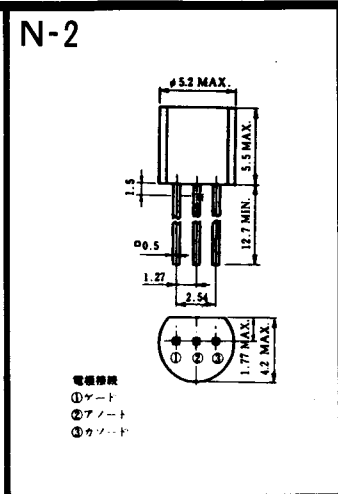
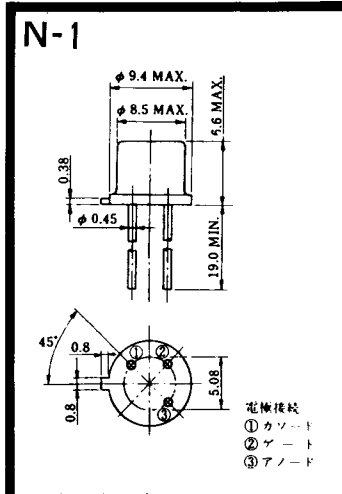

N-9

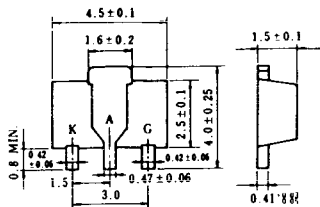

電極標紙

K : カソード

A : アノード

G : グラート

NA-1



電極接続

1. ゲート
2. アノード
3. カソード

JEDEC: TO-92

NA-2

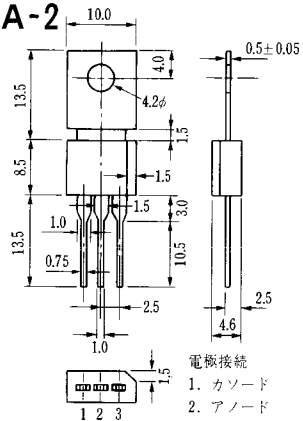

電極接続

1. カソード
2. アノード
3. ゲート

JEDEC: TO-202AA

NI-1

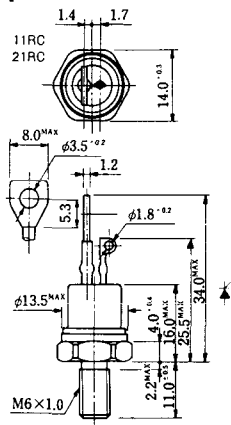

NI-2

29RD

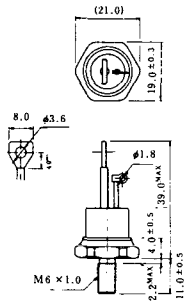

NI-3

39RC
59RC
39RF
59RF

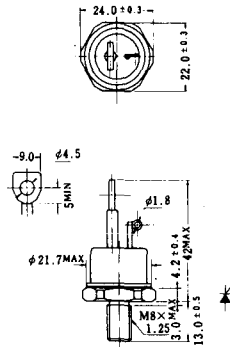

NI-4

68RP, 88RP, 108RP, 68RS,
88RS, 78RT, 88RLD, 88RLE,
88RLF, 88RLF, 88RLH, 108RLE

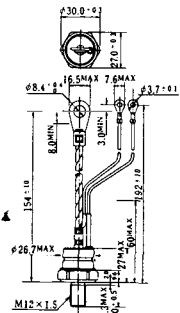

NI-5

158RP, 208RP, 128RS, 178RS,
156RT, 178RLD, 178RLE,
178RLF, 178RLG, 178RLH,
208RLE

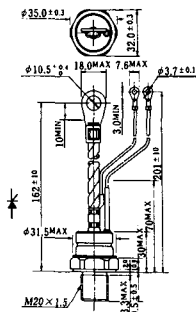

NI-6

308RP, 408RP, 508RP, 278RS,
358RS, 258RT, 258RLD, 258RLG,
258RLH, 308RLE, 308RLF,
358RLE

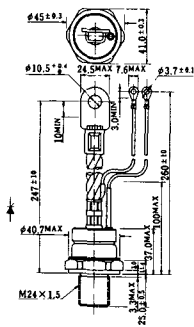

NI-7

89RW_{JL}
129RW_{JL}



NI-8

89RW
129RW

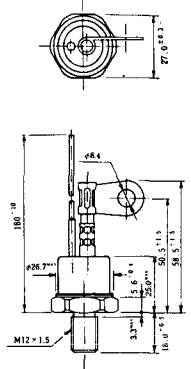

NI-9

259RW
309RW

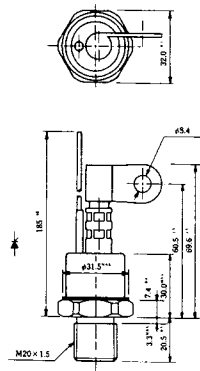

NI-10

259RW_{JL}
309RW_{JL}

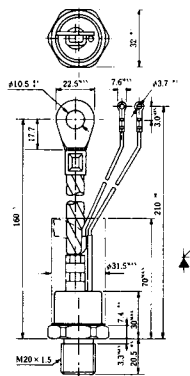

NI-11

103PA
253PA
503PA
553PA
803PA
103PLE
103PLG
103PLH
203PLG
253PLE
253PLH
353PLG
403PLE
403PLH

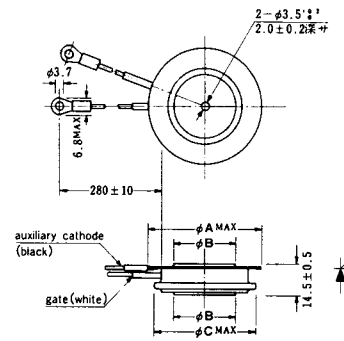

型名	103PA, 103PLE, 103PLG, 103PLH	253PA, 203PLG, 253PLE, 253PLH	503PA, 553PA, 353PLG, 403PLE, 403PLH	803PA
寸法 A	40	46	55.5	55.5
寸法 B	16	22	30	32
寸法 C	36	42	50.5	50.5

NI-12

403PAB
503PAB
503PLB

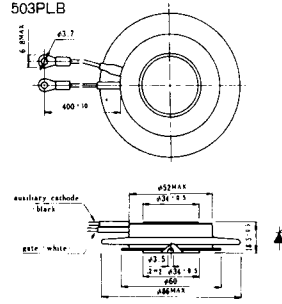

NI-13

1003PA
1003PAB
1003PLF
1003PLH
1503PA

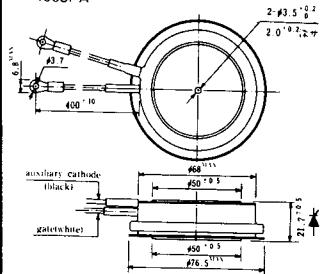

NI-14

358RGA

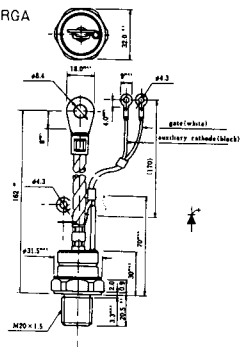

NI-15

359RGA

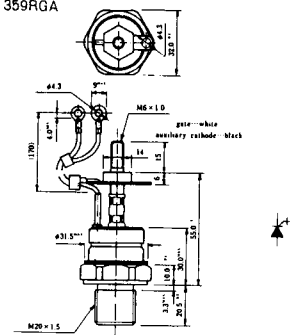



NI-24

2001PGB^r JE



NI-25

NI-26

NT-1

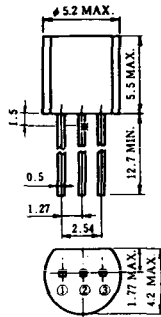

電極接続

- ① T₁
- ② ゲート
- ③ T₂

NT-2

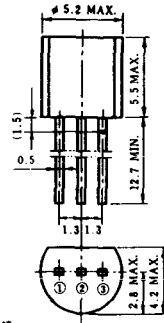

電極接続

- ① T₁
- ② ゲート
- ③ T₂

NT-3

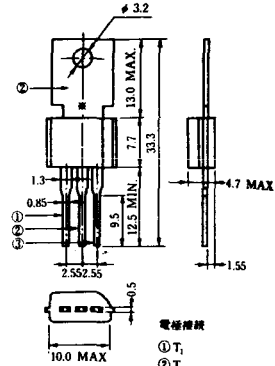

電極接続

- ① T₁
- ② T₂
- ③ ゲート

NT-4

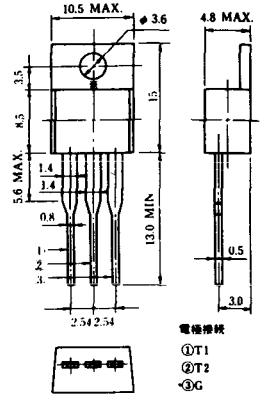

電極接続

- ① T₁
- ② T₂
- ③ G

NT-5

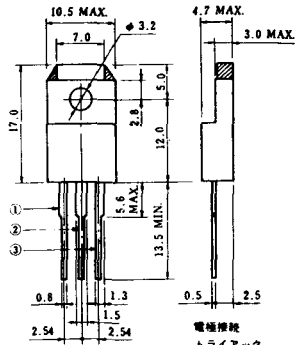

電極接続
トライアック

- ① T₁
- ② T₂
- ③ ゲート

NT-6

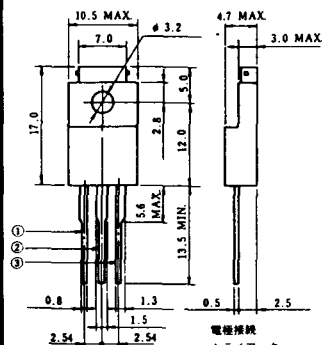

電極接続
トライアック

- ① T₁
- ② T₂
- ③ ゲート

NT-7

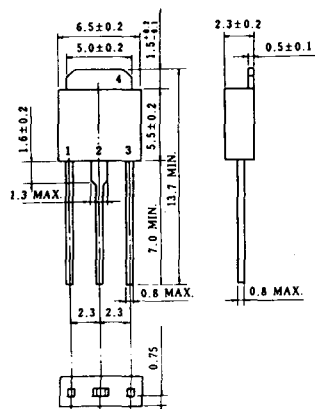

NT-8

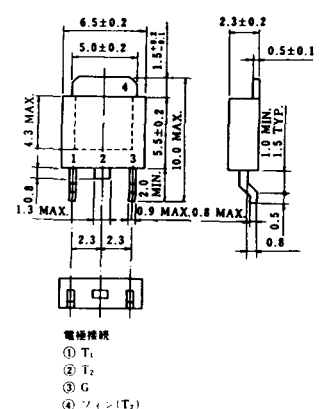

電極接続

- ① T₁
- ② T₂
- ③ G
- ④ シフト(T₂)

S-1

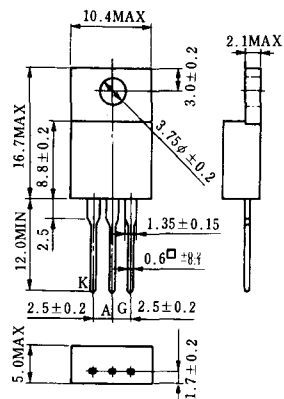

ST-1



SA-1



SA-2

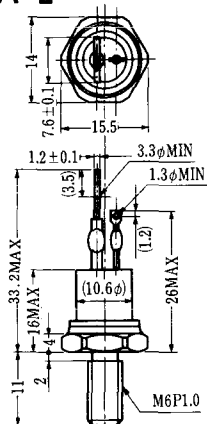

SA-3

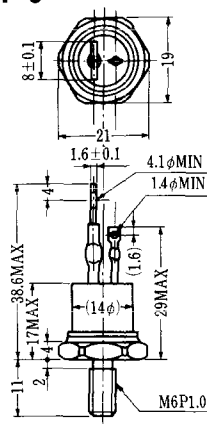

SA-4

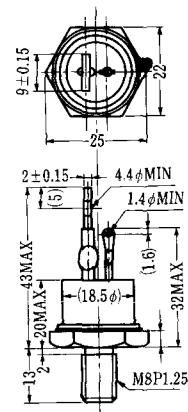

SA-5



SA-6

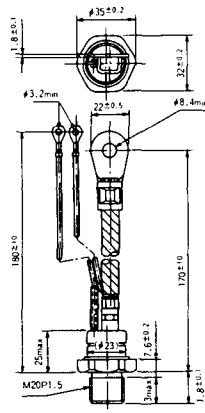

SA-7

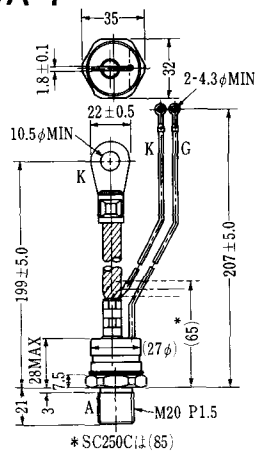

SA-8

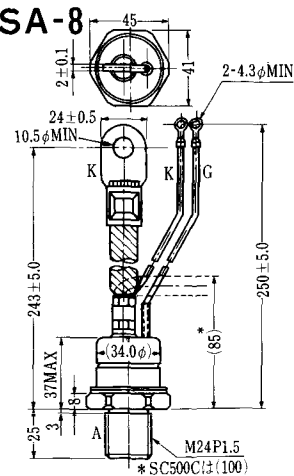

SA-9

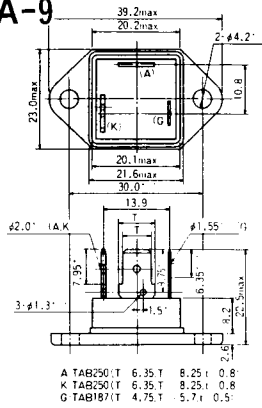

SA-10

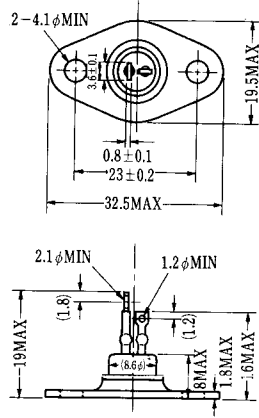

SA-11

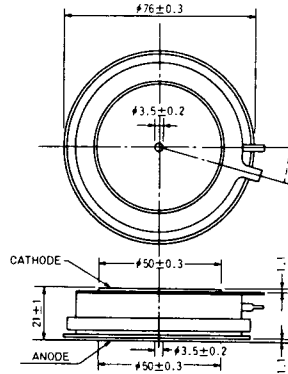

SA-12

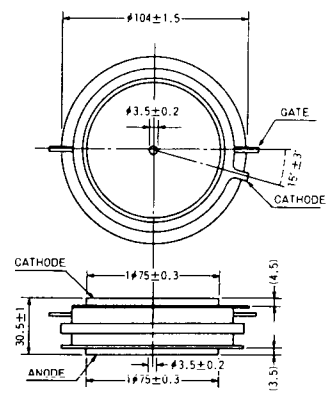

SAT-1

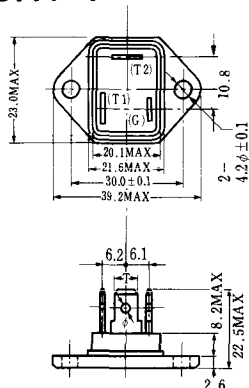

T1 端子: フラスト > 250 (T=6.35, t=0.8, φ=1.65)
 T2 端子: フラスト > 250 (T=6.35, t=0.8, φ=1.65)
 C 端子: フラスト > 187 (T=4.75, t=0.5, φ=1.3)

SAT-2



SAT-3



SAT-4

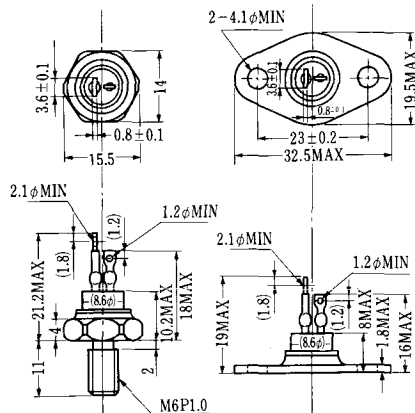

SAT-5



SAT-6



SAT-7



SAT-8



SAT-9



SAT-10



SAT-11

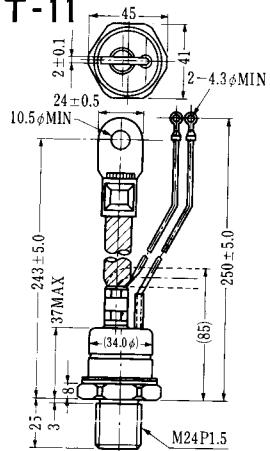

SY-1 (1096A)



C: Cathode
A: Anode
G: Gate

SY-2 (1151)

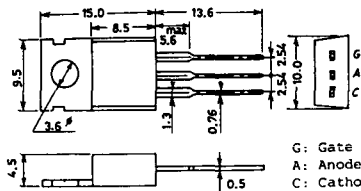

G: Gate
A: Anode
C: Cathode

SY-3 (1104)



G: Gate
A: Anode
C: Cathode

SY-4 (1150)



G: Gate
A: Anode
C: Cathode

1097A

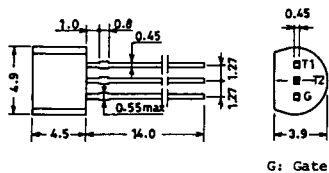

G: Gate

1102



1141



1142



1144

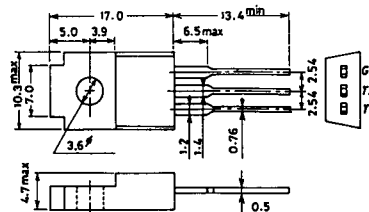

1155

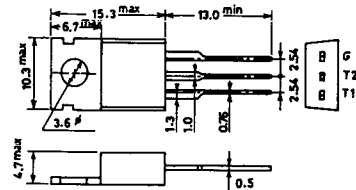

1192A

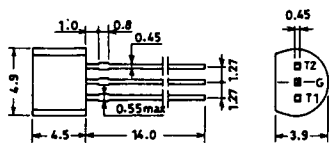

G: Gate

T-1 (13-5A1A)

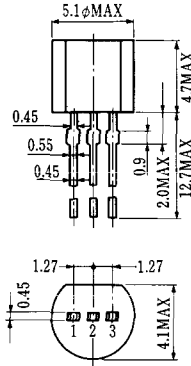

- 1 ゲート
- 2 アノード
- 3 カソード

T-2 (13-8A1A)



1. カソード
2. ゲート
3. アノード(ケース)

T-3 (13-8C1A)

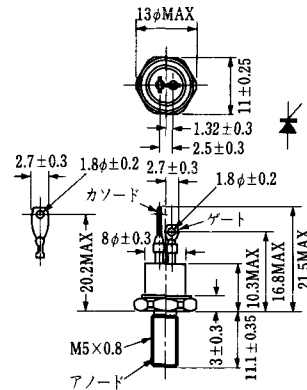

- 1 カソード
- 2 アノード
- 3 ゲート

T-5 (13-10B1A)

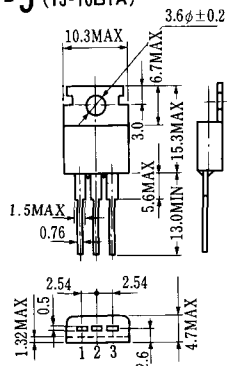

- 1 カソード
- 2 アノード
- 3 ゲート

T-6 (13-11D1A)

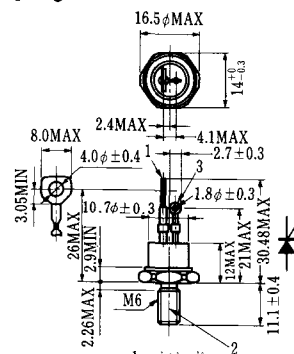

- 1 カソード
- 2 アノード
- 3 ゲート

T-7 (13-13A1A)

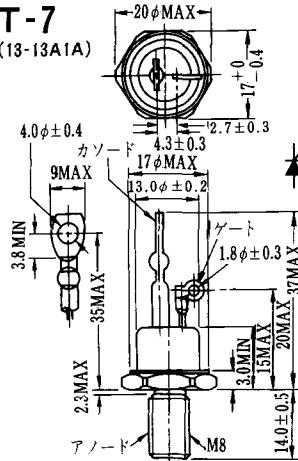

T-8 (13-13B1A)

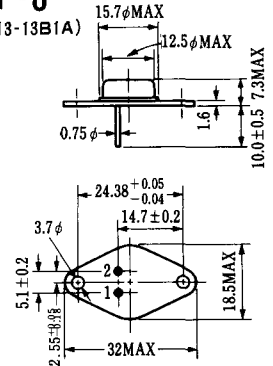

1. ゲート
2. カソード
3. アノード(ケース)

T-9 (13-14A1A)

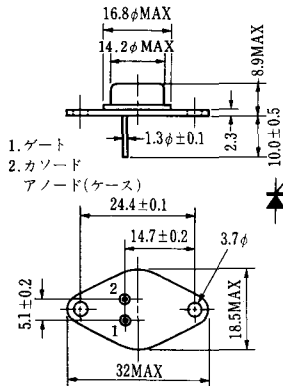

1. ゲート
2. カソード
- アノード(ケース)

T-10 (13-19A1A)



1. カソード
2. アノード
3. ゲート

T-11 (13-21B1A)

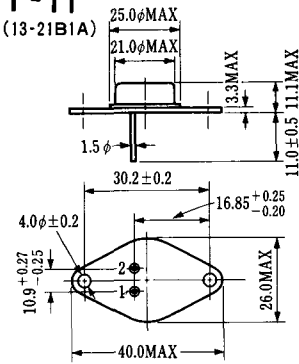

1. ゲート
2. カソード
- アノード(ケース)

T-12 (13-27B1B)

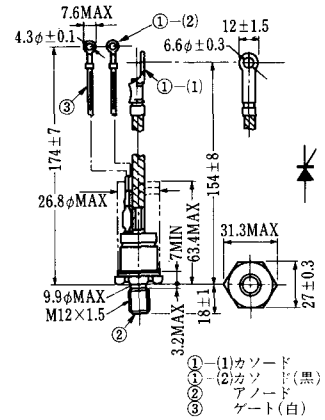

- ① (1) カソード
- ① (2) カソード(黒)
- ② アノード
- ③ ゲート(白)

T-13 (13-27C1A)

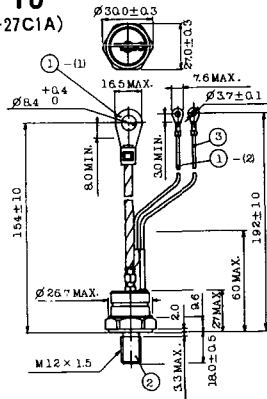

- 1-(1) カソード
- 1-(2) カソード(黒)
- 2 アノード
- 3 ゲート(白)

T-14 (13-32A1A)

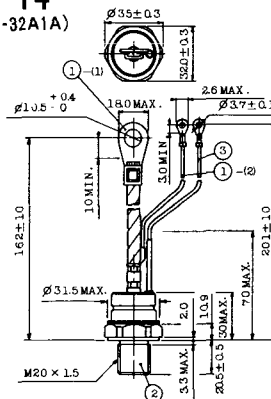

- 1-(1) カソード
- 1-(2) カソード(黒)
- 2 アノード
- 3 ゲート(白)

T-15 (13-35C1B)

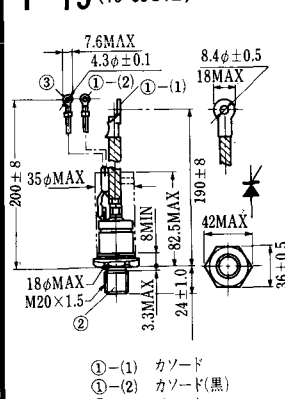

- ① (1) カソード
- ① (2) カソード(黒)
- ② アノード
- ③ ゲート(白)

T-16 (13-40B1A)

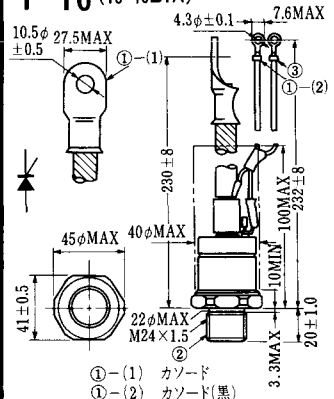

- ① (1) カソード
- ① (2) カソード(黒)
- ② アノード
- ③ ゲート(白)

T-17 (13-42A1A)

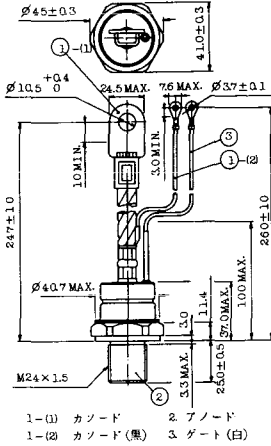

T-18 (13-45D1A)

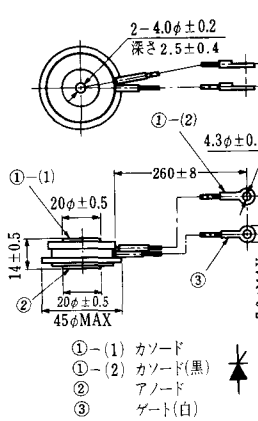

T-19 (13-52B1A)

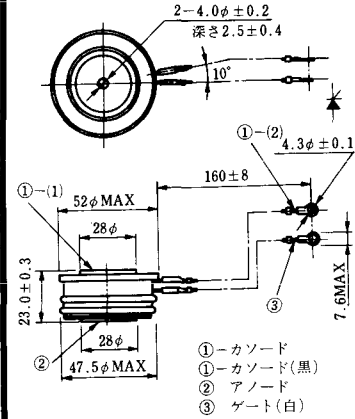

T-20 (13-52C1A)

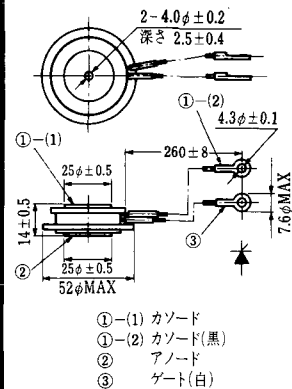

T-21 (13-60A1A)

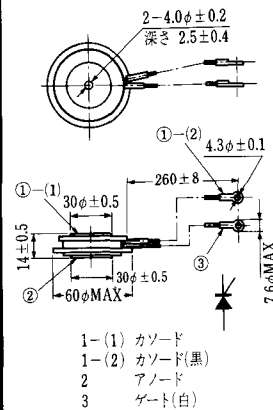

T-22 (13-70C1A)

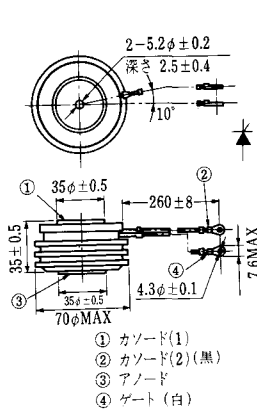

T-23 (13-78A1A)

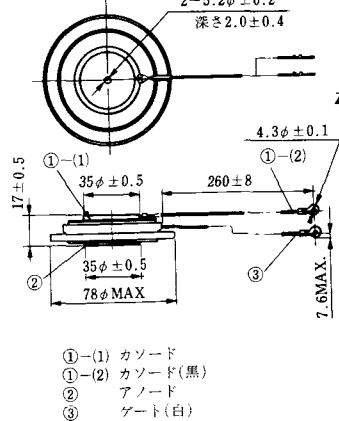

T-24 (13-100C1A)

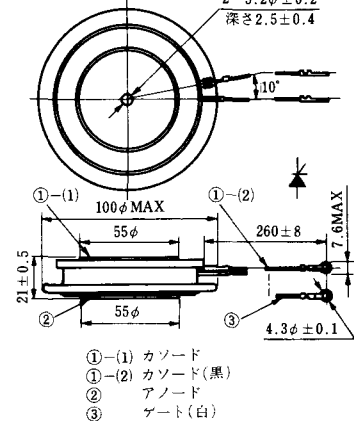

T-25 (13-120A2A)

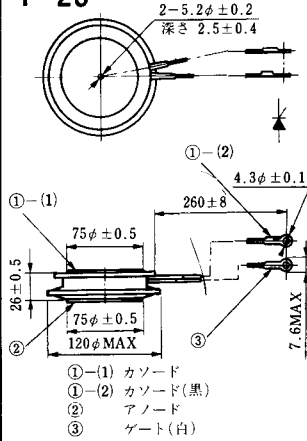

T-26 (13-150A1A)

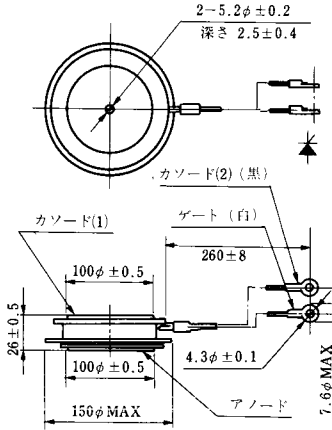

T-27 (13-37A1A)

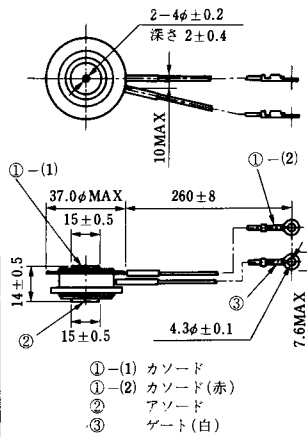

T-28 (13-45E1A)

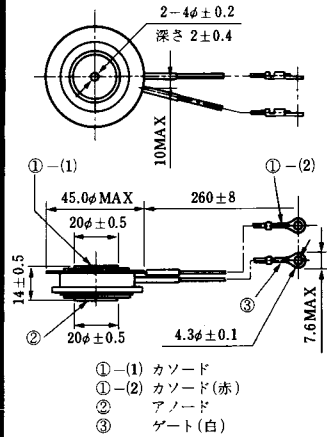

T-29 (13-51A1A)

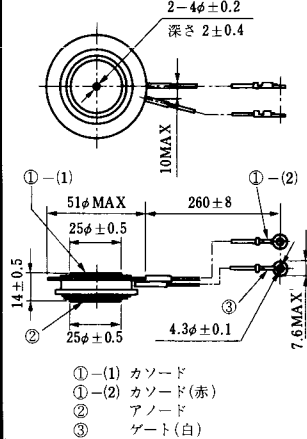

T-30 (13-57A1A)

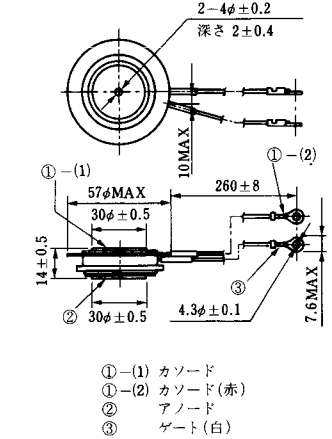

T-31 (13-100E1A)

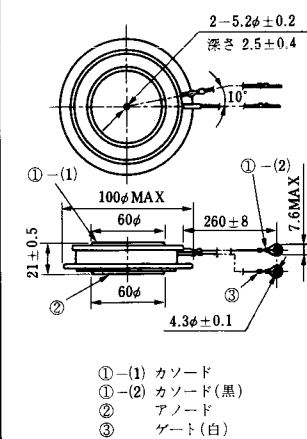

T-32 (13-60E3A)

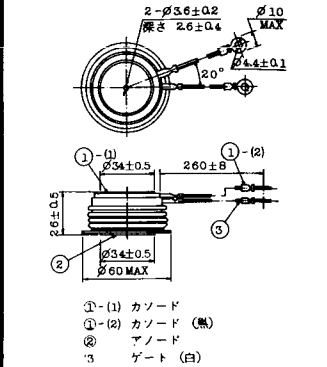

T-33 (13-78B1A)

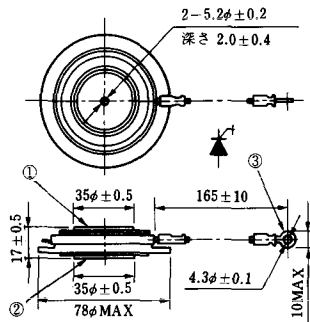

- ① カソード
- ② アノード
- ③ ゲート

T-34 (13-66A1A)

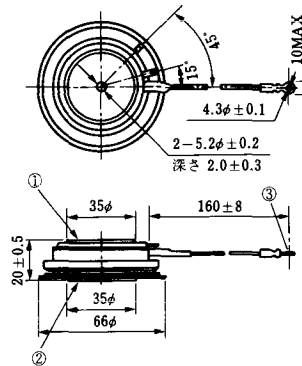

- ① カソード
- ② アノード
- ③ ゲート

T-35 (13-100D1A)

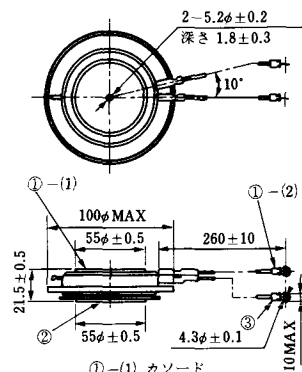

- ①-(1) カソード
- ①-(2) カソード(黒)
- ② アノード
- ③ ゲート(白)

T-36 (13-120E1A)

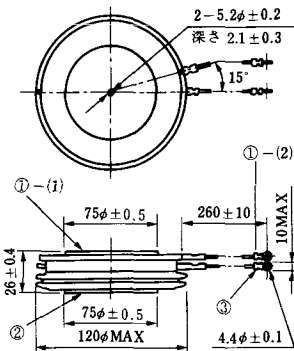

- ①-(1) カソード
- ①-(2) カソード(黒)
- ② アノード
- ③ ゲート(白)

T-37 (13-120A1A)

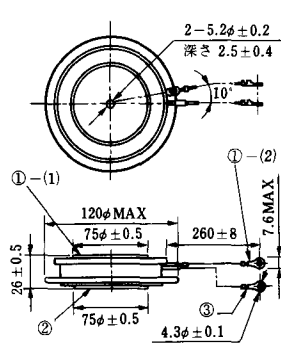

- ①-(1) カソード
- ①-(2) カソード(黒)
- ② アノード
- ③ ゲート(白)

T-38 (13-120C1A)

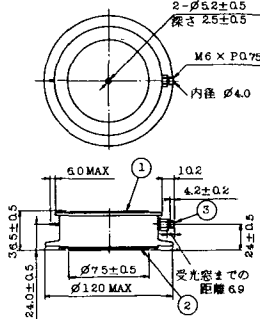

- ① カソード
- ② アノード
- ③ ゲート

T-39 (13-80B1A)

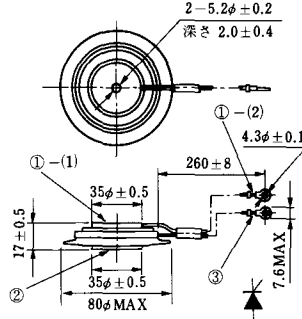

- ①-(1) カソード
- ①-(2) カソード(黒)
- ② アノード
- ③ ゲート(白)

T-40 (13-28A1A)

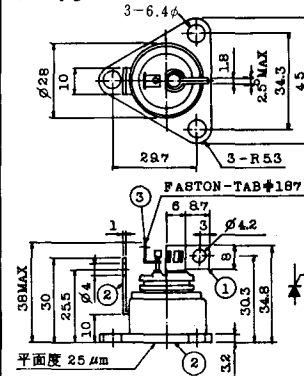

- 1. カソード
- 2. アノード
- 3. ゲート

T-41 (13-28A2A)

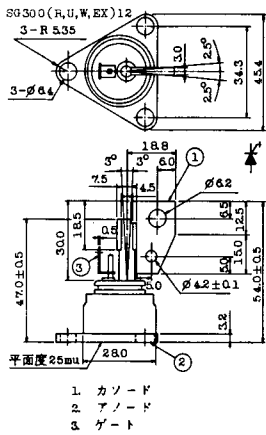

T-42 (13-45F1A)

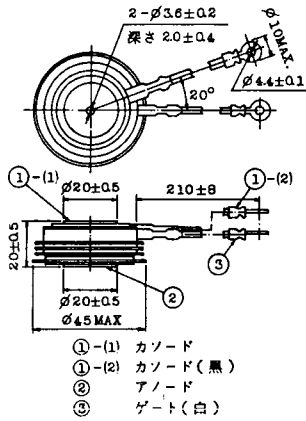

T-43 (13-60E2A)

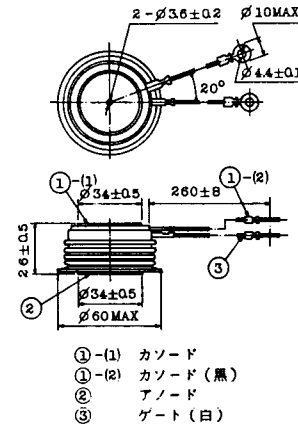

T-44 (13-36A1A)

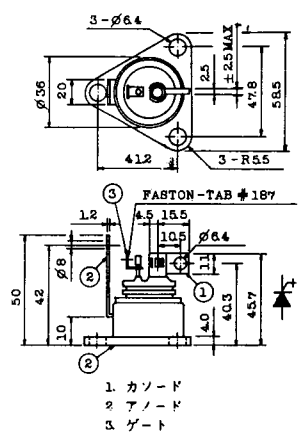

T-45 (13-51B1A)

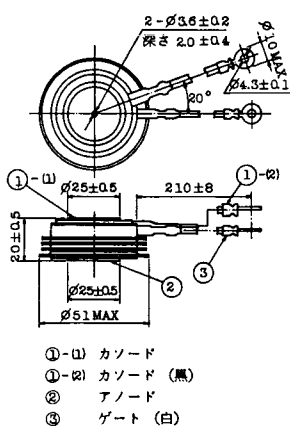

T-46 (13-36B1A)

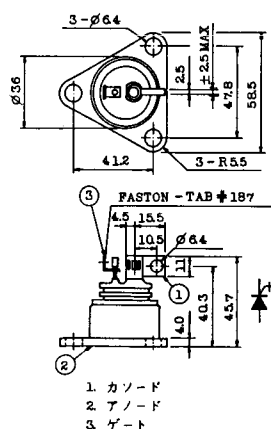

T-47 (13-60E1A)

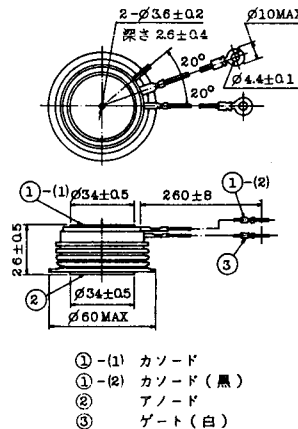

T-48 (13-93C1A)

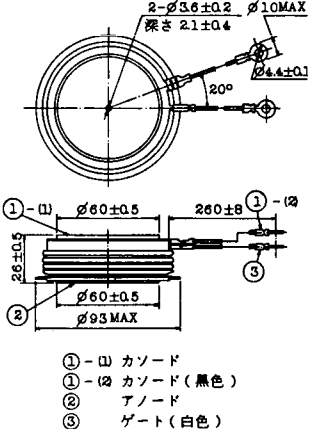

T-49 (13-75A1A)

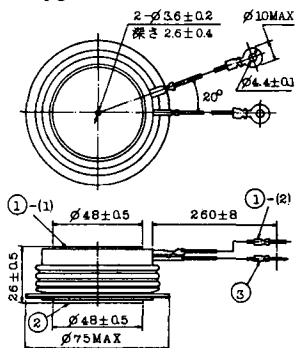

- 1-(1) カソード
- 1-(2) カソード(黒)
- 2 アノード
- 3 ゲート(白)

T-50 (13-10A3A)



- 1 カソード
- 2 アノード
- 3 ゲート

T-51 (13-10D1A)



- 1 カソード
- 2 アノード
- 3 ゲート

T-52 (13-10D2A)

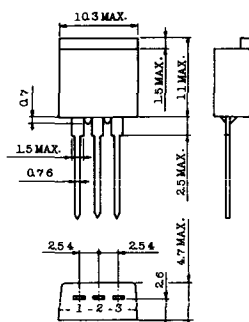

- 1 カソード
- 2 アノード
- 3 ゲート

T-53 (13-10E1B)

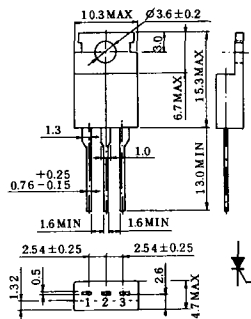

- 1 カソード
- 2 アノード
- 3 ゲート

T-54 (13-10F1B)

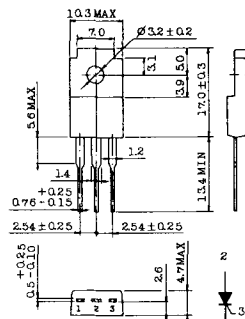

- 1 カソード
- 2 アノード
- 3 ゲート

T-55 (13-5A1D)

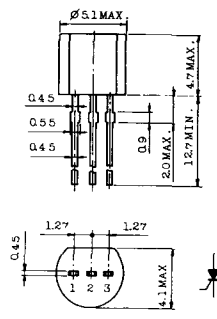

- 1 カソード
- 2 アノード
- 3 アノード

T-56 (13-13C1A)

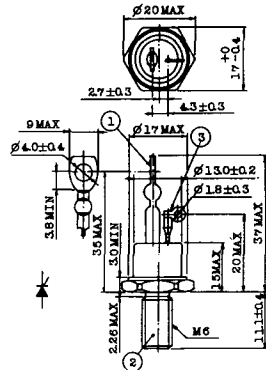

- 1 カソード
- 2 アノード
- 3 ゲート

T-57 (12-16C1A)

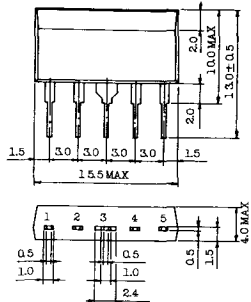

1. アノード (主)
2. ゲート (主)
3. カソード (共通)
4. ゲート (補助)
5. アノード (補助)

T-58 (13-10H1B)



1. カソード
2. アノード
3. ゲート

T-59 (13-120A1A)

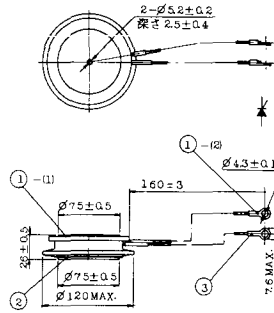

- 1-(1) カソード
- 1-(2) カソード (黒)
2. アノード
3. ゲート (白)

T-60



1. カソード
2. アノード
3. ゲート

T-61 (13-5B1A)

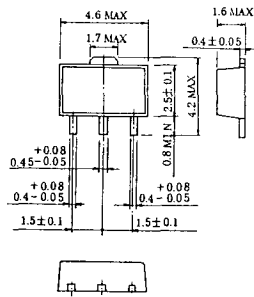

1. ゲート
2. アノード
3. カソード

T-62 (13-10H1A)

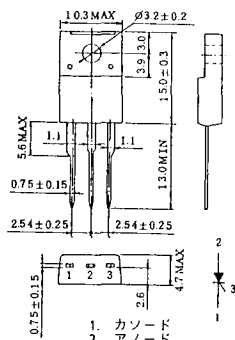

1. カソード
2. アノード
3. ゲート

T-63 (13-16A1B)

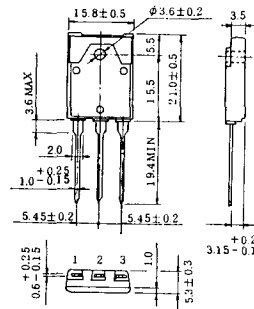

1. カソード
2. アノード
3. ゲート

TT-1

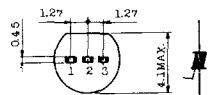

- 1 ゲート
- 2 T₂
- 3 T₁

TT-2

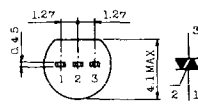
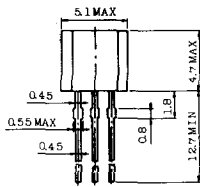

- 1 T₁
- 2 ゲート
- 3 T₂

TT-3

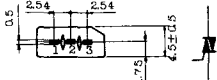
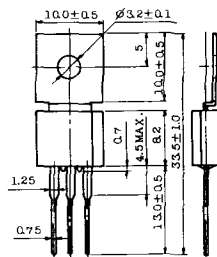

- 1 T₁
- 2 T₂
- 3 ゲート

TT-4

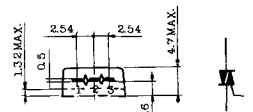

- 1 T₁
- 2 T₂
- 3 ゲート

TT-5

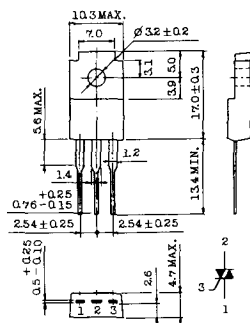

- 1 T₁
- 2 T₂
- 3 ゲート

TT-6

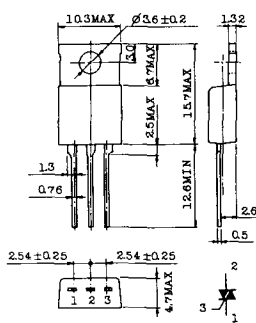

- 1 T₁
- 2 T₂ (放熱板)
- 3 ゲート

TT-7

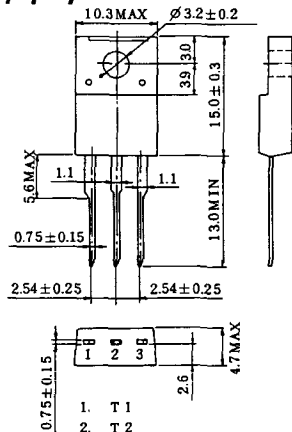

- 1 T₁
- 2 T₂
- 3 ゲート

TT-8

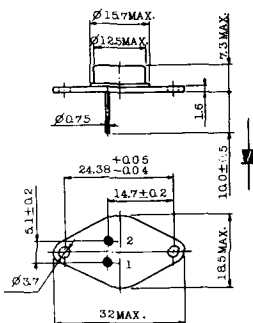

- 1 ゲート
- 2 T₁
- T₂ (ケース)

TT-9

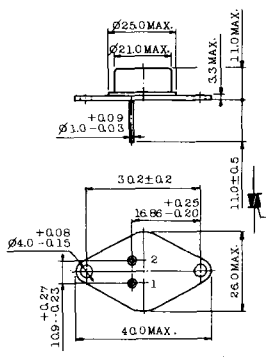

1. ゲート
2. T₁
3. T₂ (ケース)

TT-10

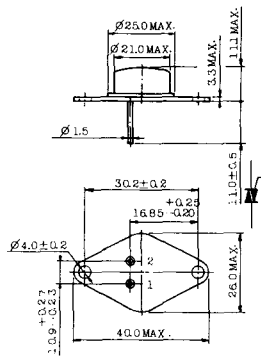

1. ゲート
2. T₁
3. T₂ (ケース)

TT-11

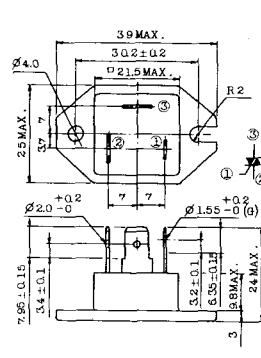

1. ゲート (フタ用端子 #197)
2. T₁ (" #250)
3. T₂ (" #250)

TT-12

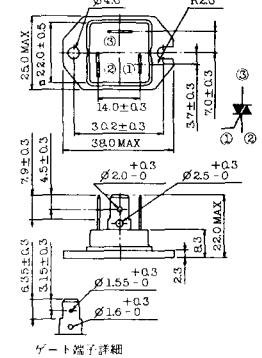

- ゲート端子詳細
- ① ゲート (フタ用端子 #197)
 - ② T₁ (" #250)
 - ③ T₂ (" #250)

TT-13

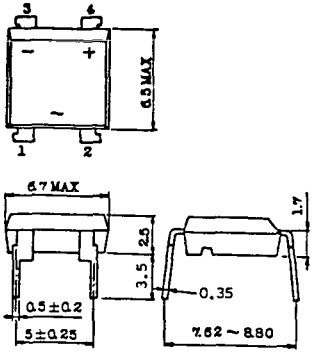

- 1, 2: T₂
- 3: GATE
- 4: T₁

TT-14

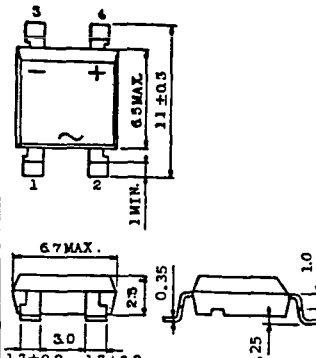

- 1, 2: T₂
- 3: GATE
- 4: T₁

TT-15 (13-14A1B)

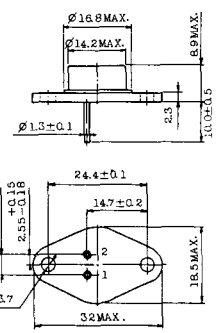

1. ゲート
2. T₁
- T₂ (ケース)

TT-16 (13-16A1A)

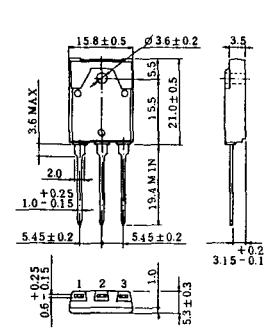

1. T₁
2. T₂
3. ゲート



TS-8

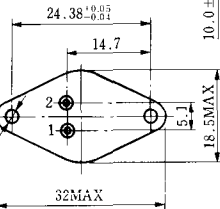
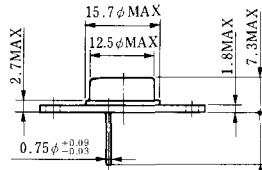

- 1. ベース
- 2. エミッタ
コレクタ
(ケース)

S-62A1A

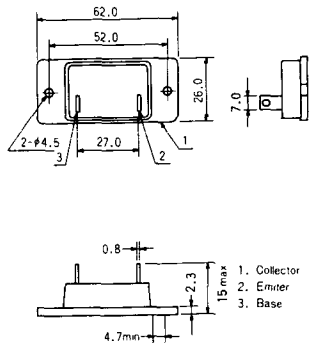

S-80A1A

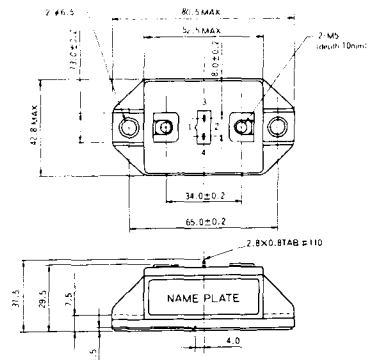

S-88D1A

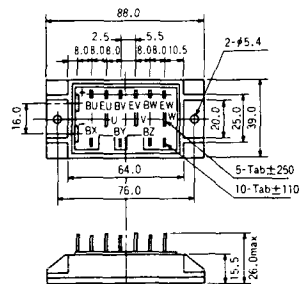

S-92B1A

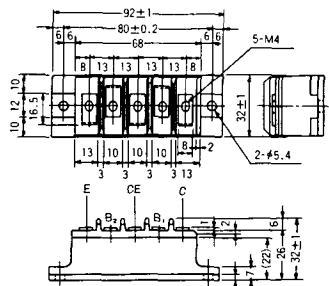

S-94B1A

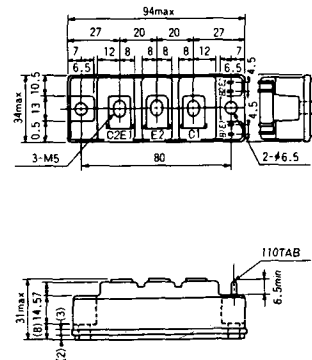

S-94B1B

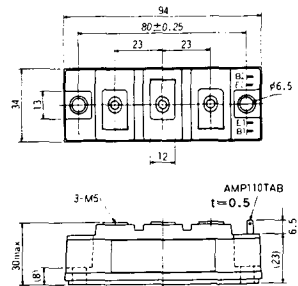

S-94B2A

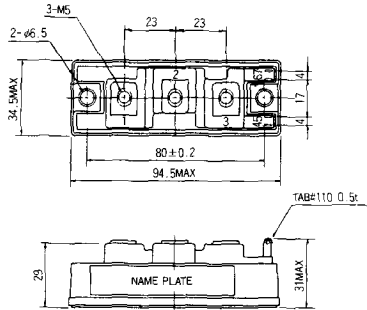

S-94D1A

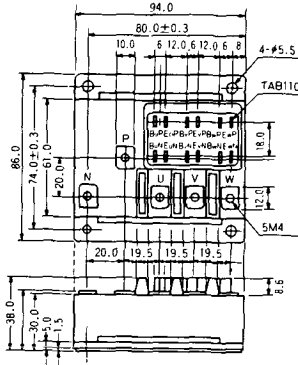

S-95A1A

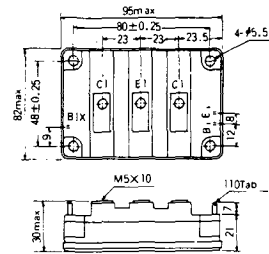

S-95B1A

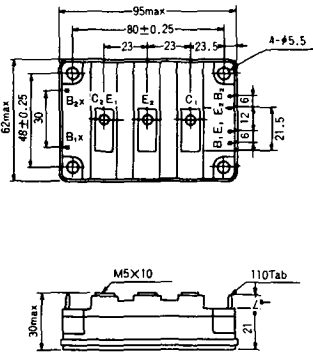

S-98B1B

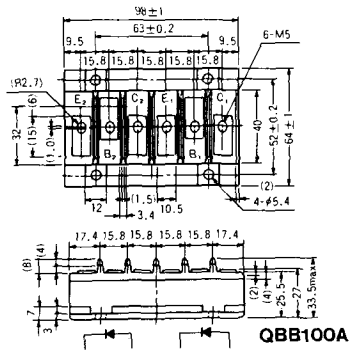

S-108A2A

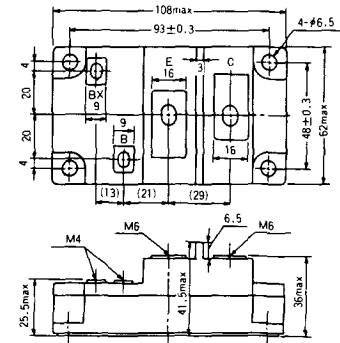

S-108B1A



S-108B1B

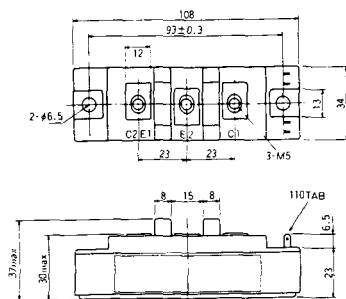

S-108B1C

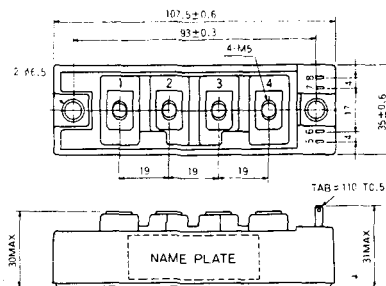

S-108B2A



S-108B2B

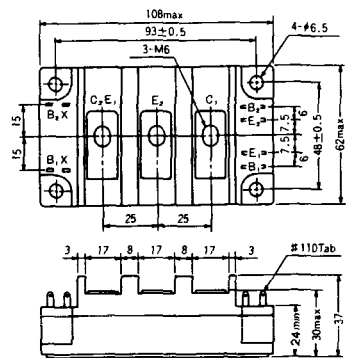

2-22B1A



2-27A4A



2-33C1A

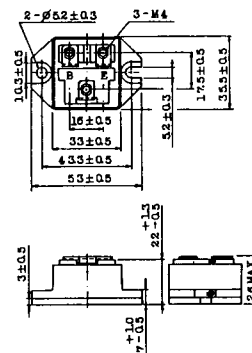

2-33D1A



2-33F1A



2-37A1A

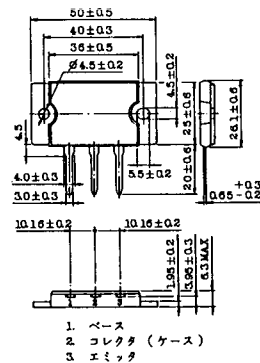

1. スイス
2. コレクタ (ケース)
3. ハミツナ

2-48A3A



2-48A3B

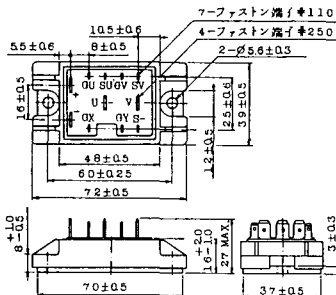

2-48A4A

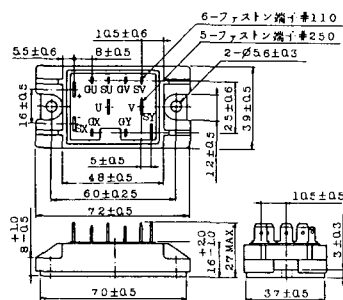

2-64A2A

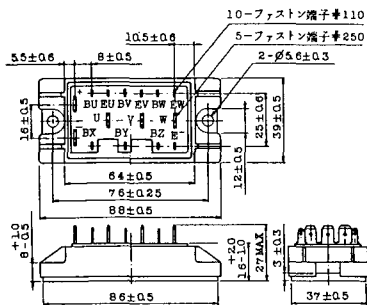

2-64A2B

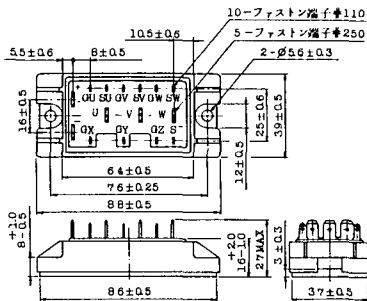

2-68A2A

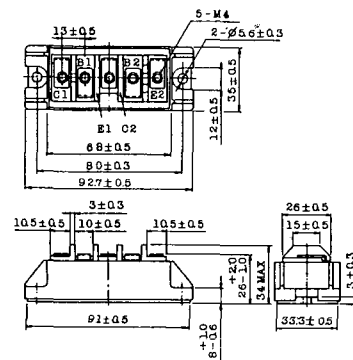

2-68B2A

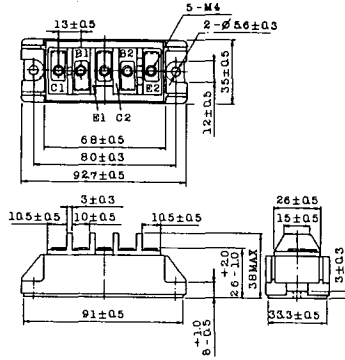

2-68C1A

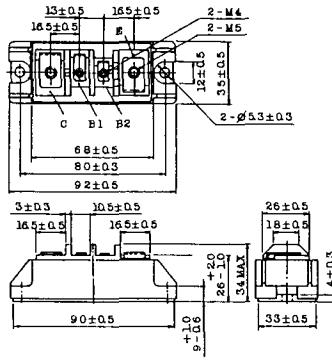

2-68D2A

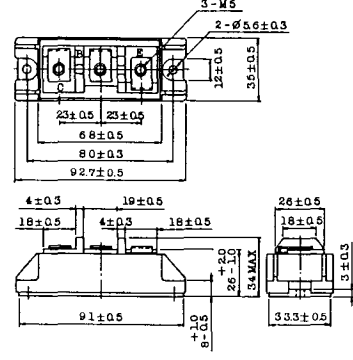

2-72A3A



2-80A1A



2-80B1A



2-80C1A

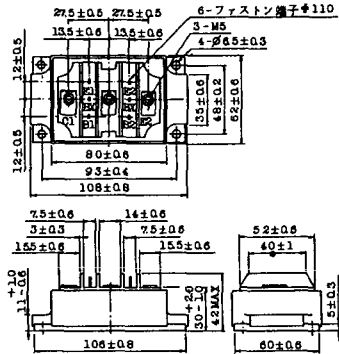

2-80D2A

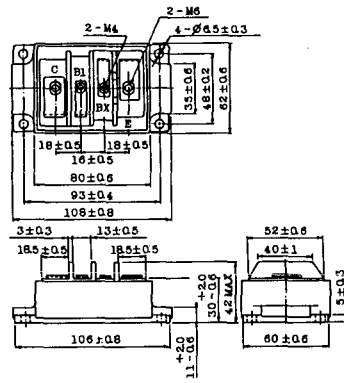

2-94A2A

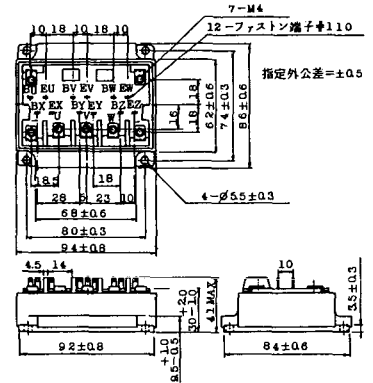

2-94B1A

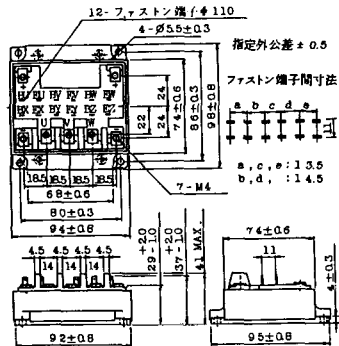

2-94C2A

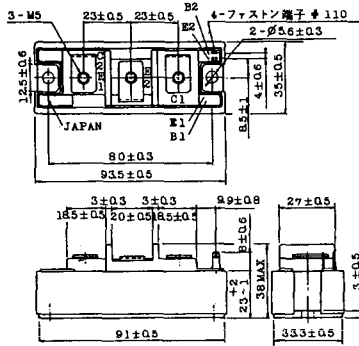

2-94C3A

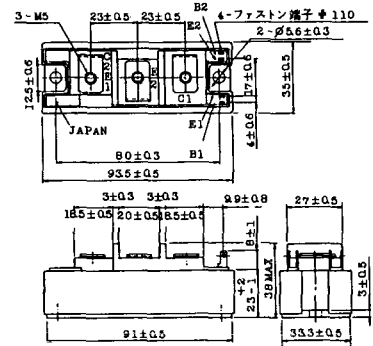

2-94D1A



2-96A3A

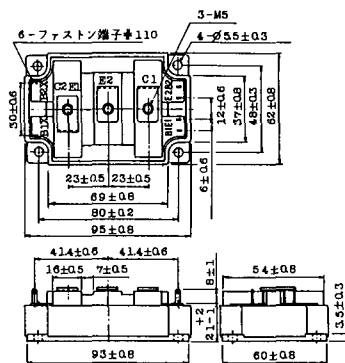

2-96A4A

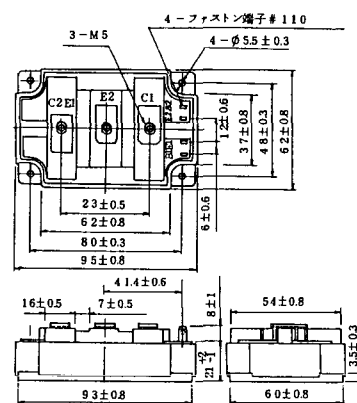

2-98B1A

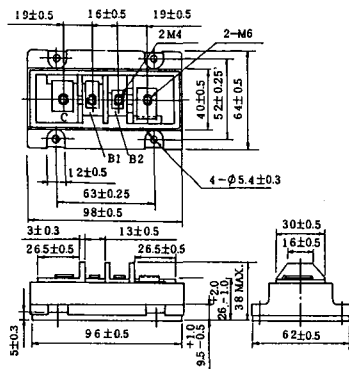

2-98C2A

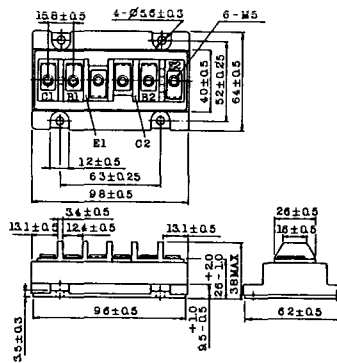

2-108A2A

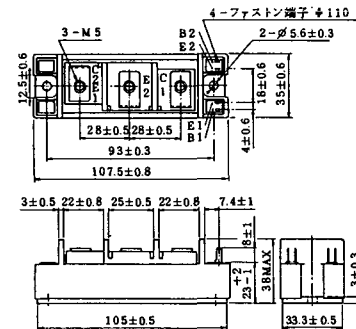

2-108B1A



2-109A3A

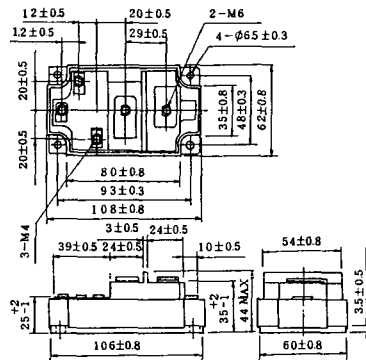

2-109A4A

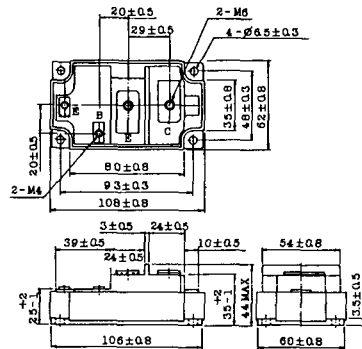

2-109B3A



2-109B4A

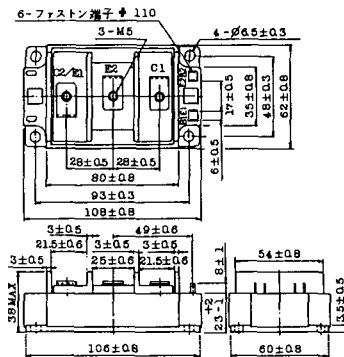

BBT-II BBTII
1D200A-020

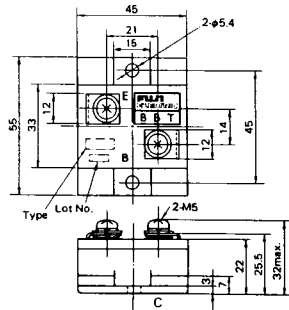

BBT-III

BBTIII
ETN31-055
ETM36-030
ETN36-030
ETN35-030

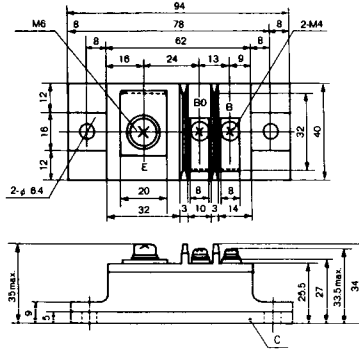

BBT-III

BBTIII
ETN01-055
ET1257

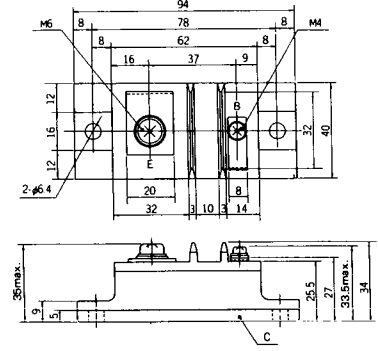

BBT-IV

BBTIV
1D500A-030

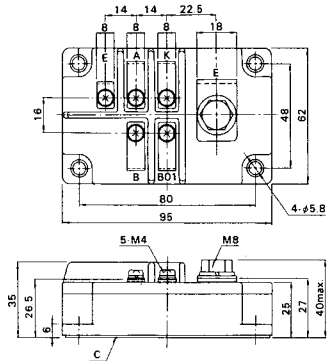

M-101

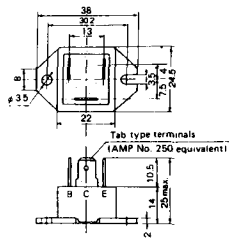

M-102

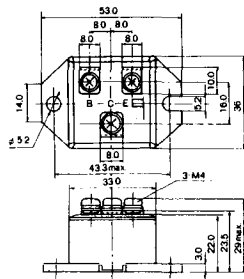

M-103

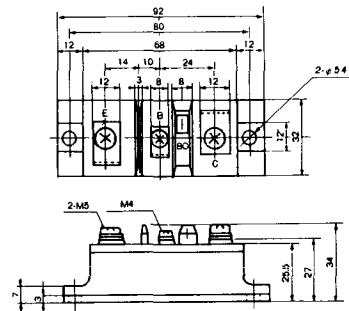

M-104



M-105

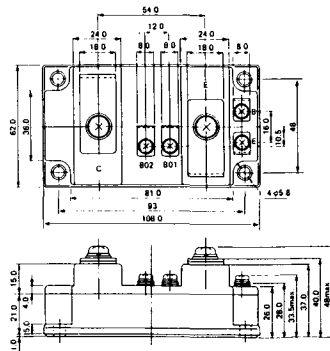

M-106

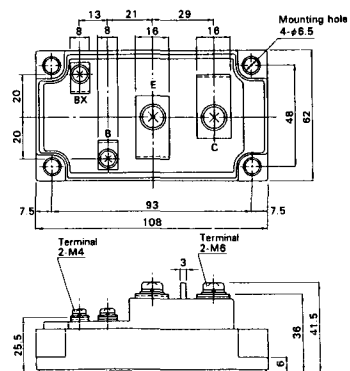

M-107



M-116

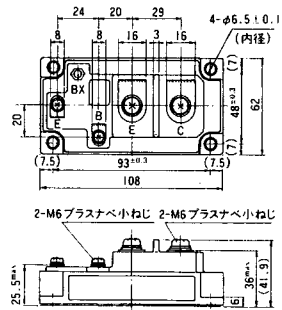

M-201

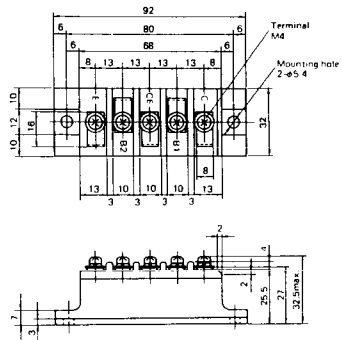

M-202

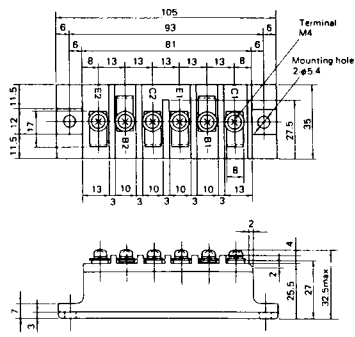

M-203

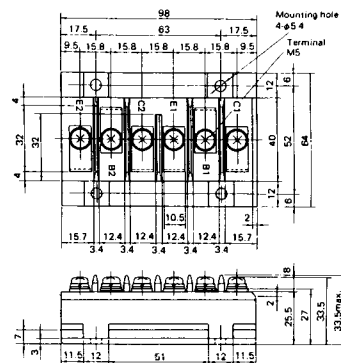

M-204

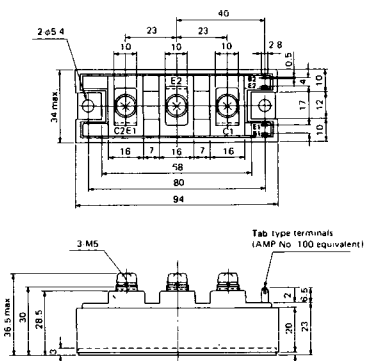

M-205



M-206



M-207



M-208

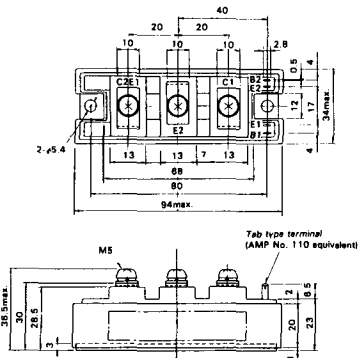

M-209

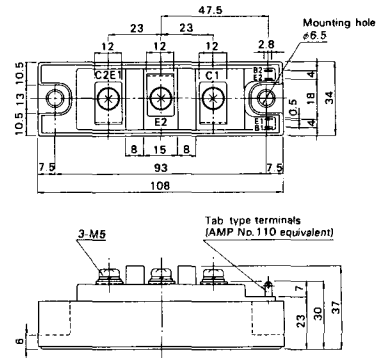

M-210



M-211

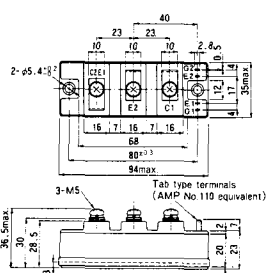

M-212

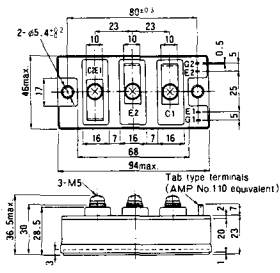

M-213

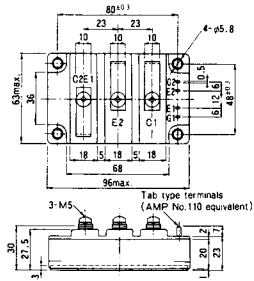

M-214

M-215

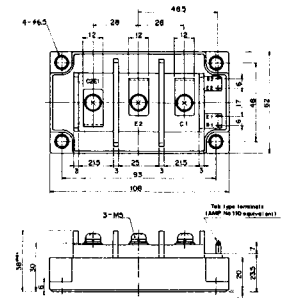

M-216

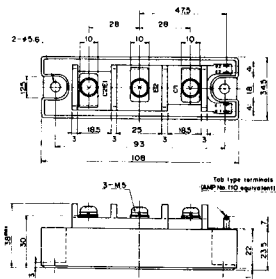

M-217

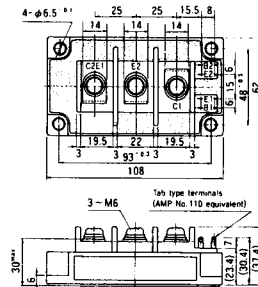

M-218

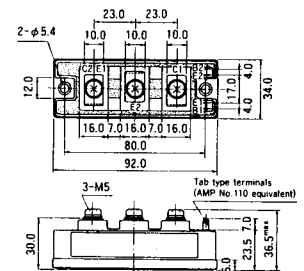

M-219



M-601

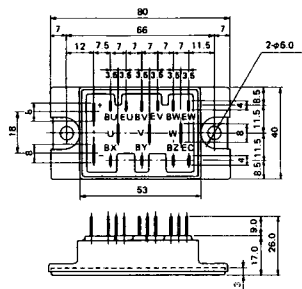

Tab type terminals
(AMP No. 110 equivalent)



Tab type terminals
(AMP No. 250 equivalent)



M-602

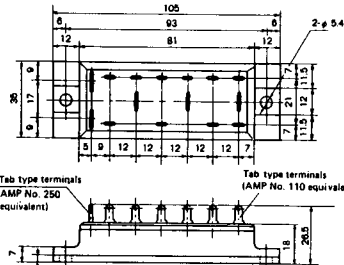

Tab type terminals
(AMP No. 250 equivalent)



Tab type terminals
(AMP No. 110 equivalent)



M-603

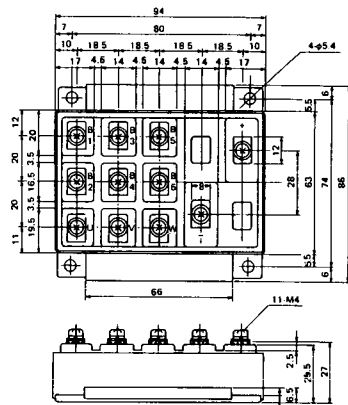

M-604

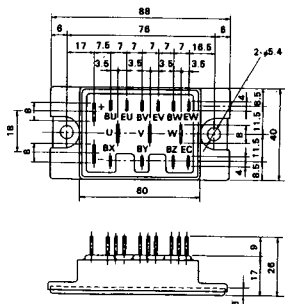

M-605

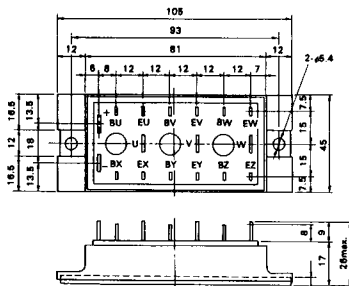

Tab type terminals
(AMP No. 110 equivalent)



Tab type terminals
(AMP No. 250 equivalent)



M-606

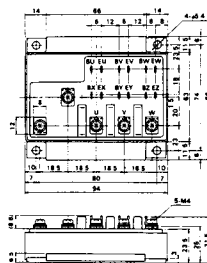

M-607



M-608

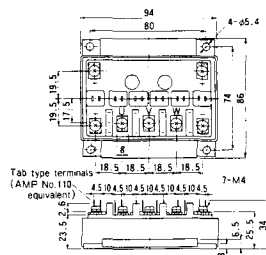

M-609



M-610

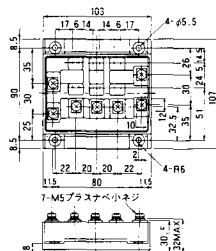

M-616



M-1A1A



M-2A1A

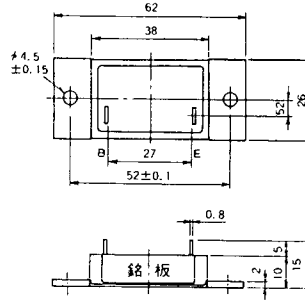

M-2B1A

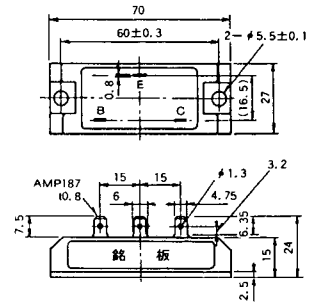

M-2B2A

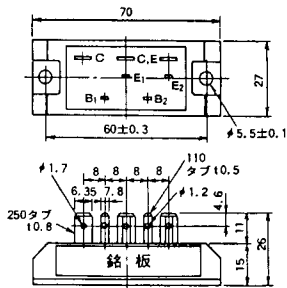

M-2C2A

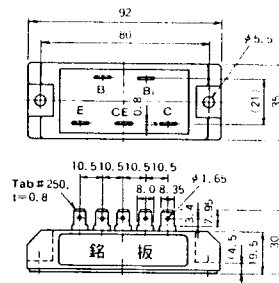

M-2D4A

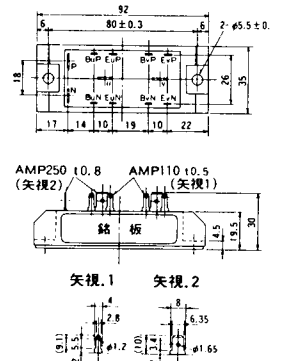

M-2E6A

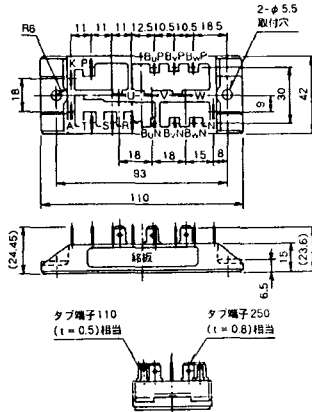

M-2F6A

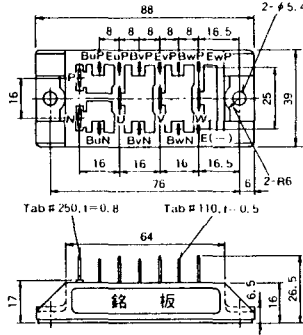

M-2G6A

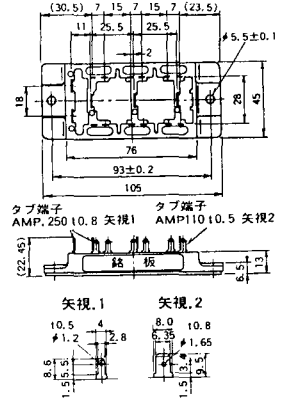

M-3A1A

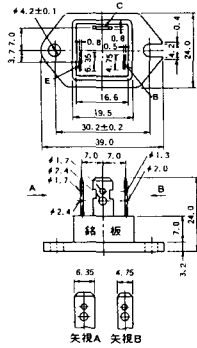

M-3B1A

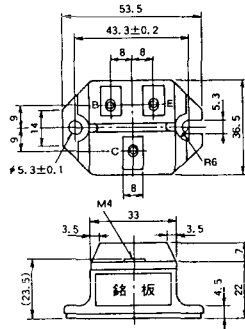

M-3B1B

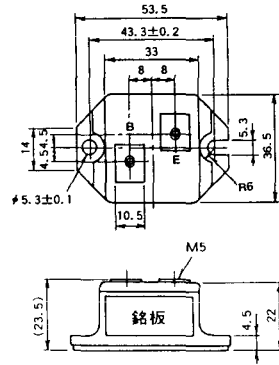

M-3C1A



M-3D6A



M-3E6A



M-4A1A

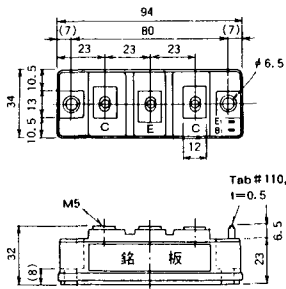

M-4A2A

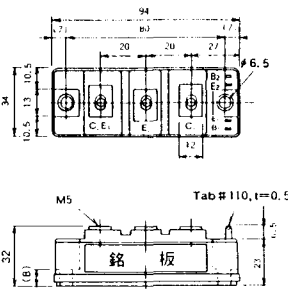

M-4A1B

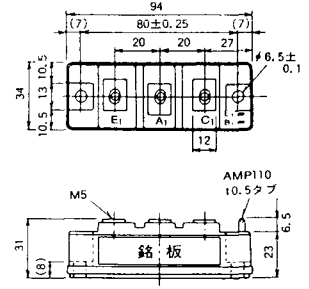

M-4A2B



M-4B2A



M-5A1A



M-5A1B



M-5A2A



M-5B2A



M-5C2A



M-5D2A



M-6A1A



M-7A1A



M-7B1A



M-8A1A

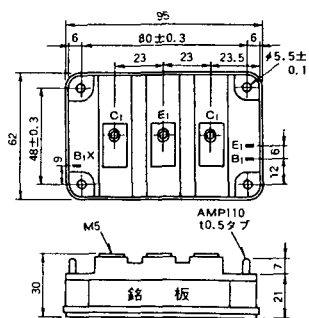

M-8A1B

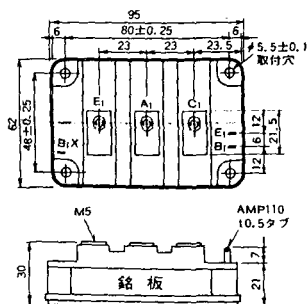

M-8A2A

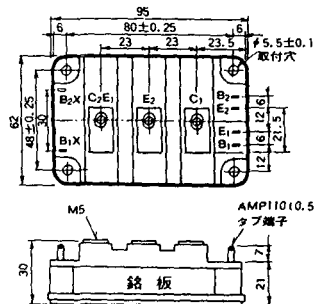

M-8A2B

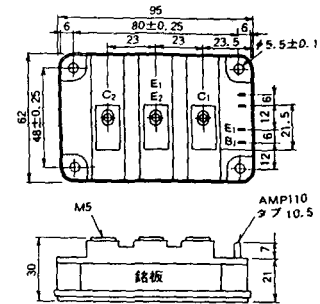

M-8B2A



M-9A1A

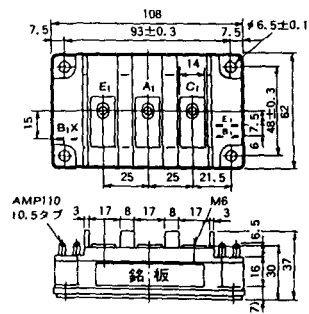

M-9A2A

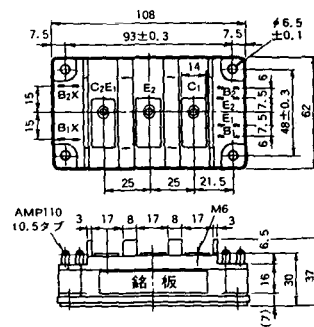

M-9B1A

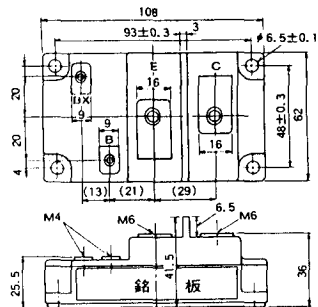

M-9C2A

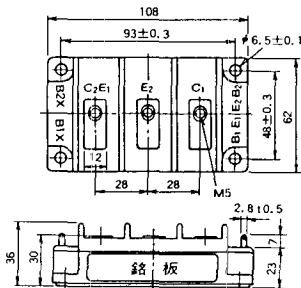

M-1A1B

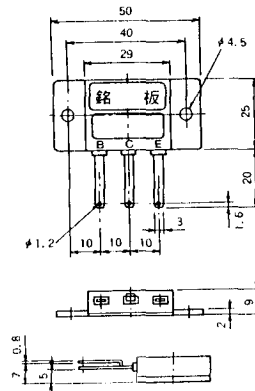

M-1A1C

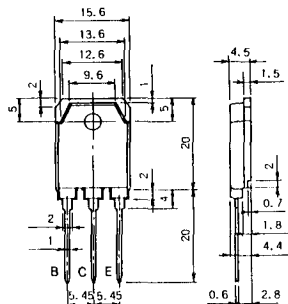

M-2E6B

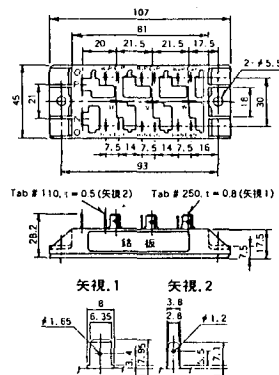

M-2E6C

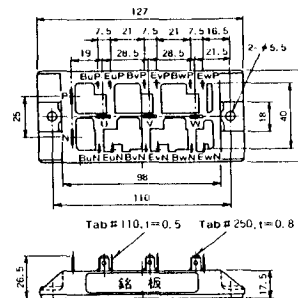

M-2G6B

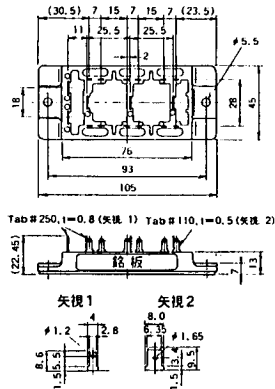

M-3D6B

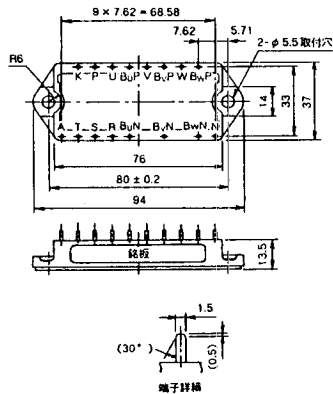

M-4A2C

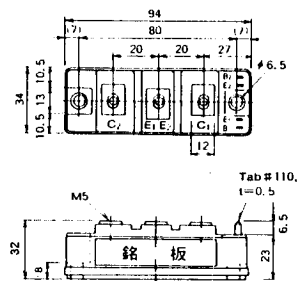

M-7A1B

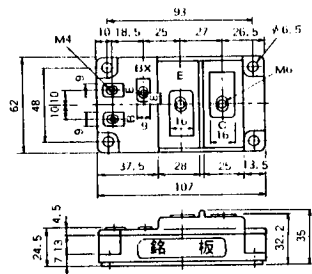

M-7C1A

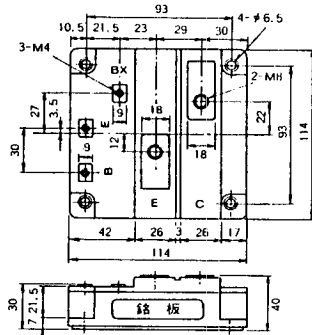

M-8A2C

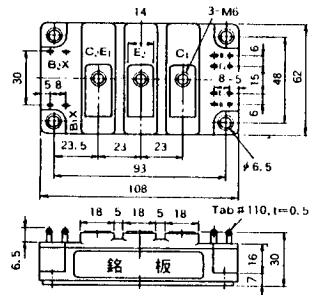

M-10A2A



M-10A2B

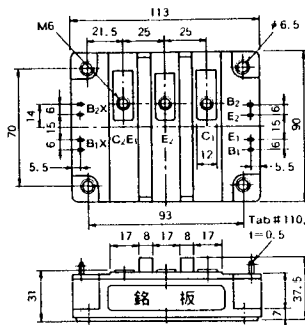

M-11A2A

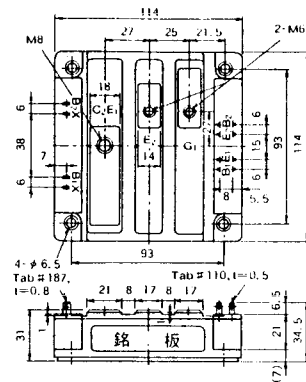

M-12A6A

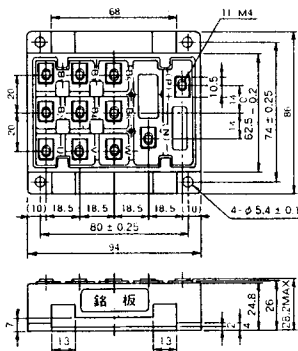

M-12B6A



M-12B6B

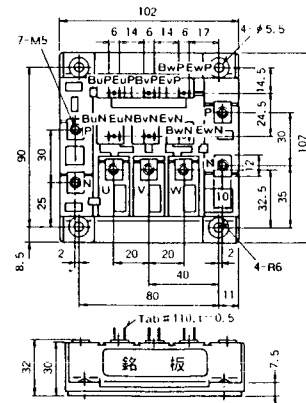

M-4A2D

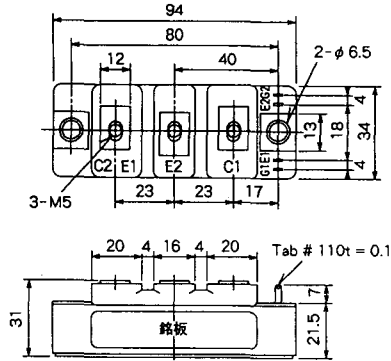

M-4A2E

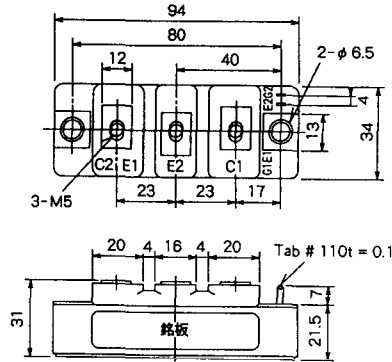

M-4C2A

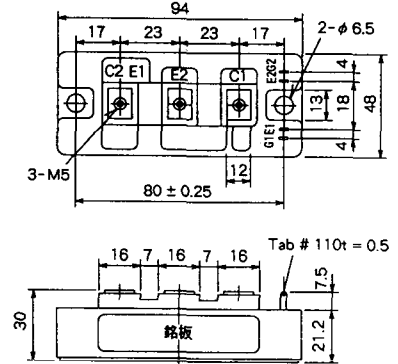

M-4C2B

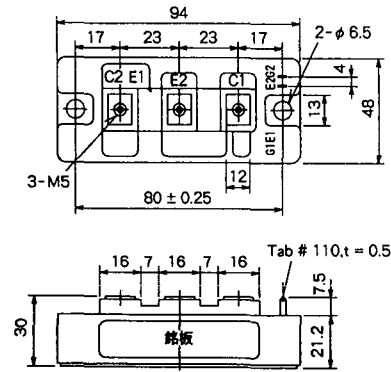

M-9B1C

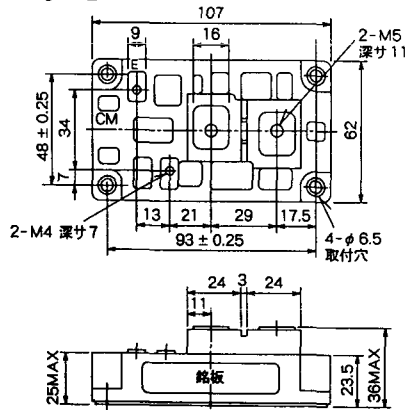

M-9D2A

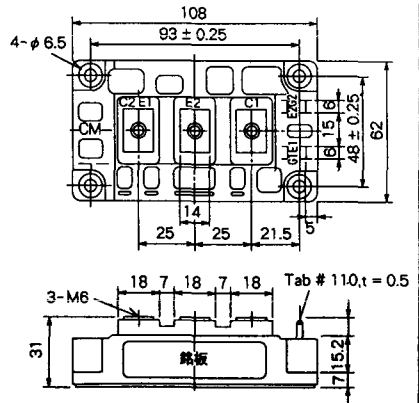

M-9D2B



M-10A2C



H-101



Weight :480g

H-201

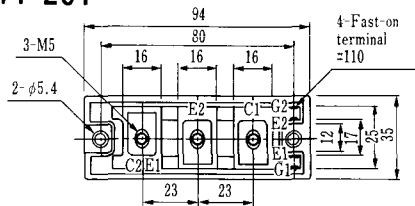

Weight: 200g

H-202



Weight: 360g

LF-J



LF-K



