

SG700 <sup>+</sup> R, U, W, EX <sub>22</sub>						■外形図番号 T-45 (13-51B1A)					
○チョップパ、インバータ用						■電気的特性					
○200A, 1300V~2500V											
■最大定格						記 号	測 定 条 件	Min	Typ	Max	単 位
記 号	SG700R22	SG700U22	SG700W22	SG700EX22	単 位	$I_{RRM}$	$T_J=125^{\circ}\text{C}$ , $V_D=V_{RRM}$			10	mA
$V_{RRM}$			15		V	$I_{DRM}$	$T_J=125^{\circ}\text{C}$ , $V_D=V_{DRM}$ , $R_{GK}=20\Omega$			10	mA
$V_{DRM}$	1300	1600	1800	2500		$V_{TM}$	$T_c=25^{\circ}\text{C}$ , $I_{TM}=700\text{A}$			2.7	V
$I_{TRM}$	700 ( $V_D=\frac{1}{2}V_{DRM}$ , $V_{DM}=\frac{3}{4}V_{DRM}$ , $C_s=2\mu\text{F}$ , $R_G=20\Omega$ , $T_J=125^{\circ}\text{C}$ )					$V_{GT}$	$T_c=25^{\circ}\text{C}$ , $V_D=12\text{V}$	0.75	1.0		V
$I_{TRMS}$	200 ( $T_J=70^{\circ}\text{C}$ )					$I_{GT}$	$R_L=0.5\Omega$	350	700		mA
$I_{TSM}$	4000/4400 (50Hz/60Hz, 正弦半波1サイクル)					$V_{GD}$	$T_c=125^{\circ}\text{C}$ , $V_D=\frac{1}{2}V_{DRM}$	0.3			V
$I^2 \cdot t$						$I_{GD}$		5			mA
$di/dt$	200 ( $I_{GP}=12\text{A}$ , $t_r=1\mu\text{s}$ , $V_D=\frac{1}{2}V_{DRM}$ , $I_{TM}=700\text{A}$ , $f=50\text{Hz}$ , $T_J=125^{\circ}\text{C}$ )					$I_d$	$T_c=25^{\circ}\text{C}$ , $V_D=\frac{1}{2}V_{DRM}$ , $I_{GP}=12\text{A}$			2.0	$\mu\text{s}$
$I_{GFM}$	30 (パルス幅: max. 20 $\mu\text{s}$ , duty: max. 20%)					$I_{kt}$	$I_{TM}=700\text{A}$ , $di/dt=200\text{A}/\mu\text{s}$			6.0	
$P_{GFI(V)}$	6					$dv/dt$	$T_J=125^{\circ}\text{C}$ , $V_D=\frac{3}{4}V_{DRM}$ , $V_{GK}=-2\text{V}$	600			V/ $\mu\text{s}$
$I_{GR(RMS)}$	35					$I_H$	$T_c=25^{\circ}\text{C}$ , $R_L=0.5\Omega$		20		A
$P_{GRM}$	4000 (パルス幅: max. 20 $\mu\text{s}$ , duty: max. 2%)					$I_L$	$T_c=120^{\circ}\text{C}$ , $I_{TM}=700\text{A}$			14	
$V_{GRM}$	15					$I_{eq}$	$V_D=\frac{1}{2}V_{DRM}$ , $V_{DM}=\frac{3}{4}V_{DRM}$			16	$\mu\text{s}$
$T_J$	125					$t_{tail}$	$C_s=2\mu\text{F}$ , $R_G=20\Omega$			76	
$T_{Jk}$	-40~-125					$I_{GR}$	$dig/dt=-20\text{A}/\mu\text{s}$		160	190	A
						$R_{th}$	接合~フィン間, DC			0.085	$^{\circ}\text{C}/\text{W}$

SG800 <sup>+</sup> R, U, W, EX <sub>11</sub> SG800 <sup>+</sup> R, U, W, EX <sub>12</sub>						■外形図番号 SG800 <sup>+</sup> J11: T-44 (13-36A1A) SG800 <sup>+</sup> J12: T-46 (13-36B1A)					
○チョップパ、インバータ用						■電気的特性					
■最大定格						記 号	測 定 条 件	Min	Typ	Max	単 位
記 号	SG800R11 SG800R12	SG800U11 SG800U12	SG800W11 SG800W12	SG800EX11 SG800EX12	単 位	$I_{RRM}$	$T_J=125^{\circ}\text{C}$ , $V_D=V_{RRM}$			10	
$V_{RRM}$			15		V	$I_{DRM}$	$T_J=125^{\circ}\text{C}$ , $V_D=V_{DRM}$ , $R_{GK}=20\Omega$			10	mA
$V_{DRM}$	1300	1600	1800	2500		$I_{GRM}$	$T_J=125^{\circ}\text{C}$ , $V_D=V_{GRM}$			10	
$I_{TRM}$	800 ( $V_D=\frac{1}{2}V_{DRM}$ , $V_{DM}=\frac{3}{4}V_{DRM}$ , $C_s=2\mu\text{F}$ , $R_G=20\Omega$ , $T_J=125^{\circ}\text{C}$ )					$V_{TM}$	$T_c=25^{\circ}\text{C}$ , $I_{TM}=800\text{A}$			2.4	V
$I_{TRMS}$	300 ( $T_J=70^{\circ}\text{C}$ )					$V_{GT}$	$T_c=25^{\circ}\text{C}$ , $V_D=12\text{V}$	0.75	1.0		V
$I_{TSM}$	5000/5500 (50Hz/60Hz, 正弦半波1サイクル)					$I_{GT}$	$R_L=0.5\Omega$	350	700		mA
$I^2 \cdot t$						$V_{GD}$	$T_c=125^{\circ}\text{C}$ , $V_D=\frac{1}{2}V_{DRM}$	0.3			V
$di/dt$	200 ( $I_{GP}=12\text{A}$ , $t_r=1\mu\text{s}$ , $V_D=\frac{1}{2}V_{DRM}$ , $I_{TM}=800\text{A}$ , $f=50\text{Hz}$ , $T_J=125^{\circ}\text{C}$ )					$I_{GD}$		4			mA
$I_{GFM}$	30 (パルス幅: max. 20 $\mu\text{s}$ , duty: max. 20%)					$t_d$	$T_c=25^{\circ}\text{C}$ , $V_D=\frac{1}{2}V_{DRM}$			3.0	$\mu\text{s}$
$P_{GFI(V)}$	6					$t_{kt}$	$I_{TM}=800\text{A}$ , $di/dt=200\text{A}/\mu\text{s}$ $I_{GP}=12\text{A}$ , $t_r=1\mu\text{s}$			8.0	
$I_{GR(RMS)}$	35					$dv/dt$	$T_J=125^{\circ}\text{C}$ , $V_D=\frac{3}{4}V_{DRM}$ $V_{GK}=-2\text{V}$	600			V/ $\mu\text{s}$
$P_{GRM}$	4000 (パルス幅: max. 20 $\mu\text{s}$ , duty: max. 2%)					$I_H$	$T_c=25^{\circ}\text{C}$ , $R_L=0.5\Omega$		20		A
$V_{GRM}$	15					$I_L$	$T_c=120^{\circ}\text{C}$ , $I_{TM}=800\text{A}$			14	
$T_J$	125					$t_{eq}$	$V_D=\frac{1}{2}V_{DRM}$ $V_{DM}=\frac{3}{4}V_{DRM}$			16	$\mu\text{s}$
$T_{Jk}$	-40~-125					$t_{tail}$	$C_s=2\mu\text{F}$ $R_S=20\Omega$ $dig/dt=-20\text{A}/\mu\text{s}$			76	
						$I_{GR}$			170	200	A
						$R_{th}$	接合~ケース間, DC			0.09	$^{\circ}\text{C}/\text{W}$

FD-1

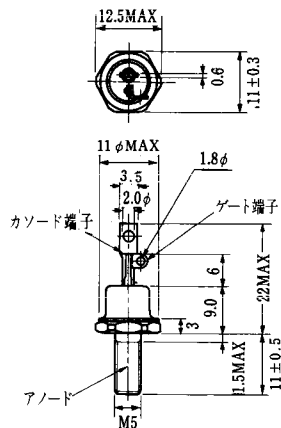

FD-2

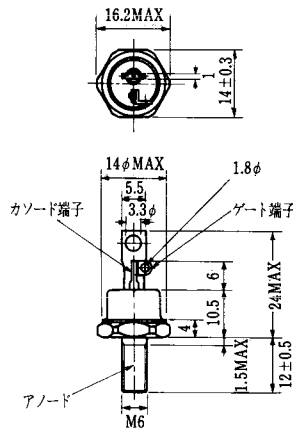

FD-3

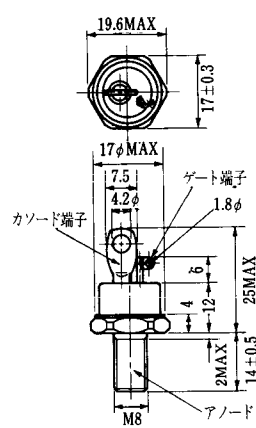

FD-4

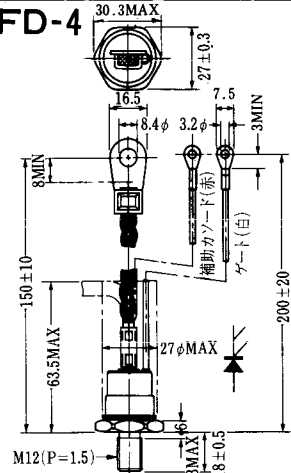

FD-5

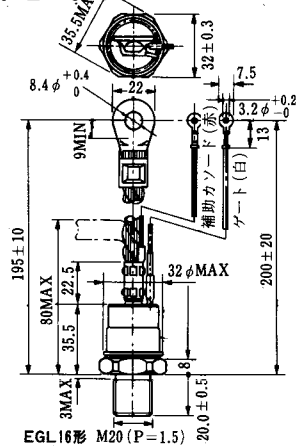

FD-6

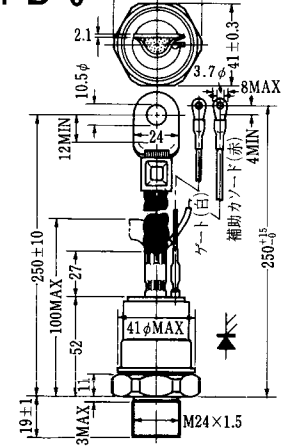

FD-7

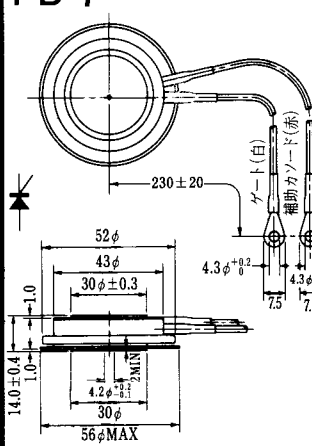

FD-8

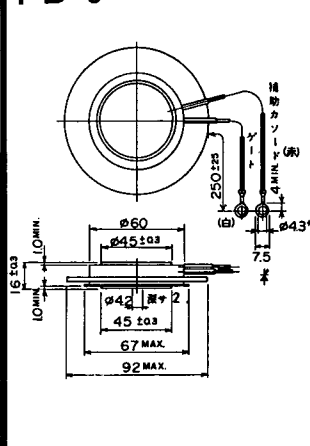

**FD-9**

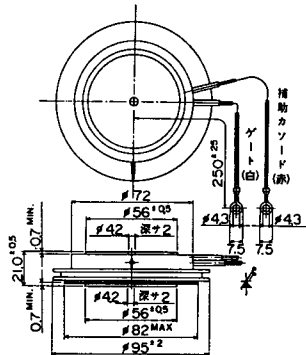

FD-10

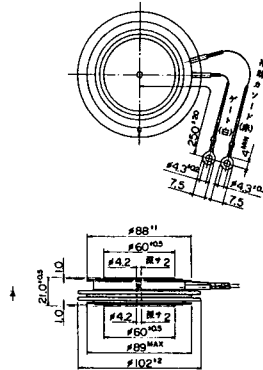

FD-11

FD-12

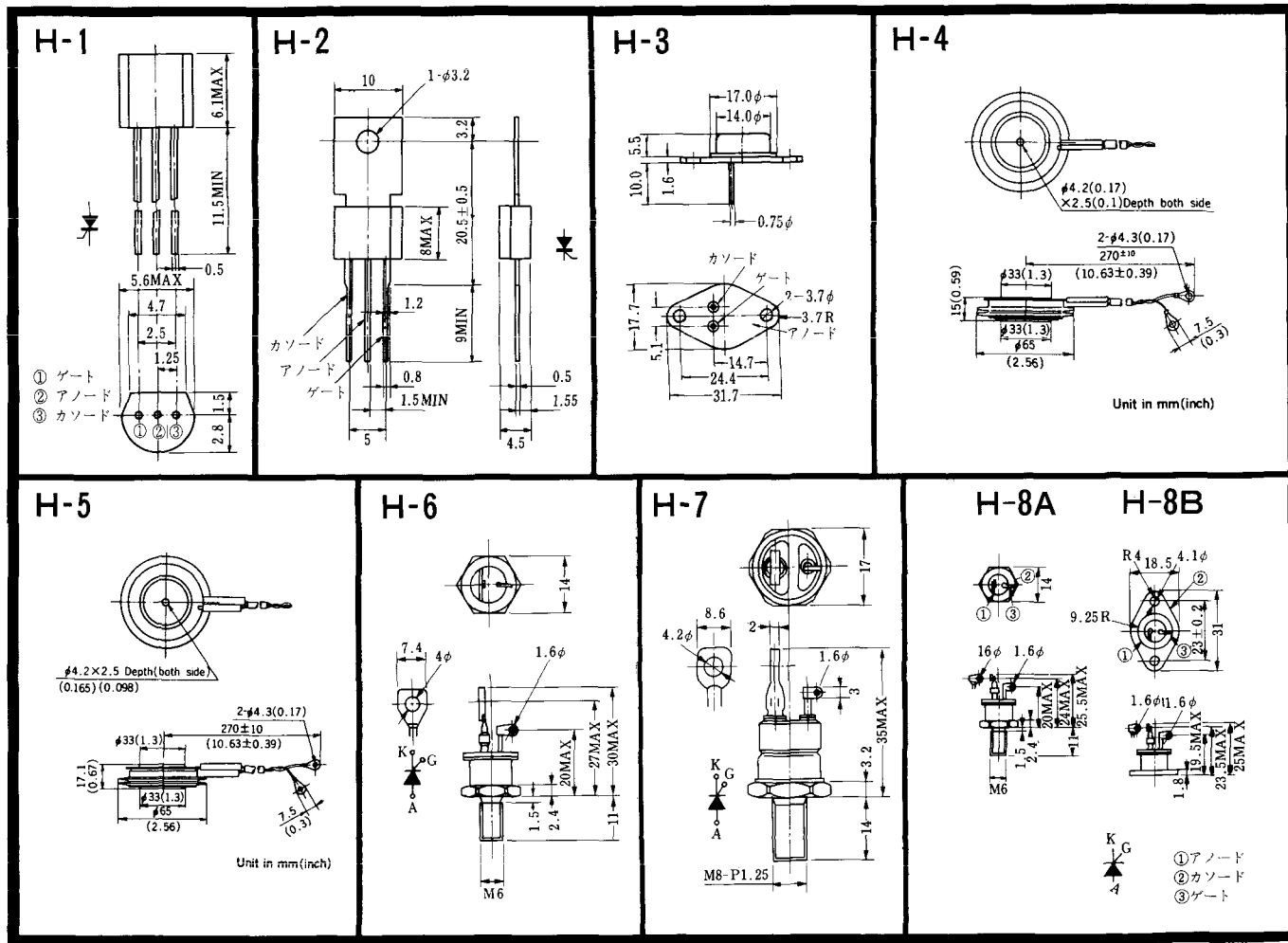

# H-9A

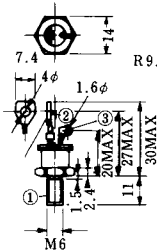

# H-9B

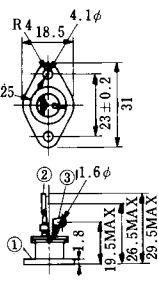

- ① アノード
- ② カソード
- ③ ゲート

# H-10

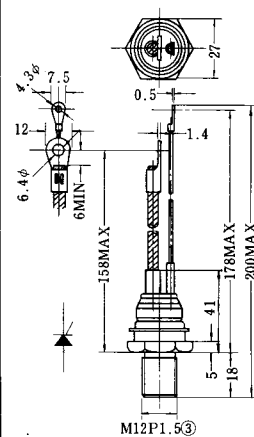

M12P1.5③

# H-11

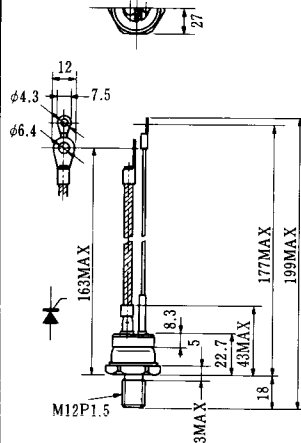

M12P1.5

# H-12

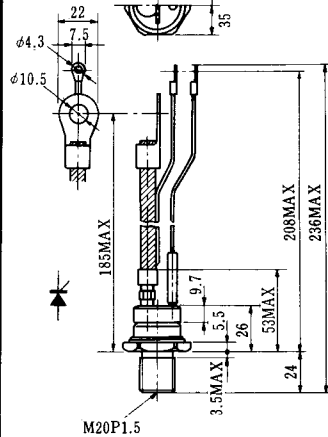

M20P1.5

# H-13

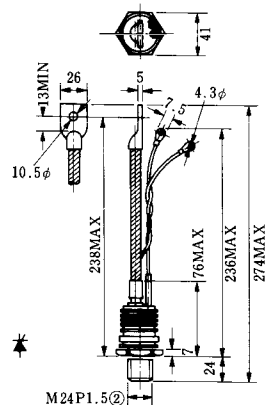

M24P1.5②

# H-14

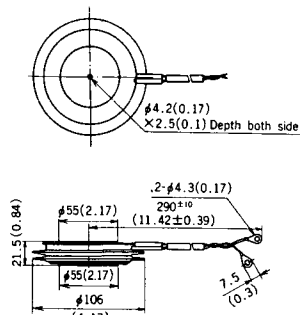

Unit in mm (inch)

# H-15

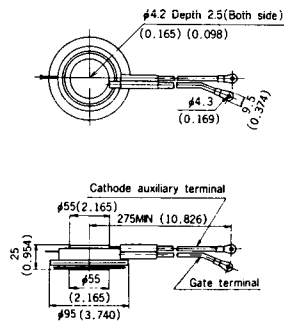

Cathode auxiliary terminal  
Gate terminal

Unit in mm (inch)

# H-16

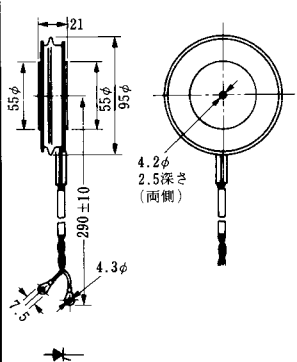

# H-17

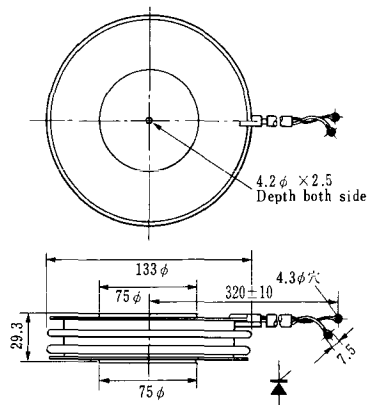

# H-18

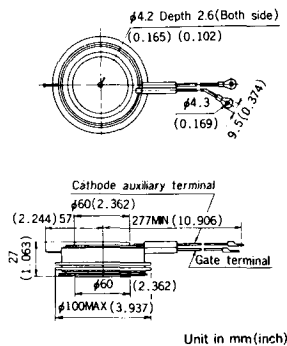

# H-19

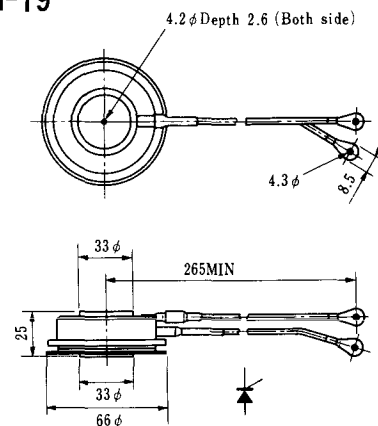

# H-20

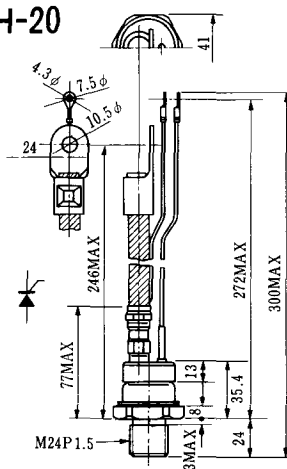

# H-21

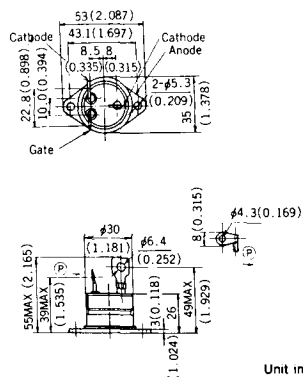

# H-22

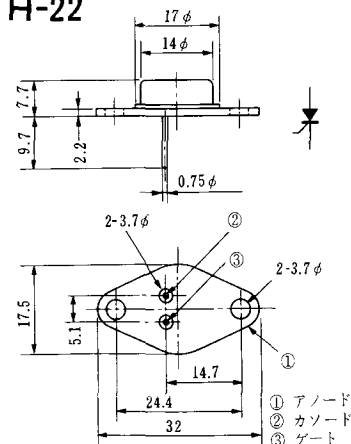

# H-23

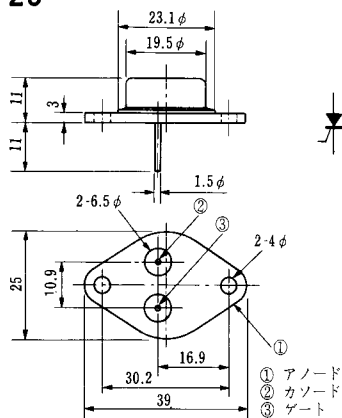

# H-24

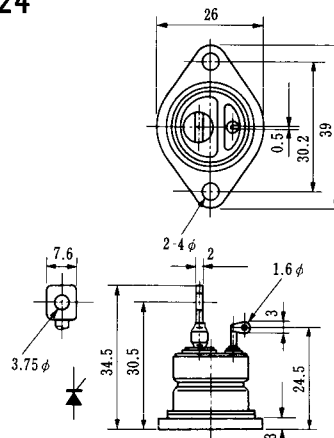

# H-25

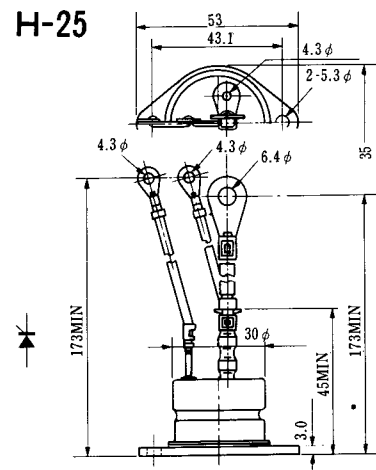

# H-26

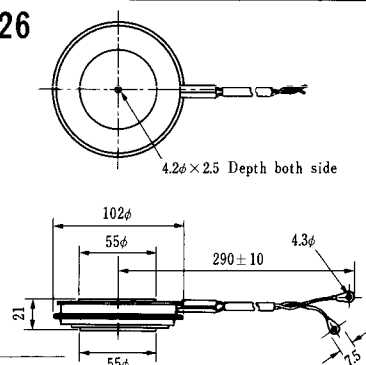

Type	Direction of polarity
CA12	

# H-27

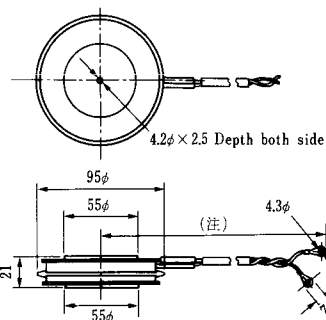

Type	Direction of polarity
CF11V	

(注) CC11V: 400 ± 10  
CF11V: 250 ± 10

# H-28

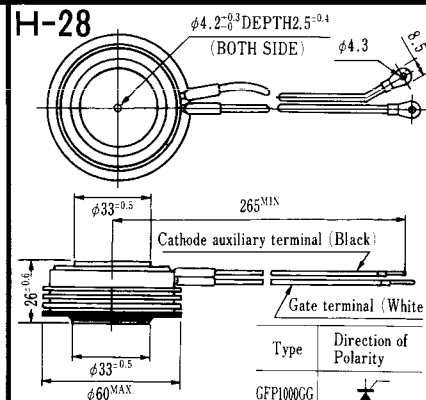

Type	Direction of Polarity
GFP100GG	

Weight: 360(g)

Note: The thickness is a dimension in press at the rated mounting force.

H-29

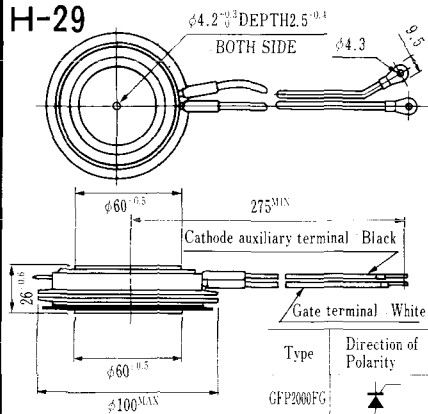

Note : The thickness is a dimension in press at the rated mounting force. Weight: 870(g)

H-30

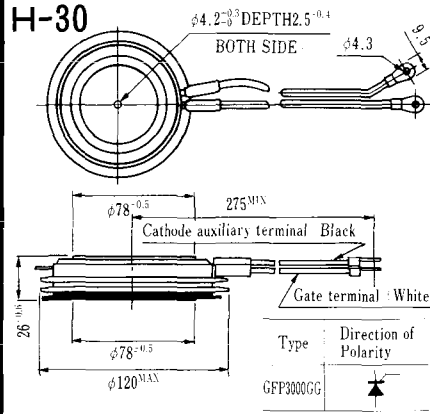

Note : The thickness is a dimension in press at the rated mounting force. Weight: 1,460(g)



# HT-1

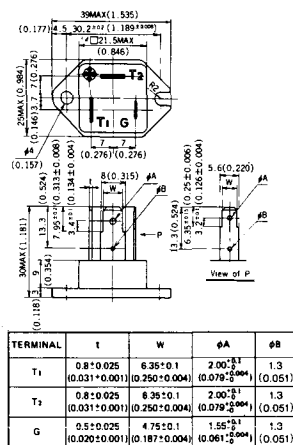

Unit in mm (inch)

# HT-2

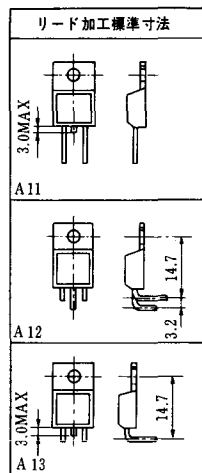
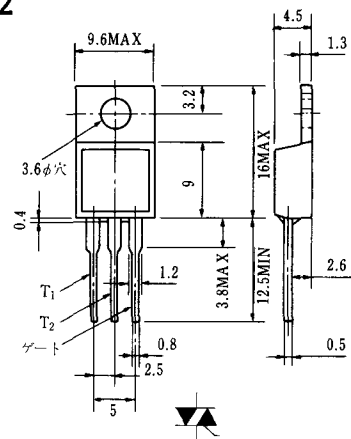

# HT-3

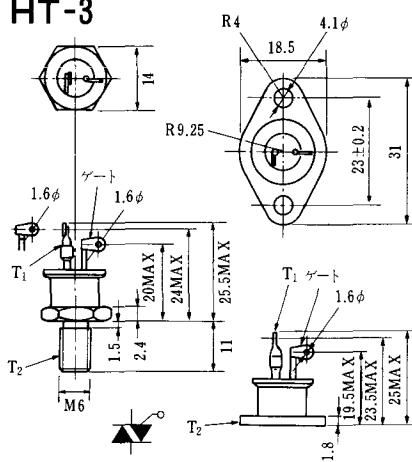

# HT-4

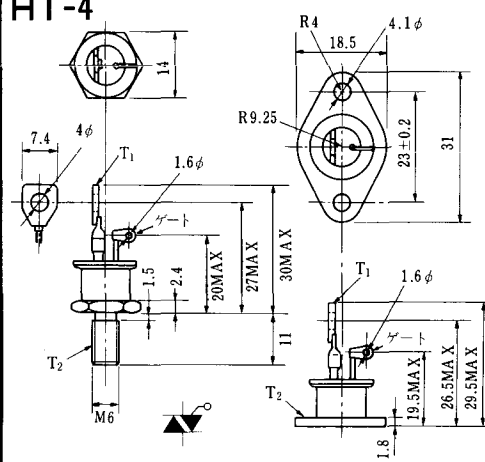

# HT-5

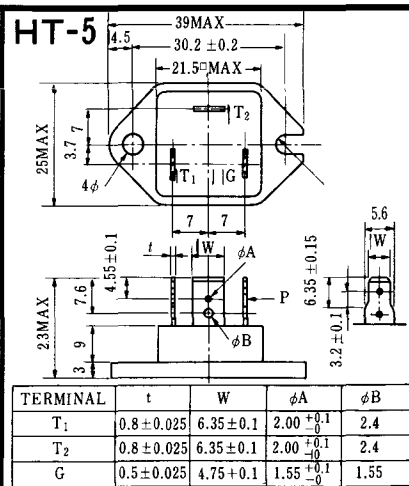

《寸法図単位：mm》

M-1

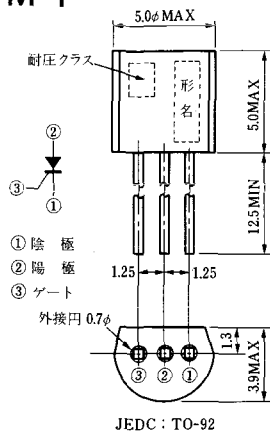

M-2

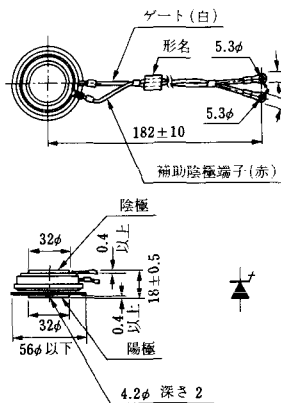

M-3

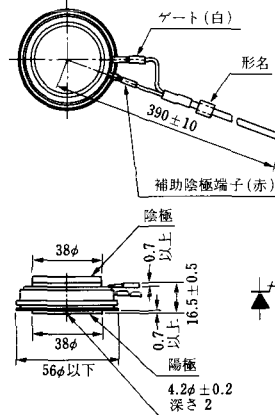

M-4

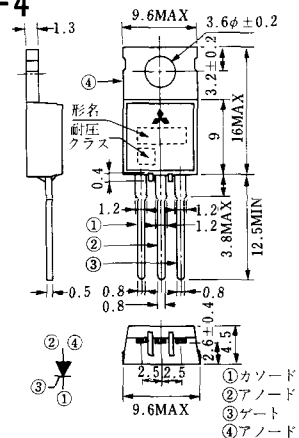

M-5

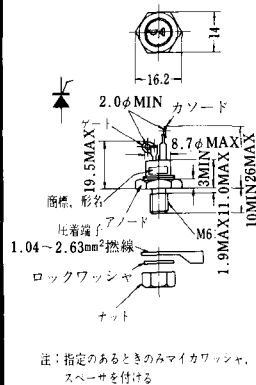

M-6

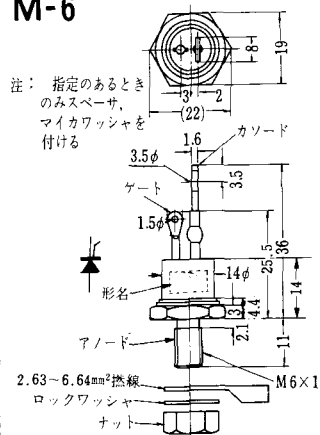

M-7

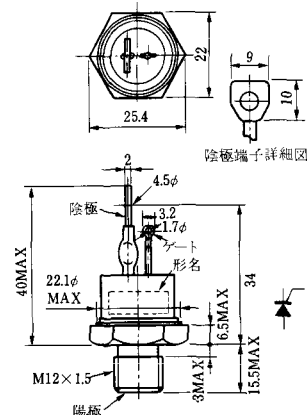

M-8

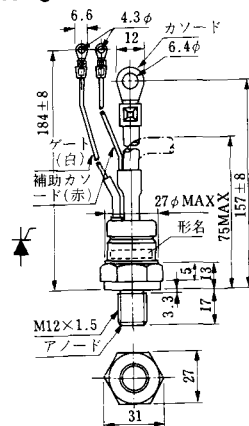

M-9

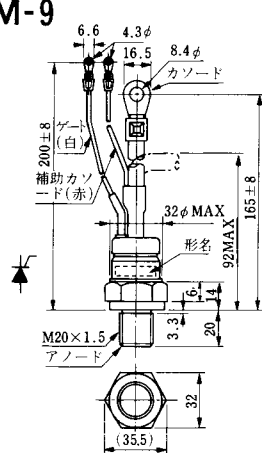

M-10

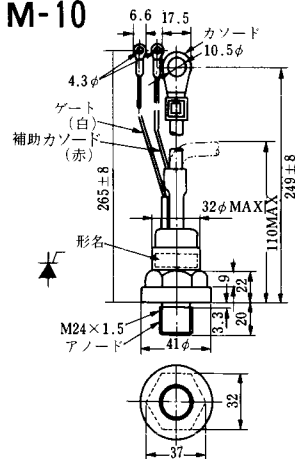

M-11

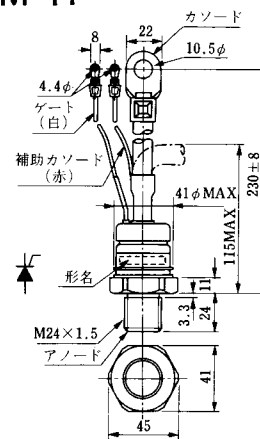

M-12

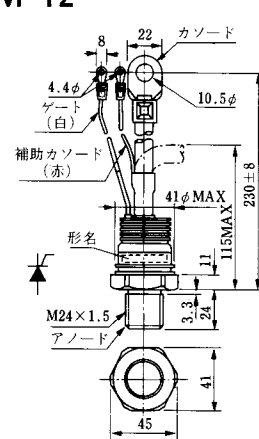

M-13

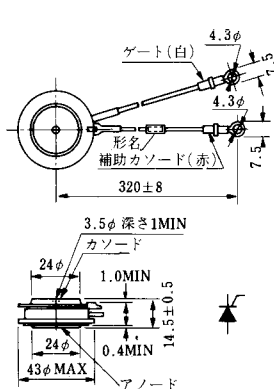

M-14

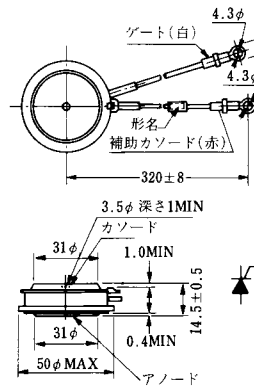

M-15

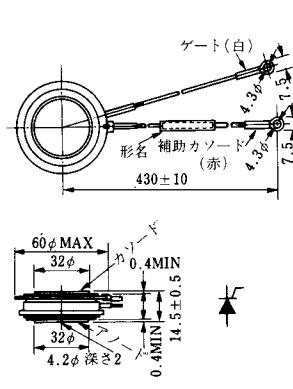

M-16

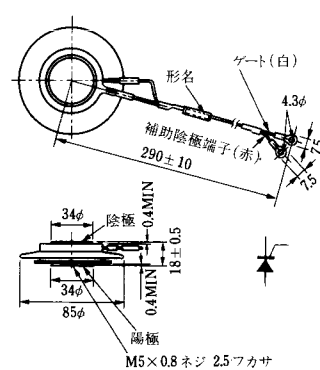

M-17

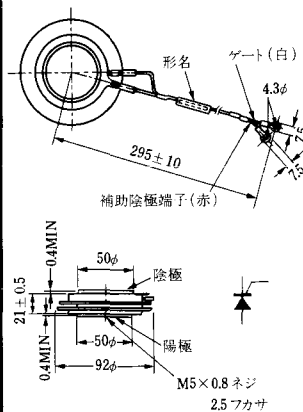

M-18

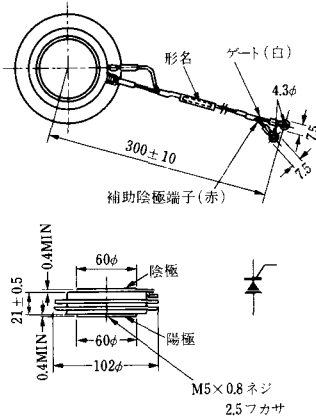

M-19

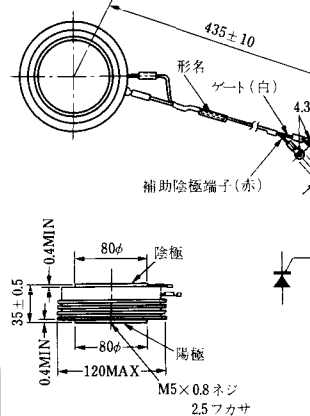

M-20

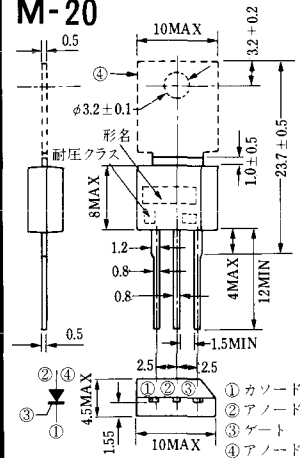

M-21

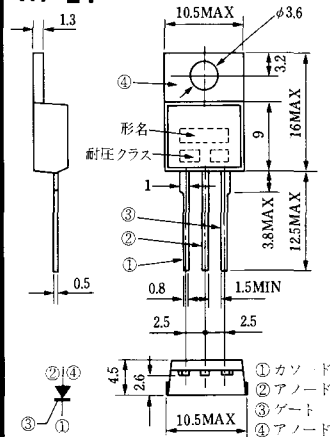

M-22

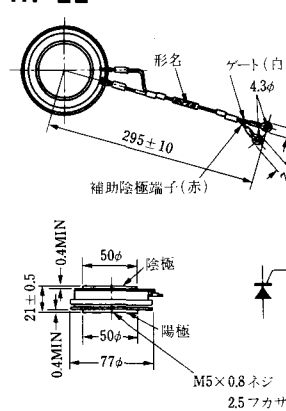

M-23

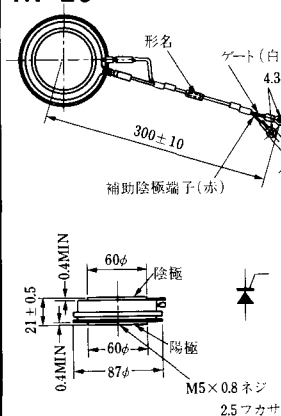

M-24

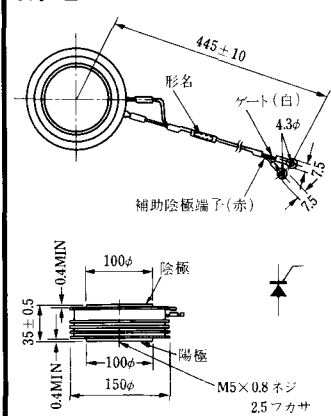

M-25

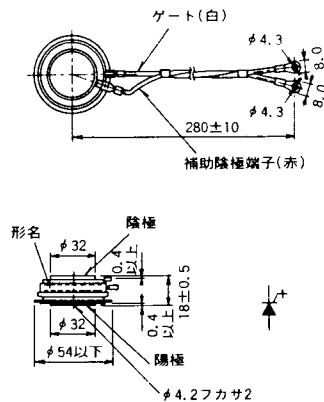

M-26

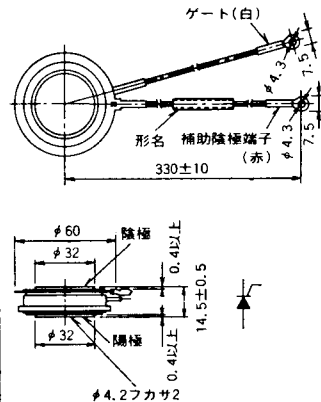

M-27

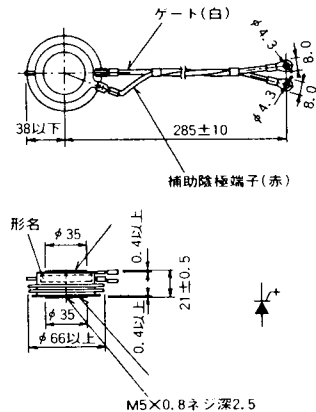

M-28

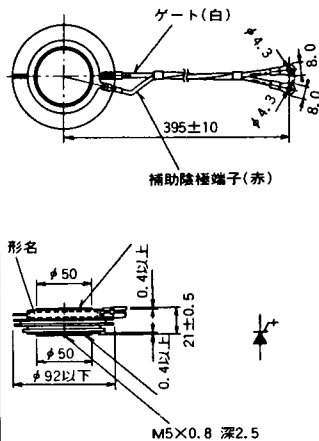

M-29

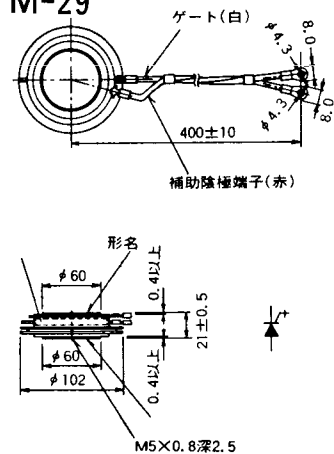

M-30

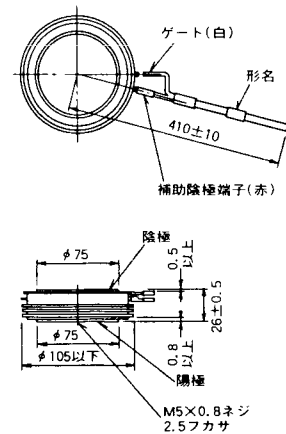

M-31

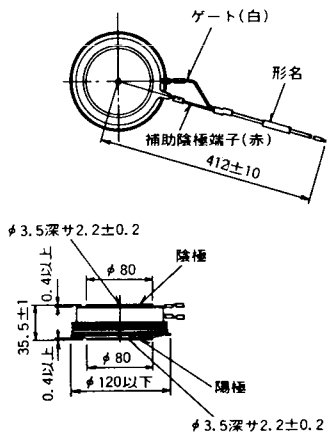

M-32

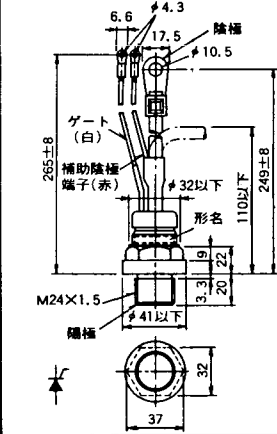

M-33

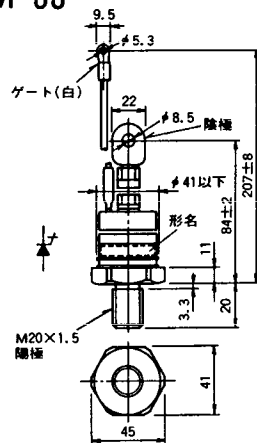

M-34

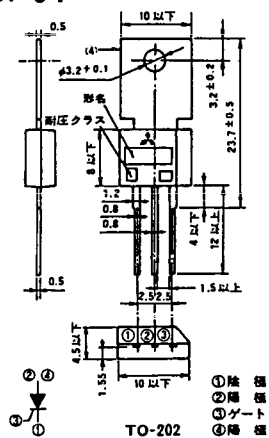

# MT-1

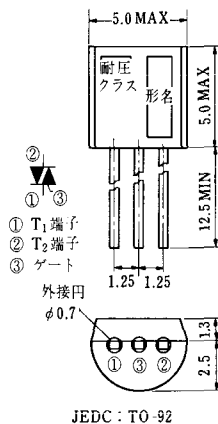

# MT-2

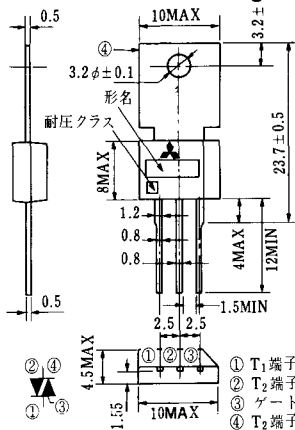

# MT-3

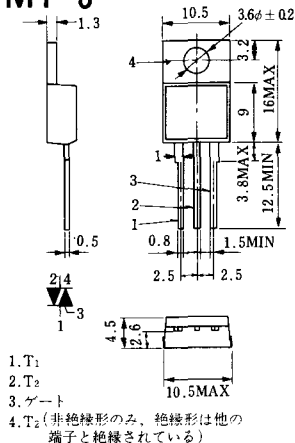

# MT-4

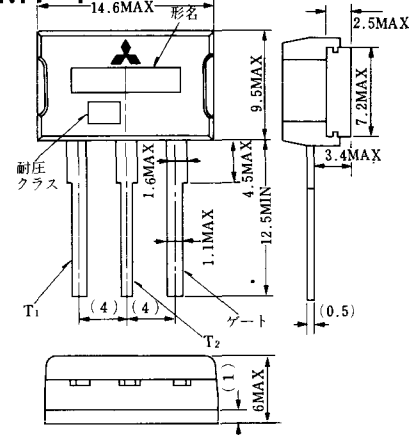

# MT-5

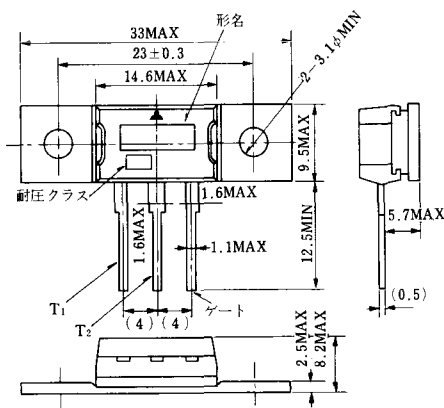

# MT-6

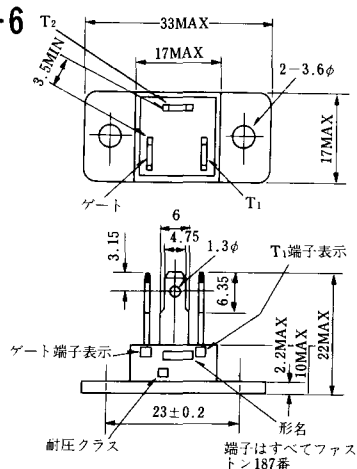

# MT-7

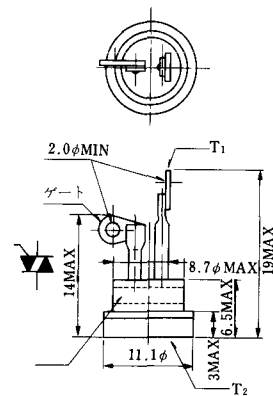

MT-8

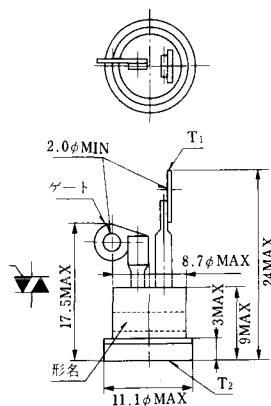

MT-9

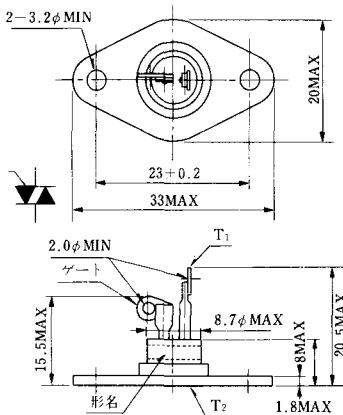

MT-10

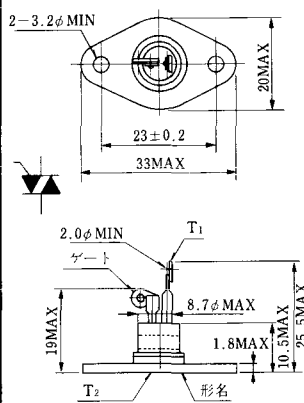

MT-11

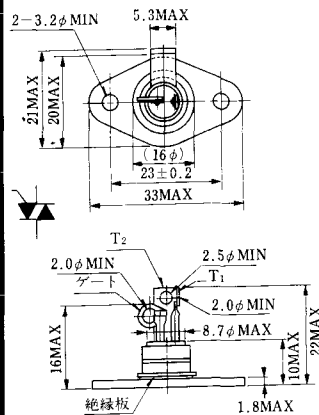

MT-12

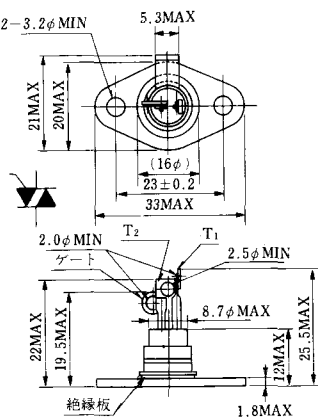

MT-13

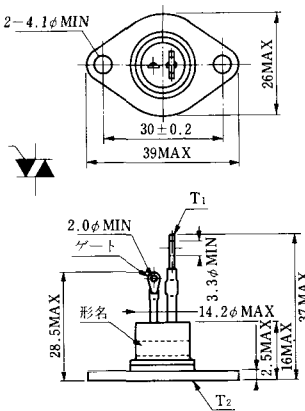

MT-14

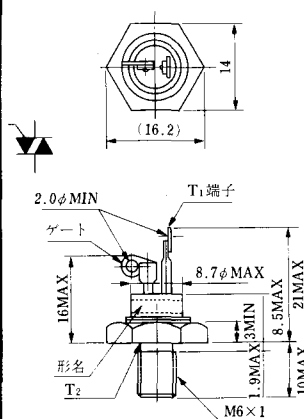

MT-15

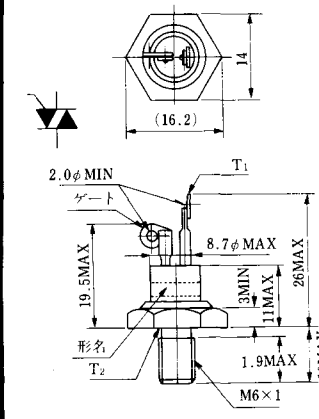



MT-16

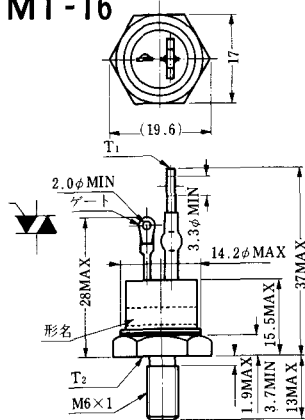

MT-17

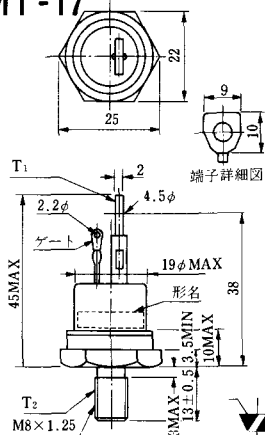

MT-18

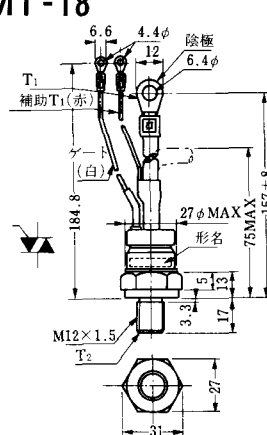

MT-19

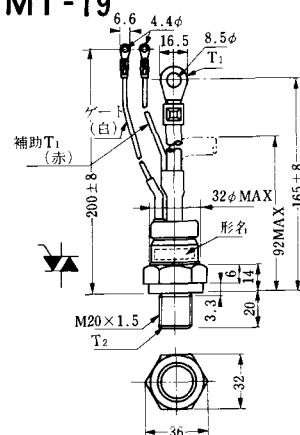

MT-20

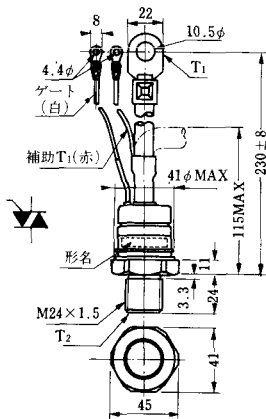

MT-21

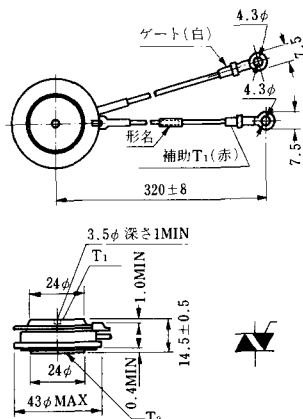

MT-22

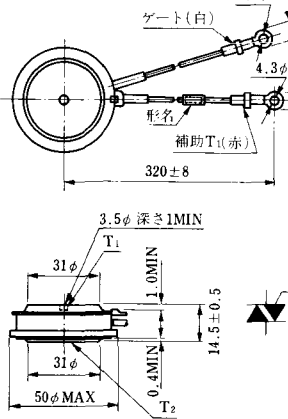

MT-23

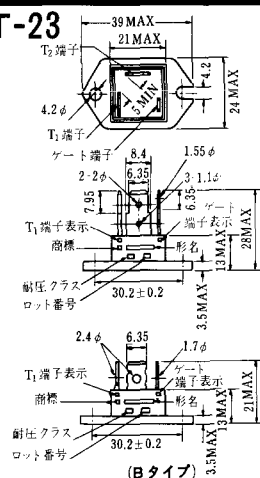

# MT-24

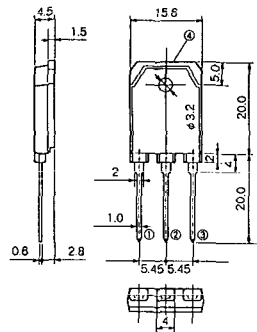

TO - 3P

- ① T1 端子
- ② T2 端子
- ③ ゲート端子
- ④ T2 端子



N-9

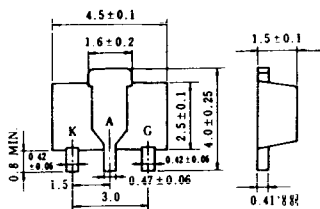

電極接続

K : カソード

A : アノード

G : ゲート

# NA-1

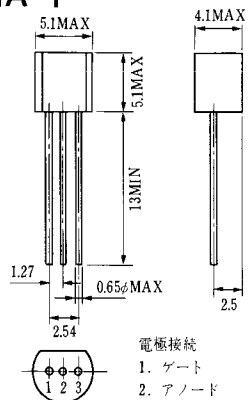

電極接続

1. ゲート
2. アノード
3. カソード

JEDEC: TO-92

# NA-2

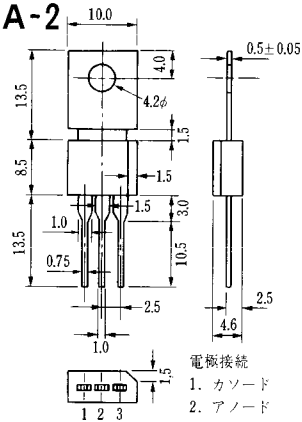

電極接続

1. カソード
2. アノード
3. ゲート

JEDEC: TO-202AA

## NI-1

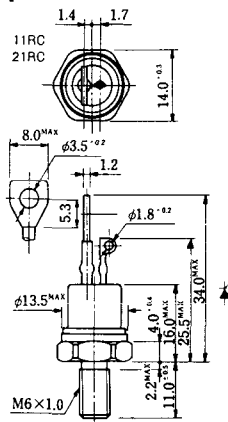

## NI-2

29RD

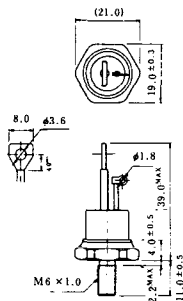

## NI-3

39RC  
59RC  
39RF  
59RF

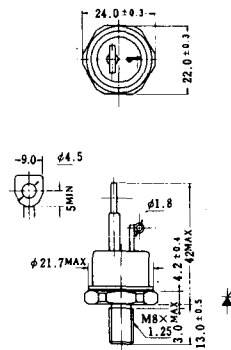

## NI-4

68RP, 88RP, 108RP, 68RS,  
88RS, 78RT, 88RLD, 88RLE,  
88RLF, 88RLG, 88RLH, 108RLE

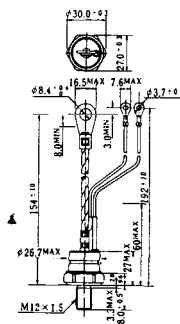

## NI-5

158RP, 208RP, 128RS, 178RS,  
158RT, 178RLD, 178RLE,  
178RLF, 178RLG, 178RLH,  
208RLE

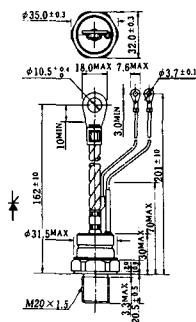

## NI-6

308RP, 408RP, 508RP, 278RS,  
358RS, 258RT, 258RLD, 258RLG,  
258RLH, 308RLE, 308RLF,  
358RLE

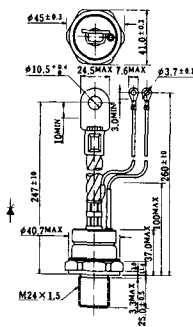

## NI-7

89RW $\frac{1}{2}$ L  
129RW $\frac{1}{2}$ L

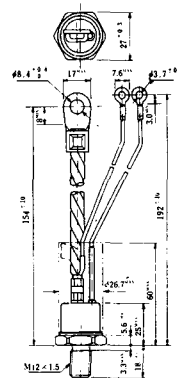

## NI-8

89RW  
129RW

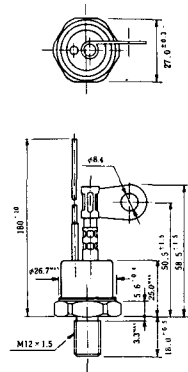



# NI-16

503PLF  
503PLH

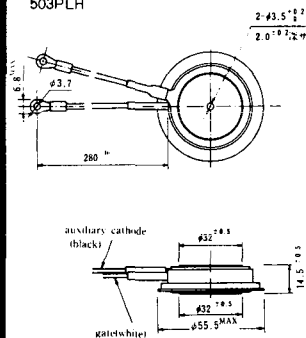

# NI-17

3003PA

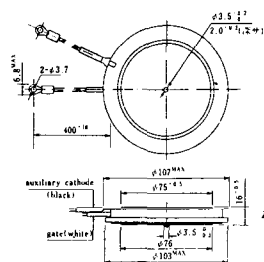

# NI-18

353PGA「E

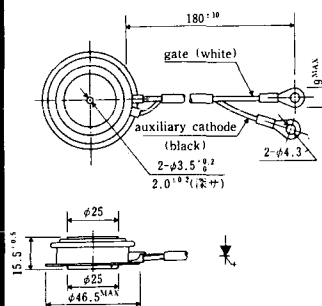

# NI-19

603PGA, 603PGA「A, 803PGA

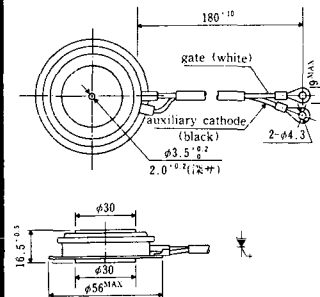

# NI-20

603PGA「E

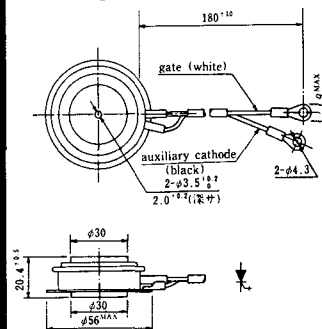

# NI-21

1001PGB「E

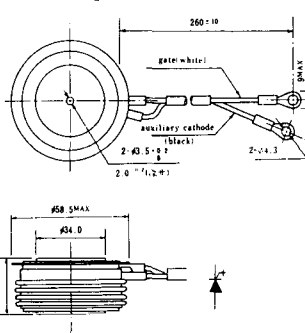

# NI-22

1201PGA, 1201PGA「A, 1401PGA

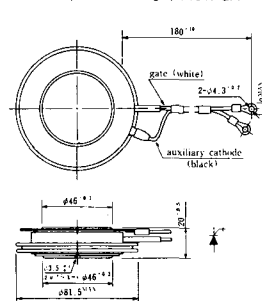

# NI-23

1201PGA「E

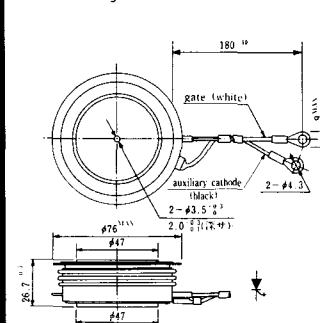



NI-24

2001PGB<sup>®</sup> JE

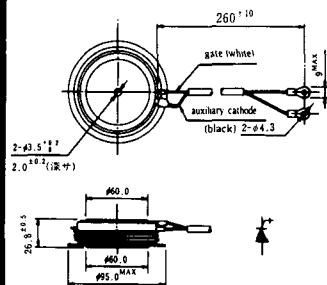

NI-25

NI-26

# NT-1

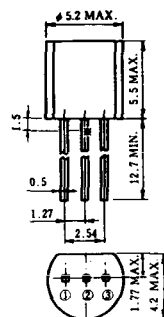

電線接続  
① T<sub>1</sub>  
② ゲート  
③ T<sub>2</sub>

# NT-2

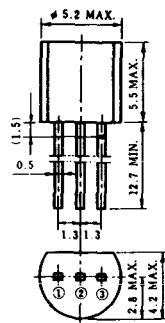

電線接続  
① T<sub>1</sub>  
② ゲート  
③ T<sub>2</sub>

# NT-3

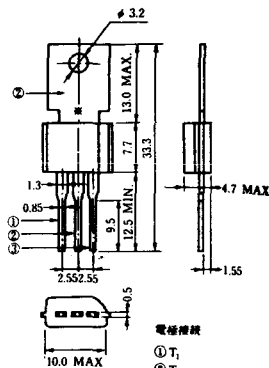

電線接続  
① T<sub>1</sub>  
② T<sub>2</sub>  
③ ゲート

# NT-4

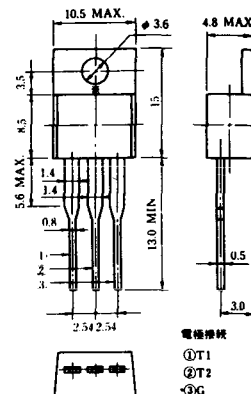

電線接続  
① T<sub>1</sub>  
② T<sub>2</sub>  
③ G

# NT-5

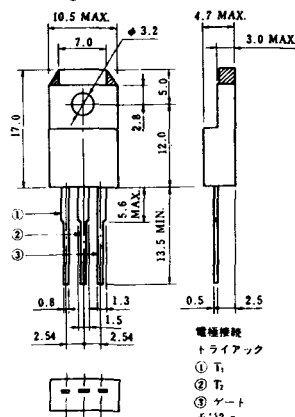

電線接続  
トリアック  
① T<sub>1</sub>  
② T<sub>2</sub>  
③ ゲート  
④ 2K

# NT-6

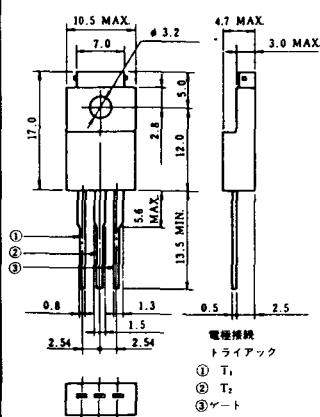

電線接続  
トリアック  
① T<sub>1</sub>  
② T<sub>2</sub>  
③ ゲート  
④ 2K

# NT-7

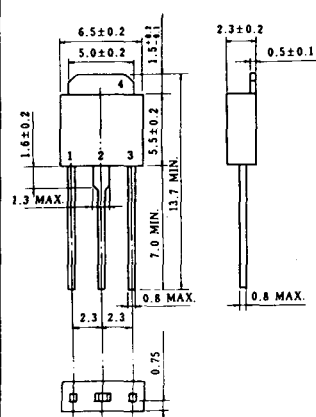

# NT-8

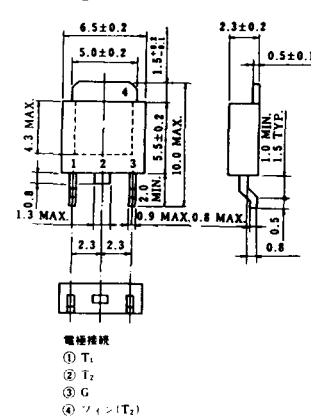

電線接続  
① T<sub>1</sub>  
② T<sub>2</sub>  
③ G  
④ T<sub>1</sub> (T<sub>2</sub>)



SA-1

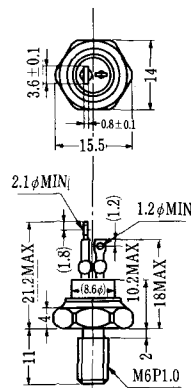

SA-2

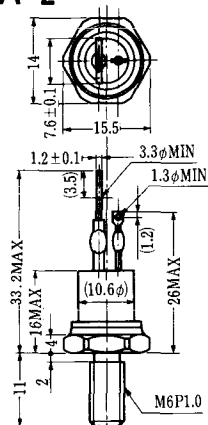

SA-3

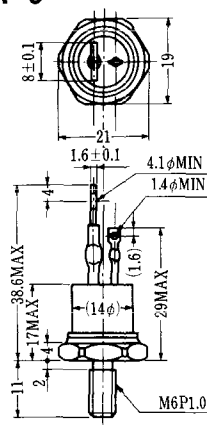

SA-4

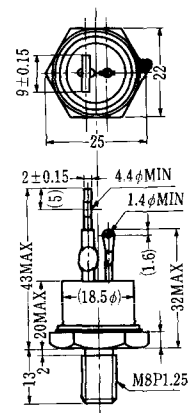

SA-5

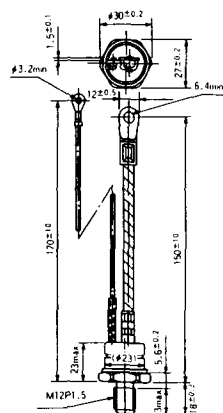

SA-6

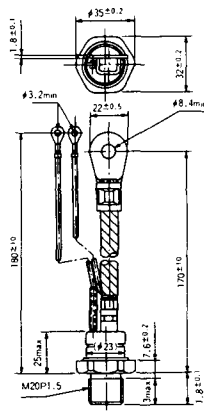

SA-7

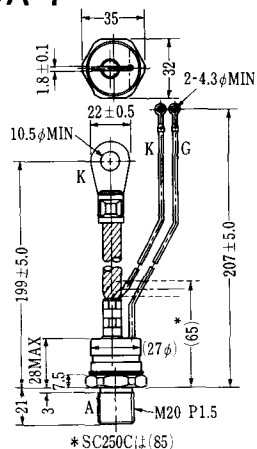

SA-8

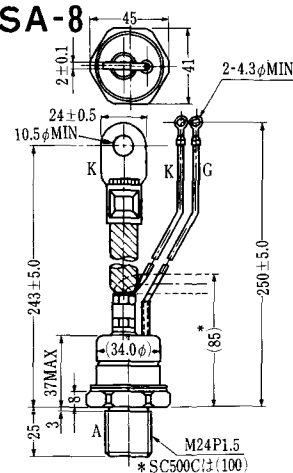



# SAT-1

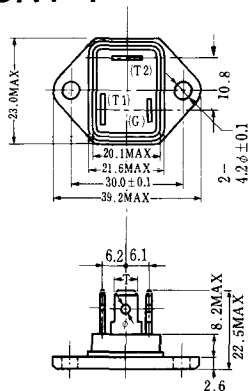

T1端子:ファストン250( $T=6.35$ ,  $t=0.8$ ,  $\phi=1.65$ )  
T2端子:ファストン250( $T=6.35$ ,  $t=0.8$ ,  $\phi=1.65$ )  
G端子:ファストン187( $T=4.75$ ,  $t=0.5$ ,  $\phi=1.3$ )

**SAT-2**

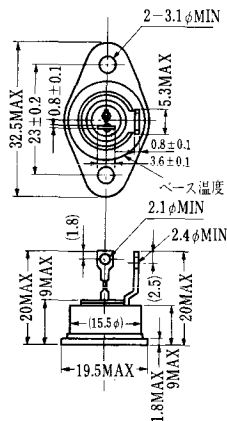

**SAT-3**

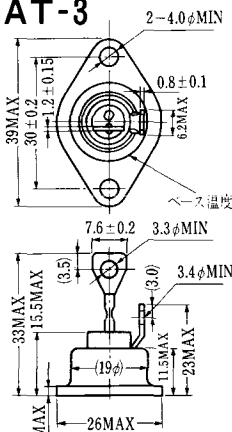

SAT-4

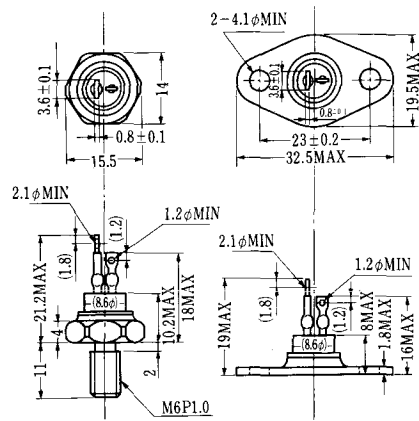

**SAT-5**

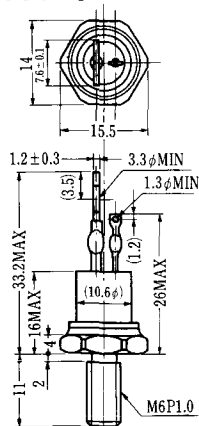

SAT-6

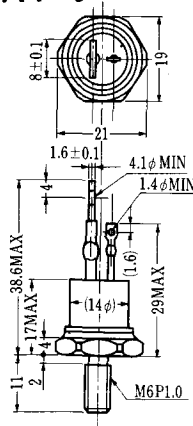

SAT-7

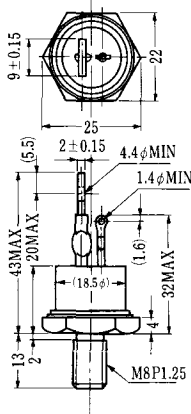

SAT-8

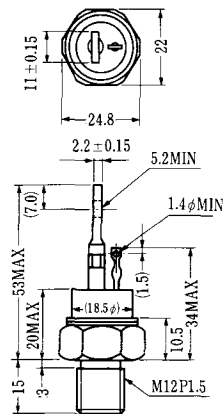

SAT-9.

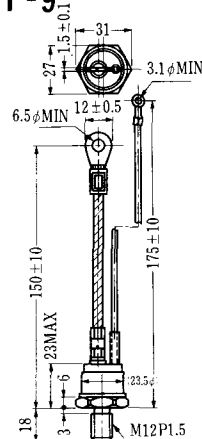

**SAT-10**

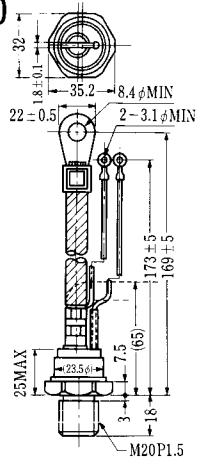

**SAT-11**

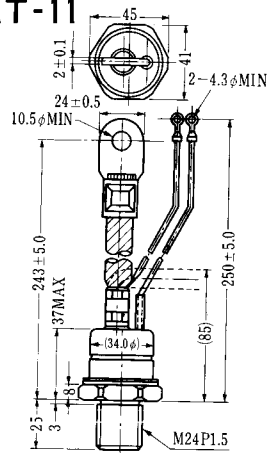

**SY-1**(1096A)

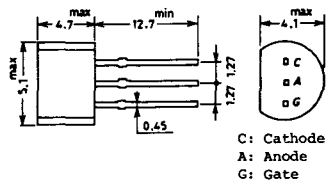

**SY-2**(1151)

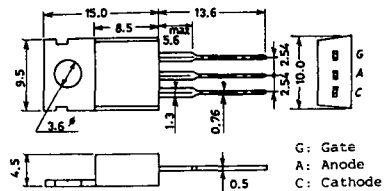

**SY-3**(1104)

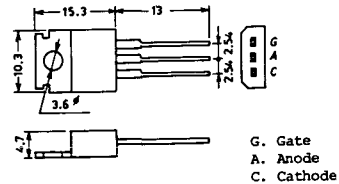

**SY-4**(1150)

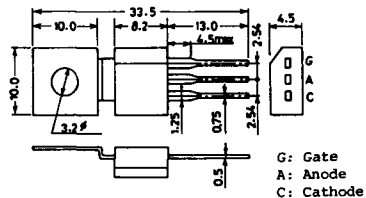



1097A

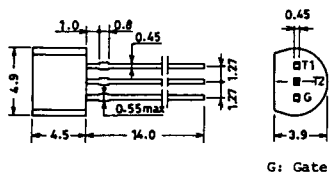

G: Gate

1102

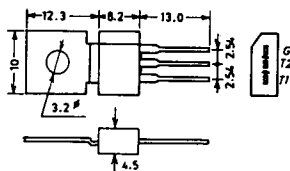

1141

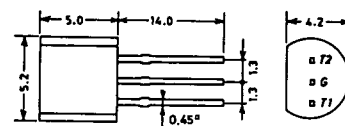

1142

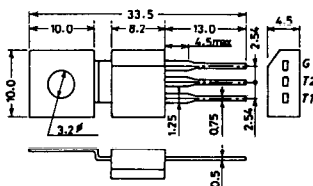

1144

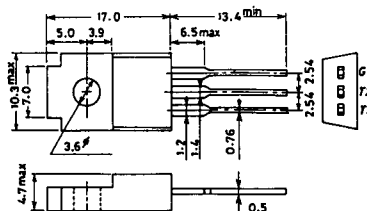

1155

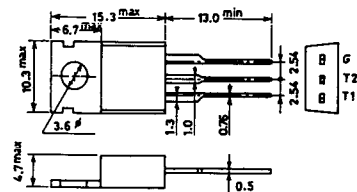

1192A

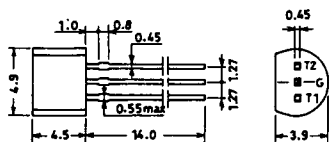

G: Gate





T-17 (13-42A1A)

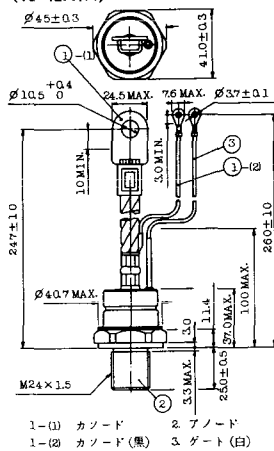

T-18 (13-45D1A)

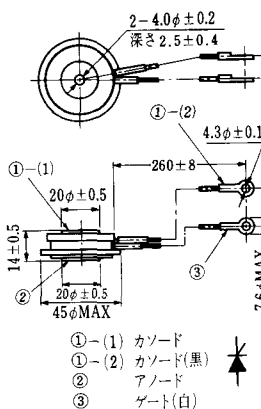

T-19 (13-52B1A)

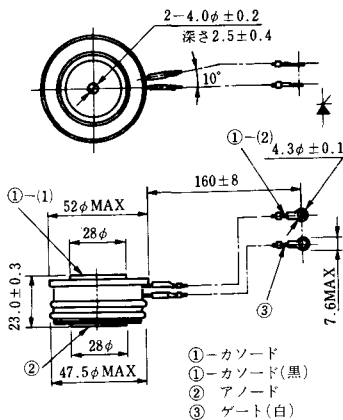

T-20 (13-52C1A)

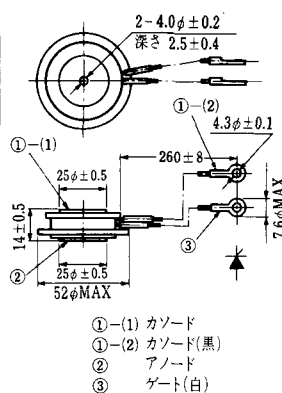

T-21 (13-60A1A)

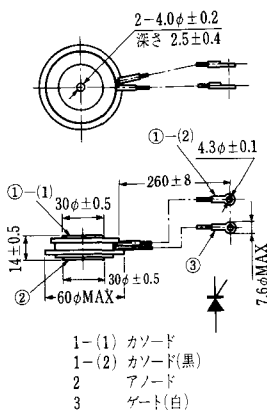

T-22 (13-70C1A)

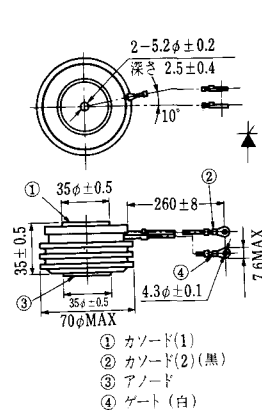

T-23 (13-78A1A)

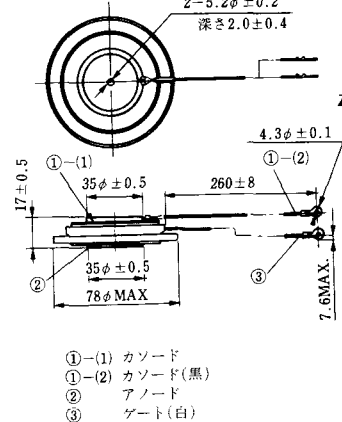

T-24 (13-100C1A)

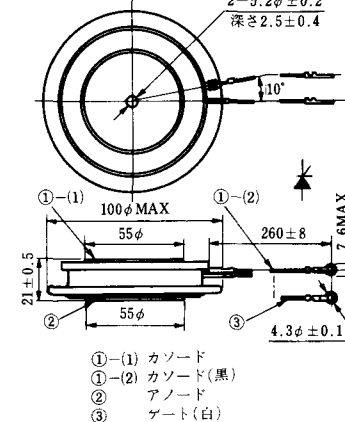

**T-25** (13-120A2A)

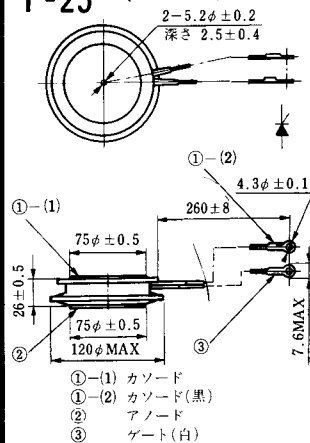

**T-26** (13-150A1A)

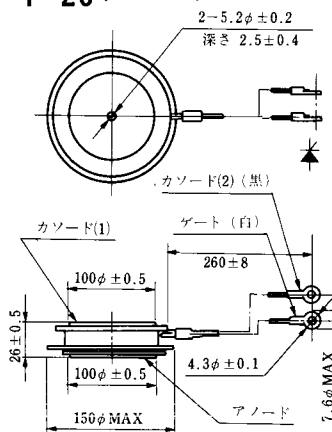

**T-27** (13-37A1A)

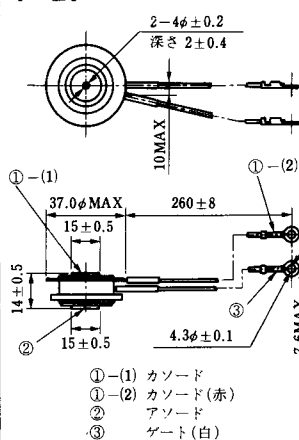

**T-28** (13-45E1A)

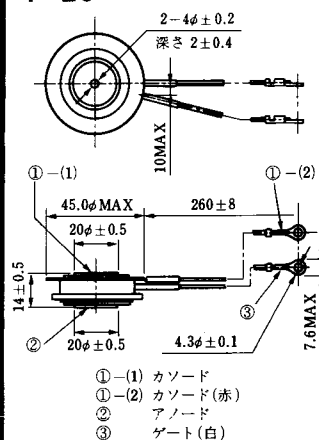

**T-29** (13-51A1A)

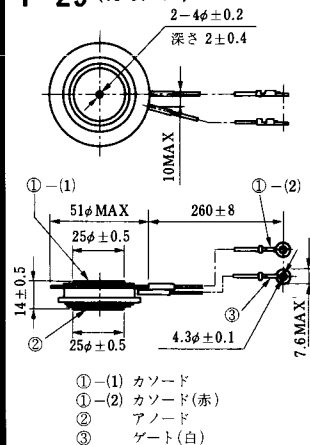

**T-30** (13-57A1A)

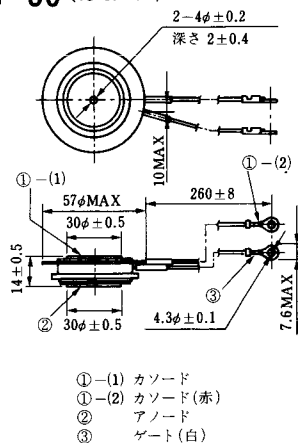

**T-31** (13-100E1A)

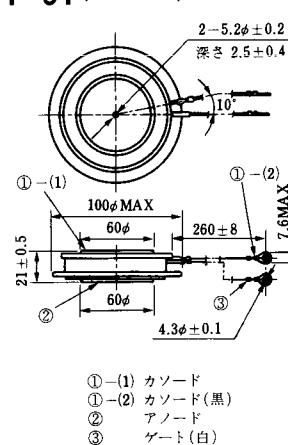

**T-32** (13-60E3A)

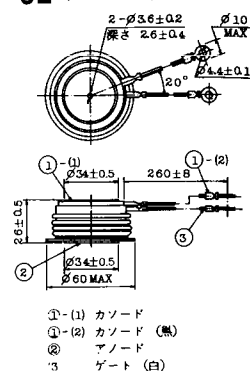



# T-41 (13-28A2A)

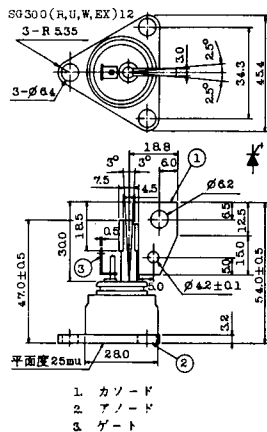

# T-42 (13-45F1A)

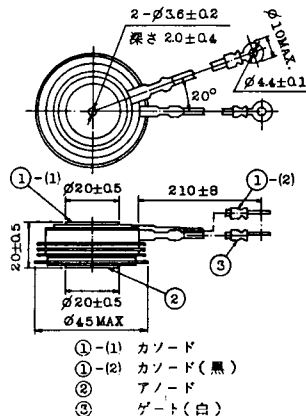

# T-43 (13-60E2A)

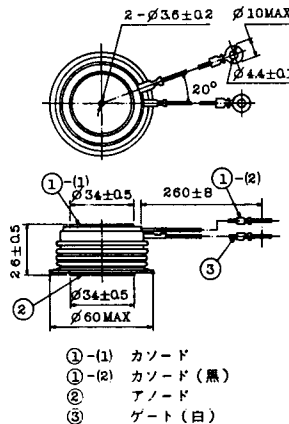

# T-44 (13-36A1A)

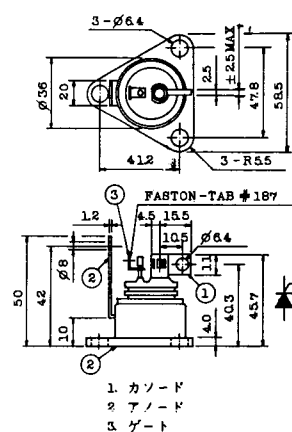

# T-45 (13-51B1A)

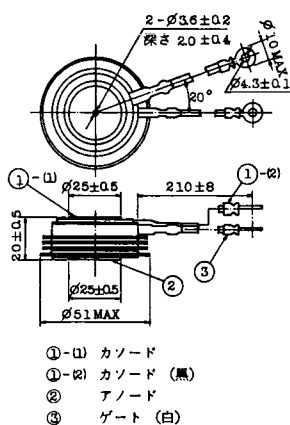

# T-46 (13-36B1A)

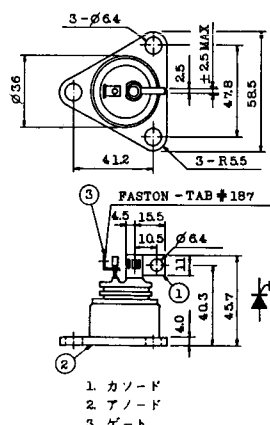

# T-47 (13-60E1A)

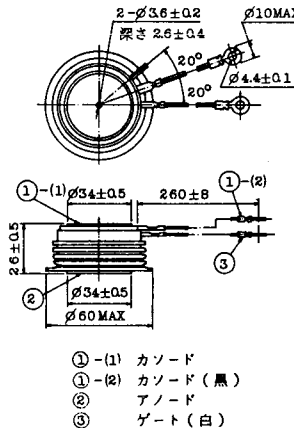

# T-48 (13-93C1A)

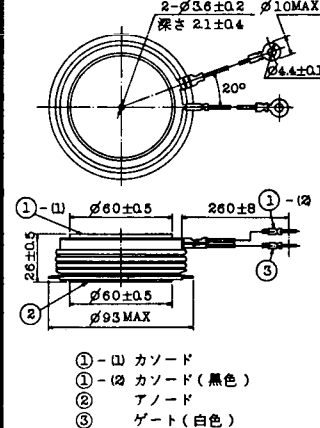

T-49 (13-75A1A)

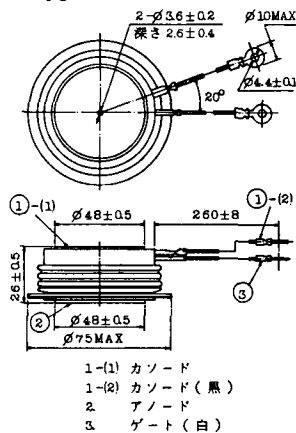

T-50 (13-10A3A)

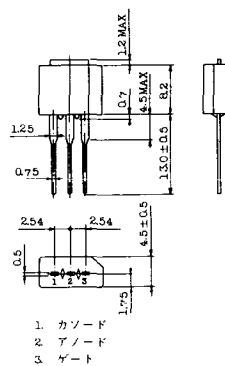

T-51 (13-10D1A)

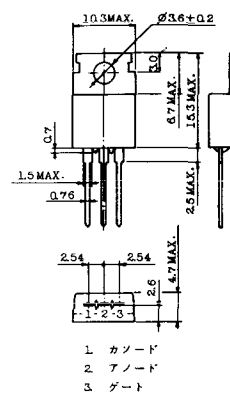

T-52 (13-10D2A)

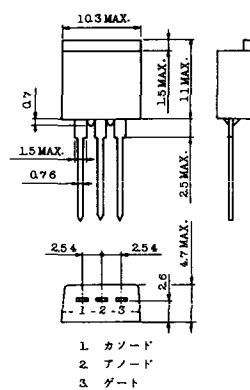

T-53 (13-10E1B)

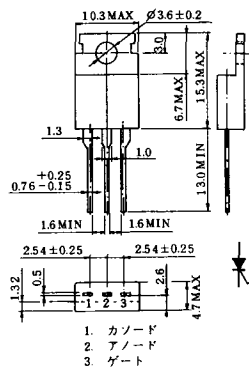

T-54 (13-10F1B)

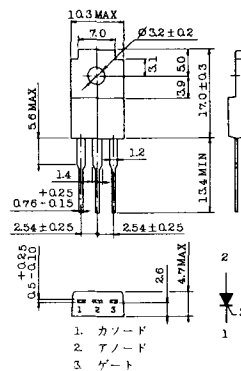

T-55 (13-5A1D)

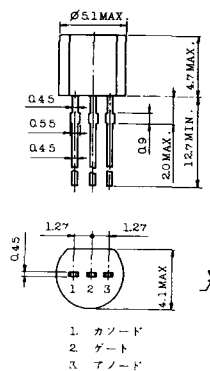

T-56 (13-13C1A)

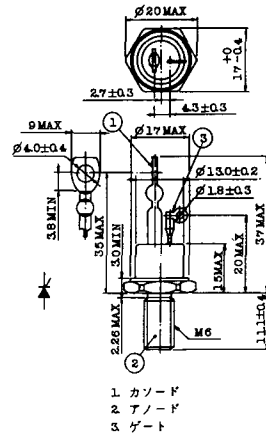





TT-1

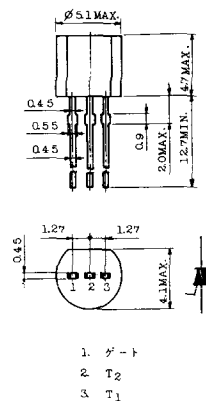

TT-2

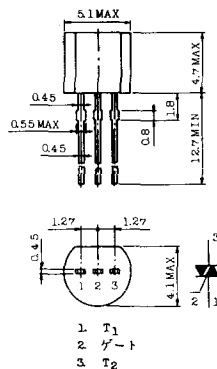

TT-3

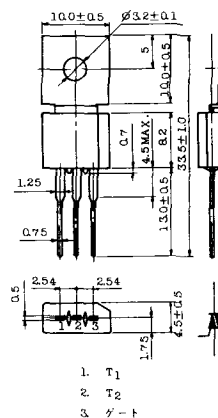

TT-4

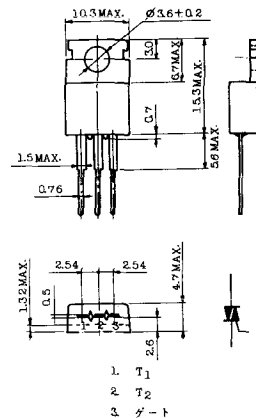

TT-5

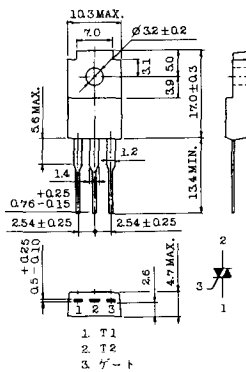

TT-6

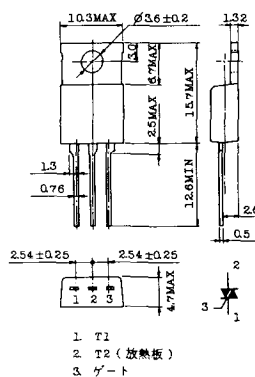

TT-7

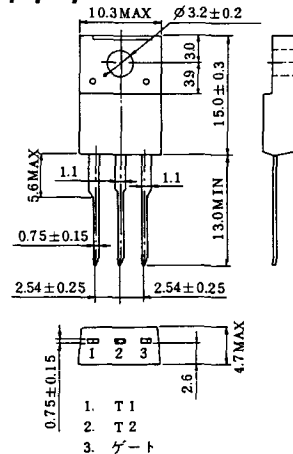

TT-8

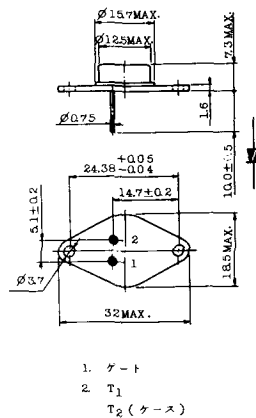



TS - 1

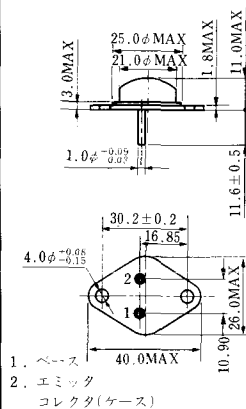

TS - 2

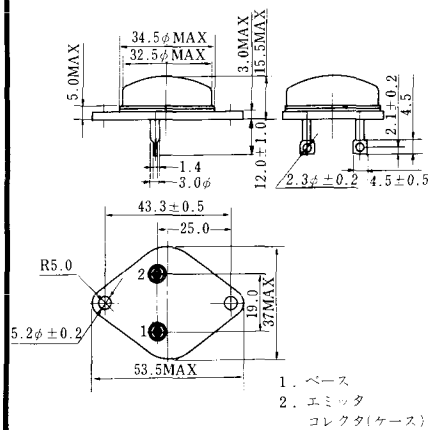

TS-3

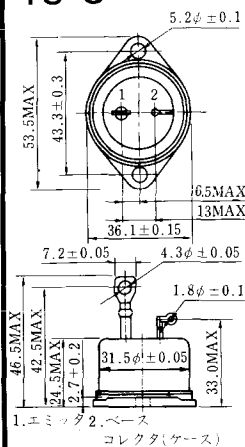

TS-4

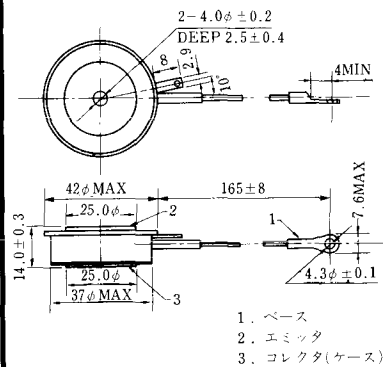

TS-5

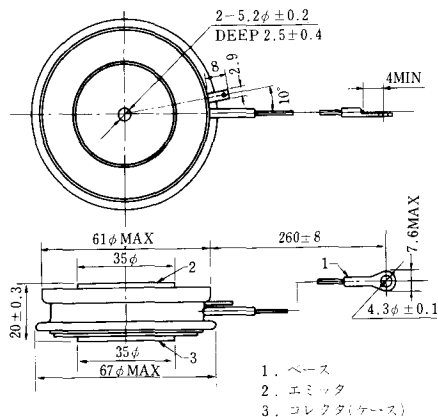

TS-6

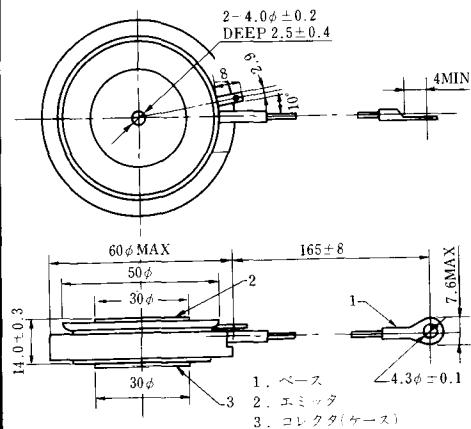

TS-7

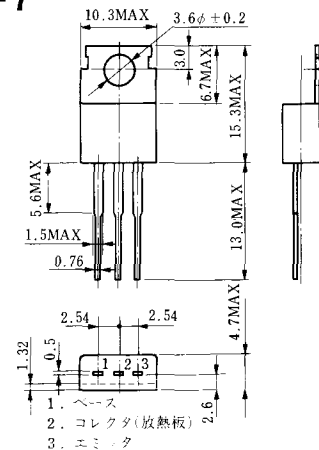



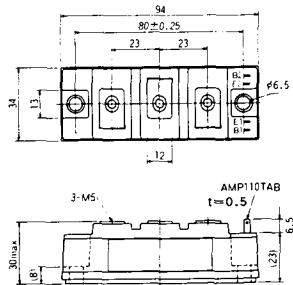
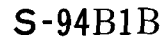
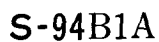
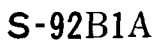
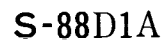
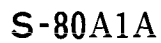



S-108B1A

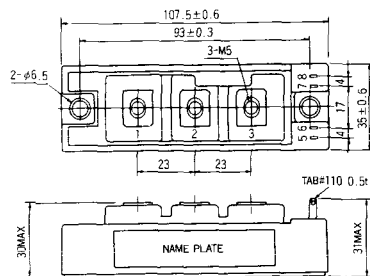

S-108B1B

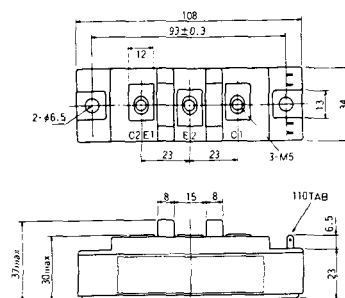

S-108B1C

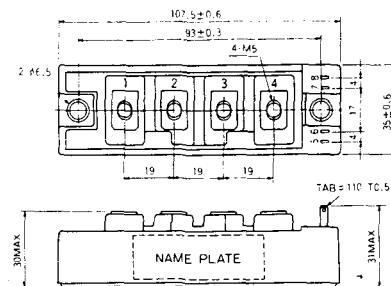

S-108B2A

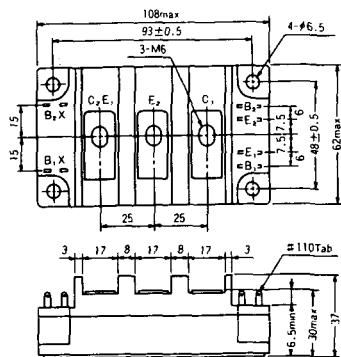

S-108B2B

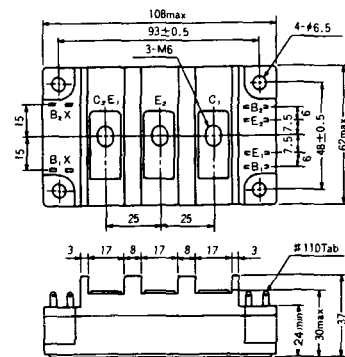



2-22B1A

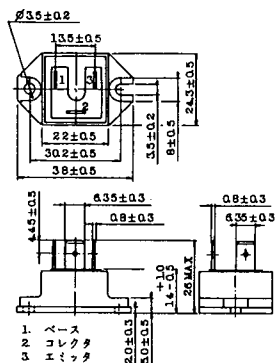

2-27A4A

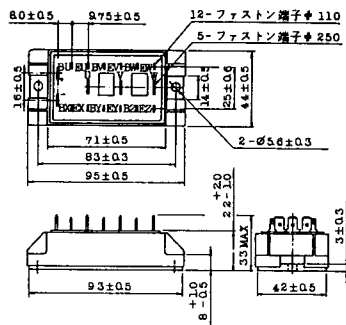

2-33C1A

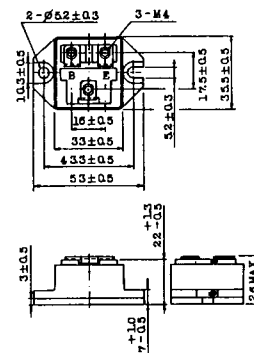

2-33D1A

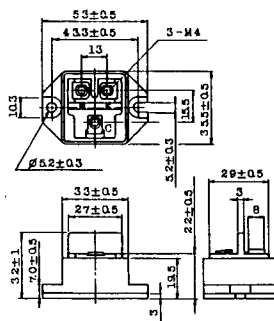

2-33F1A

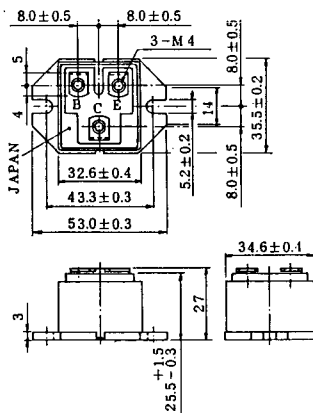

2-37A1A

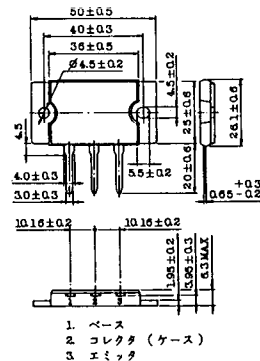

2-48A3A

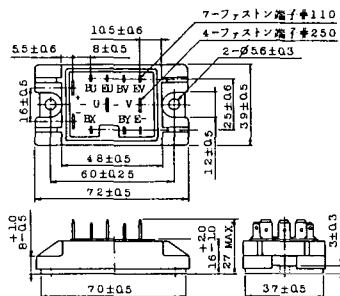

2-48A3B

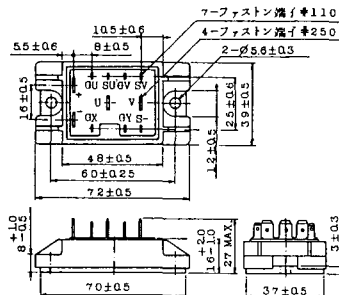

2-48A4A

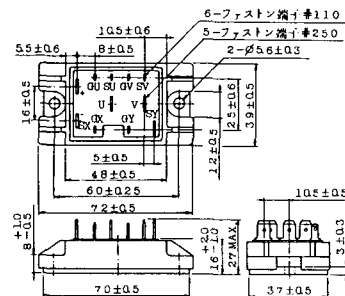

2-64A2A

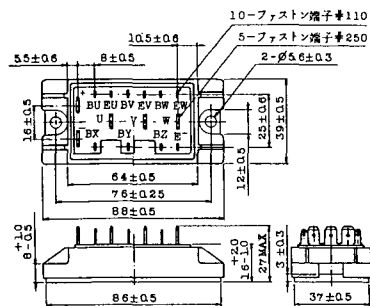

2-64A2B

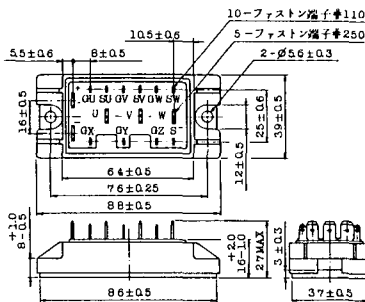

2-68A2A

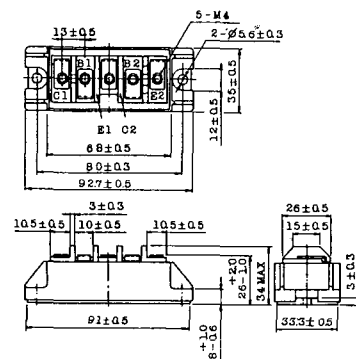







## 2-108B1A

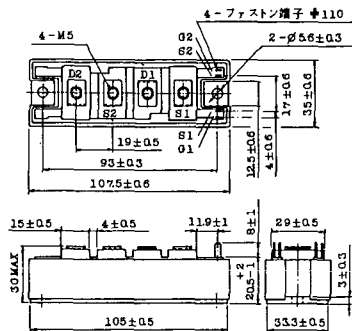

## 2-109A3A

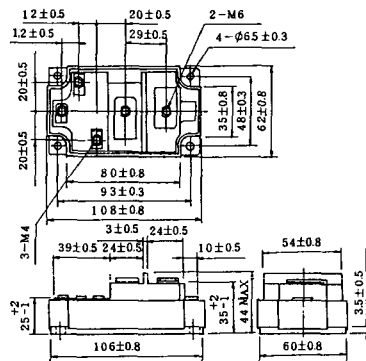

## 2-109A4A

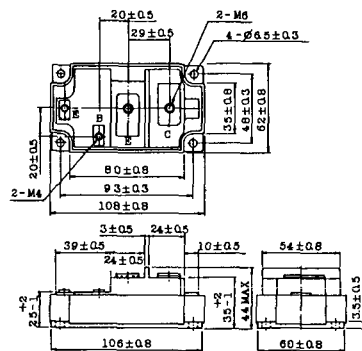

## 2-109B3A

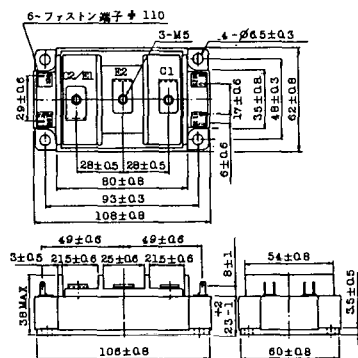

## 2-109B4A

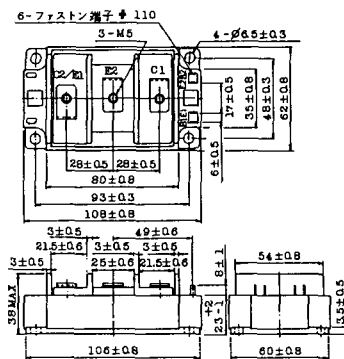

# BBT-II

BBTII  
1D200A-020

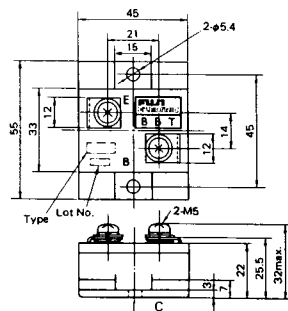

# BBT-III

BBTIII  
ETN31-055  
ETM36-030  
ETN36-030  
ETN35-030

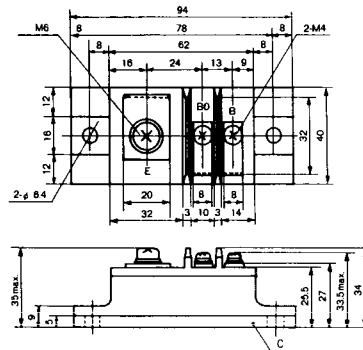

# BBT-III

BBTIII  
ETN01-055  
ET1257

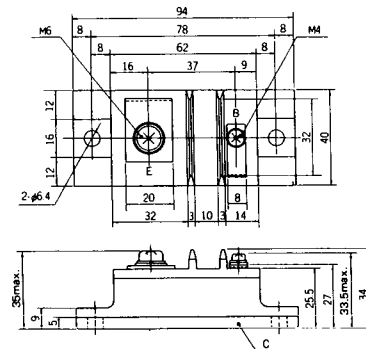

# BBT-IV

BBTIV  
1D500A-030

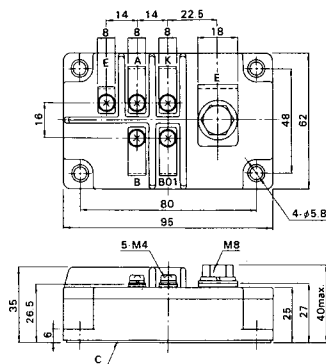

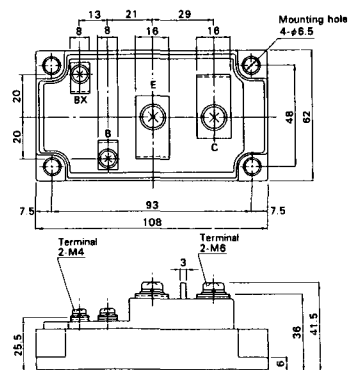
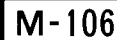
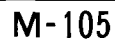
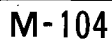
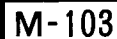
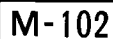



# M-107

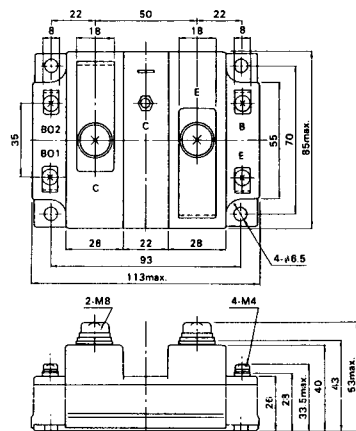

# M-116

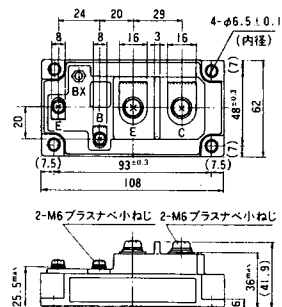

M-201

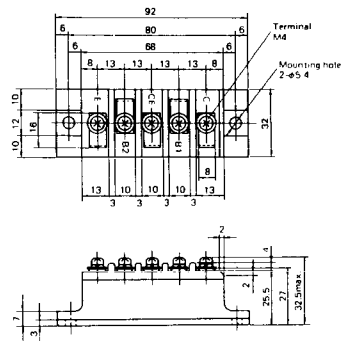

M-202

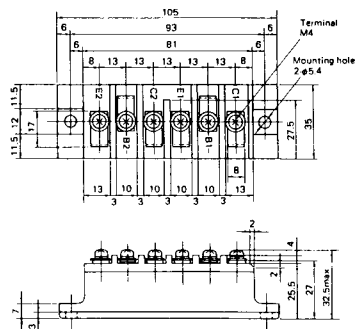

M-203

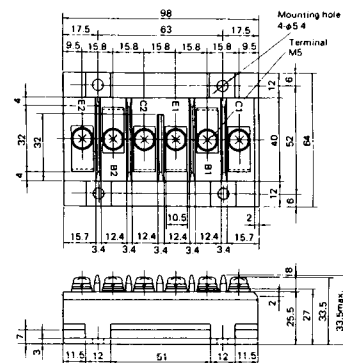

M-204

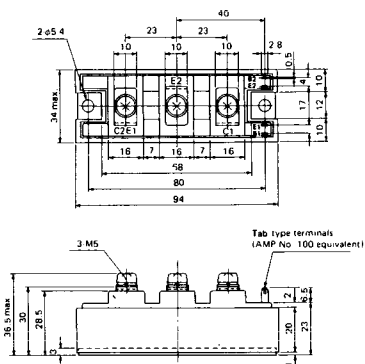

M-205

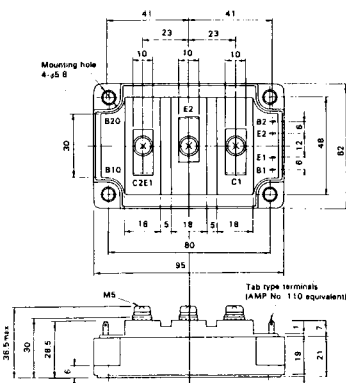

M-206

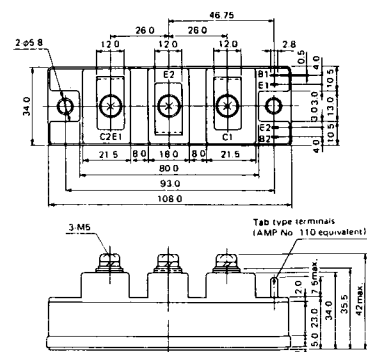

M-207

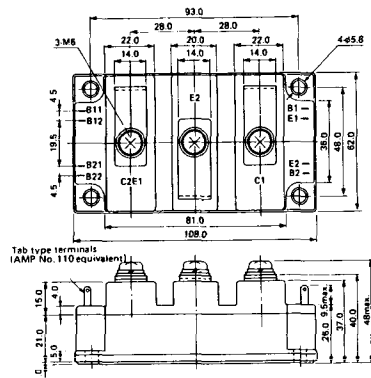

M-208

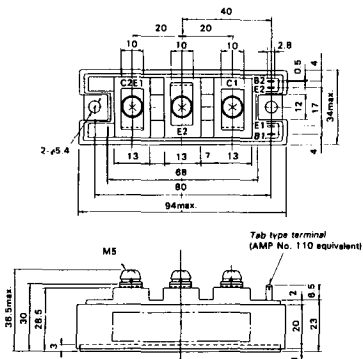

M-209

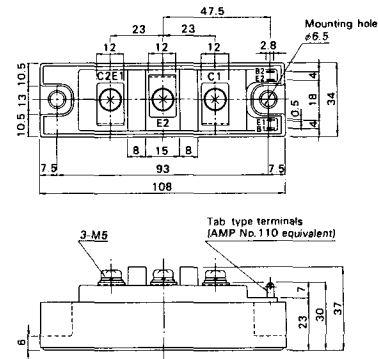

M-210

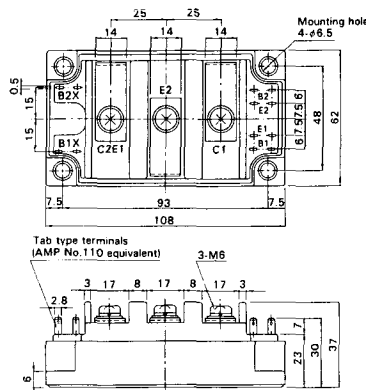

M-211

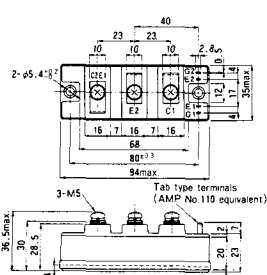

M-212

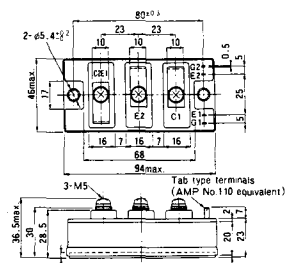

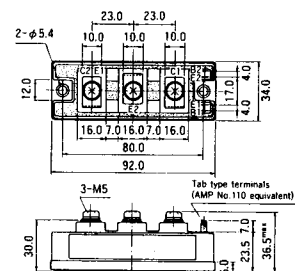
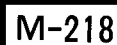
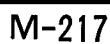
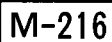
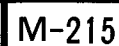
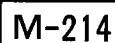



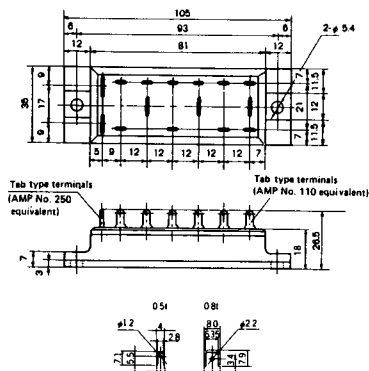
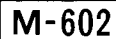

**M-603**

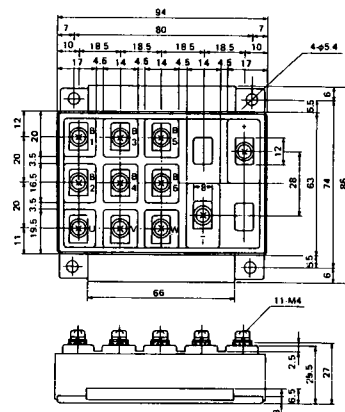

**M-604**

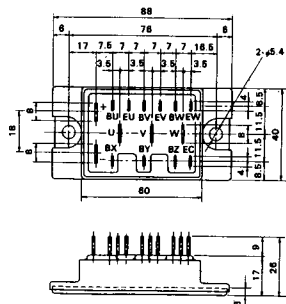

**M-605**

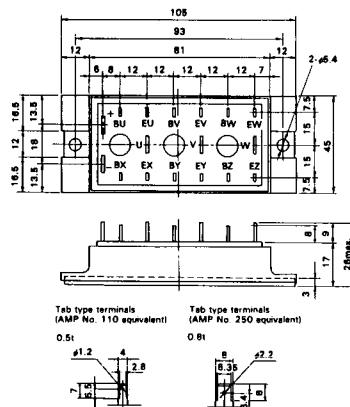

**M-606**

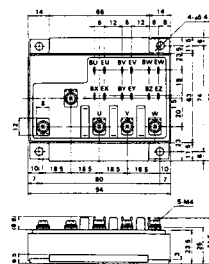







# M-2E6A

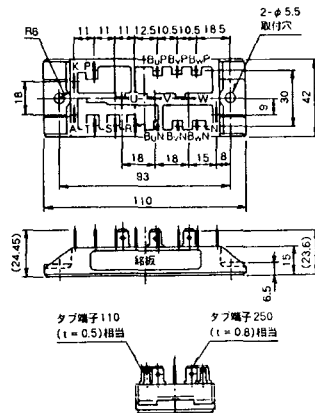

# M-2F6A

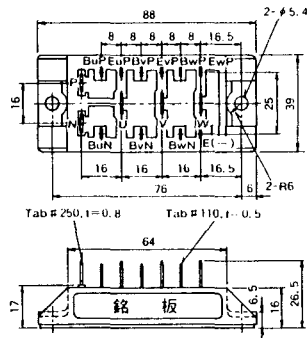

# M-2G6A

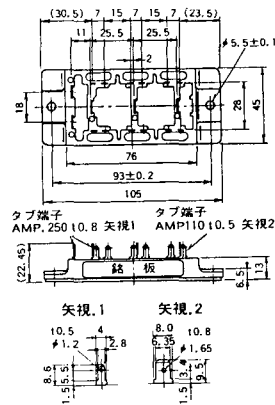

# M-3A1A

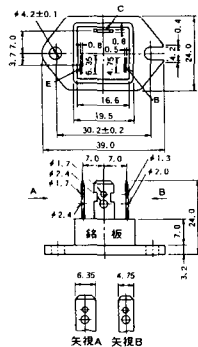

# M-3B1A

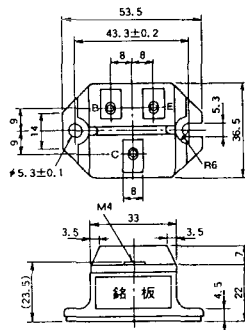

# M-3B1B

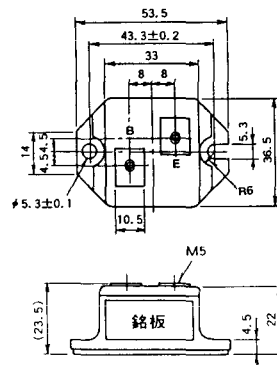

M-3C1A

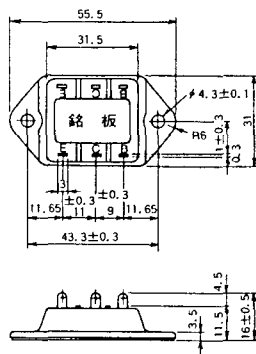

M-3D6A

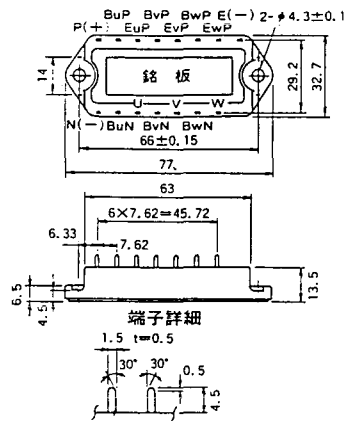

M-3E6A

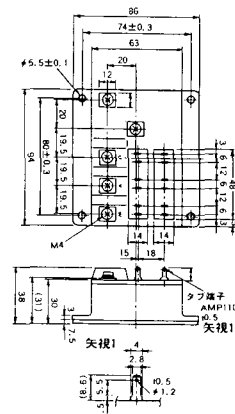

M-4A1A

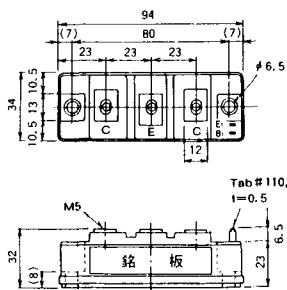

M-4A2A

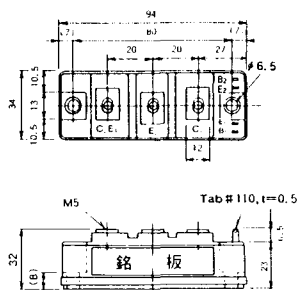

M-4A1B

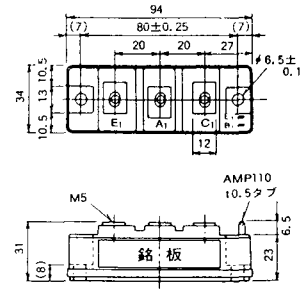

M-4A2B

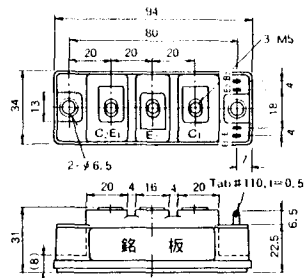

M-4B2A

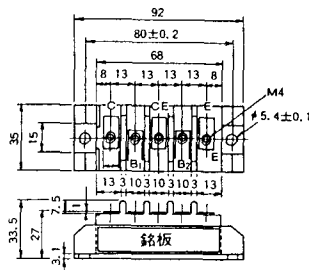

M-5A1A

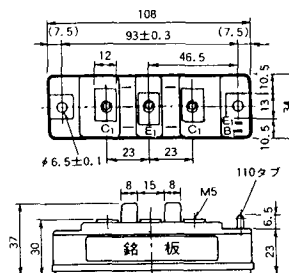

M-5A1B

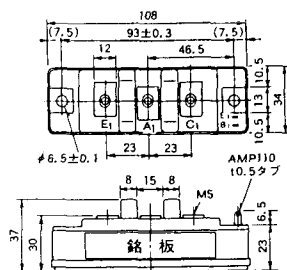

M-5A2A

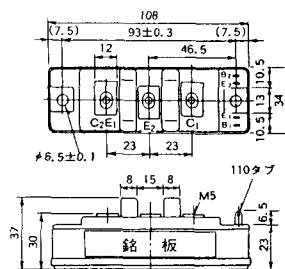

M-5B2A

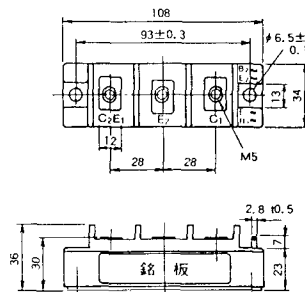

M-5C2A

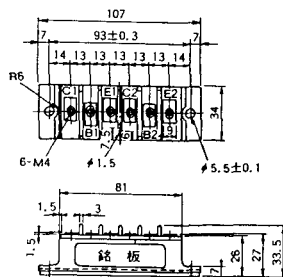

M-5D2A

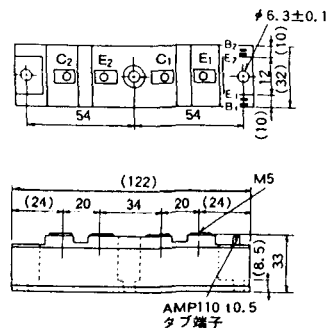

M-6A1A

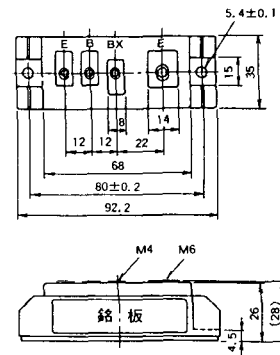

M-7A1A

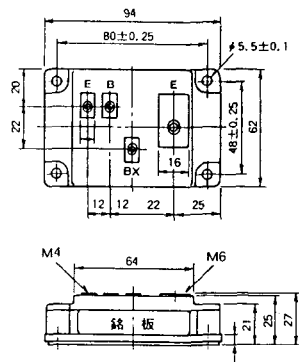

M-7B1A

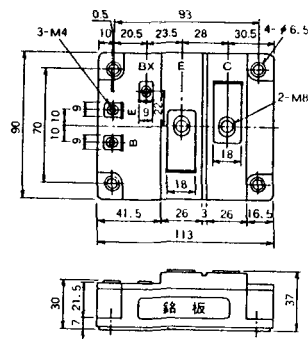

M-8A1A

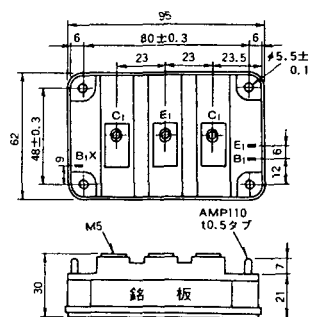

M-8A1B

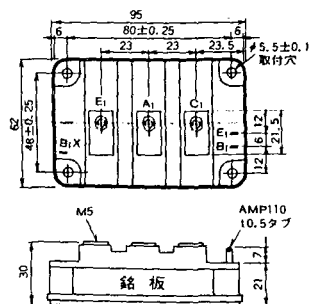

M-8A2A

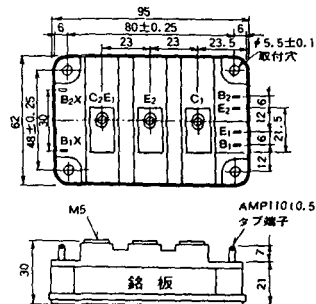

M-8A2B

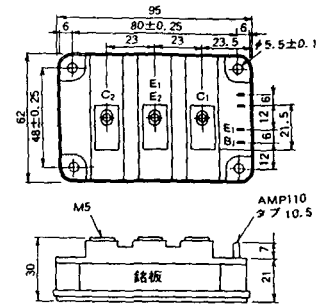

M-8B2A

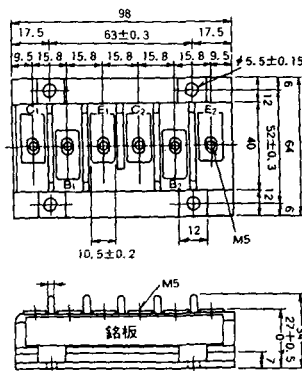

M-9A1A

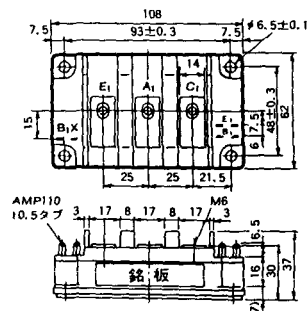

M-9A2A

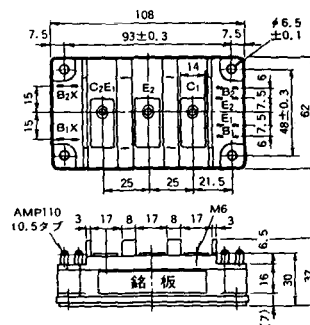

M-9B1A

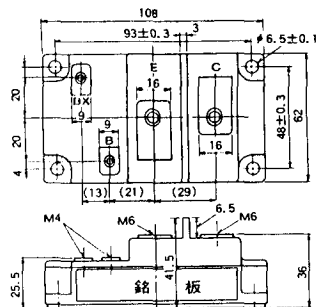

M-9C2A

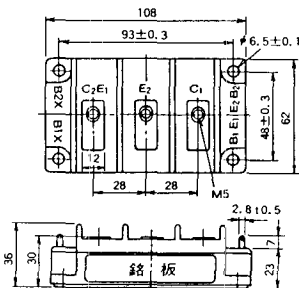

M-1A1B

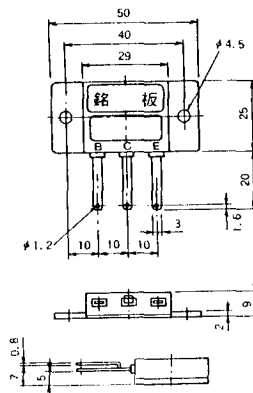

M-1A1C

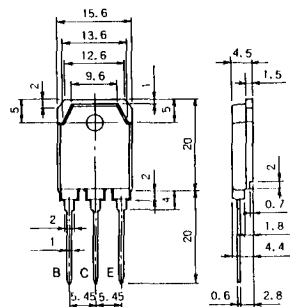

M-2E6B

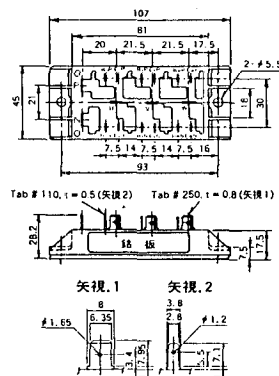

M-2E6C

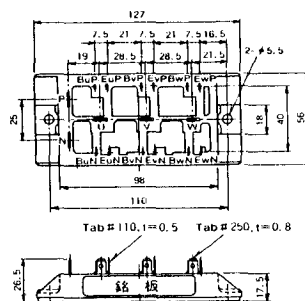



M-10A2A

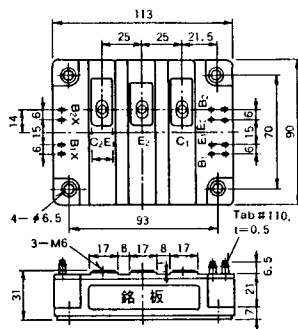

M-10A2B

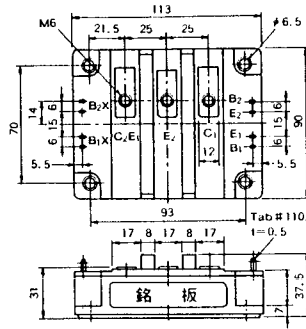

M-11A2A

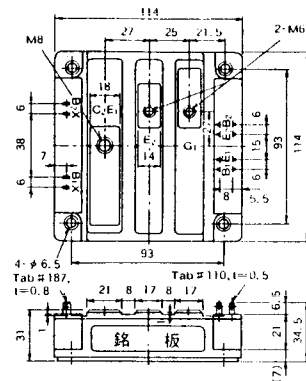

M-12A6A

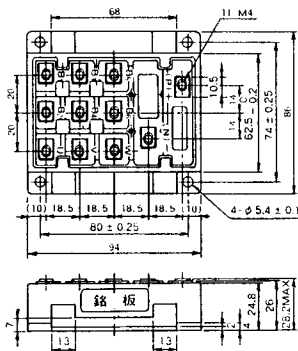

M-12B6A

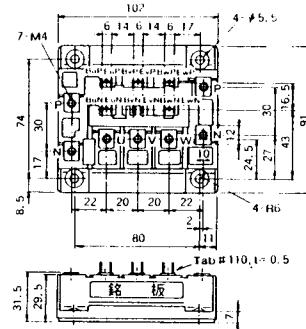

M-12B6B

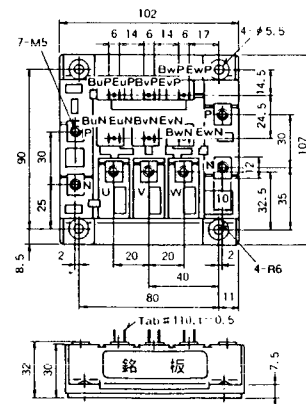



M-4A2D

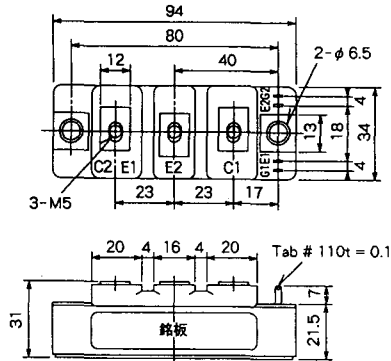

M-4A2E

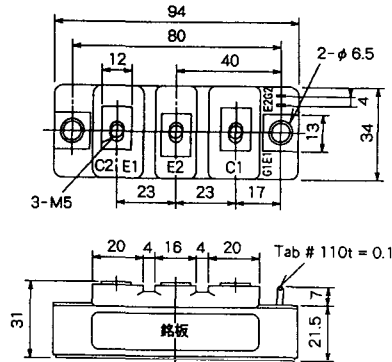

M-4C2A

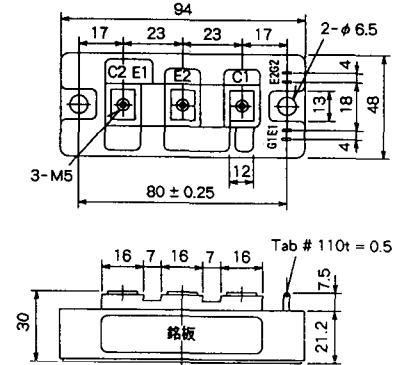

M-4C2B

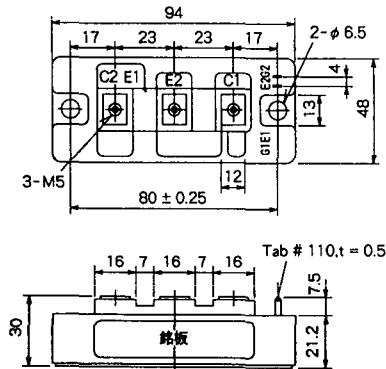

M-9B1C

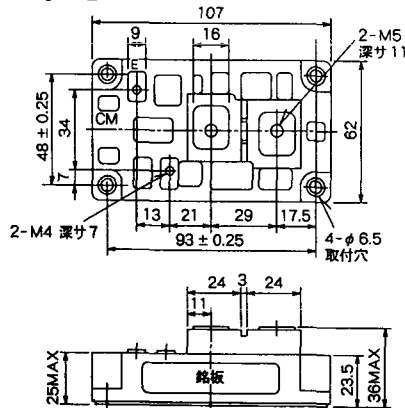

M-9D2A

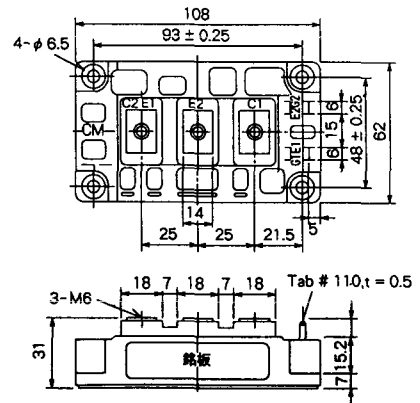

M-9D2B

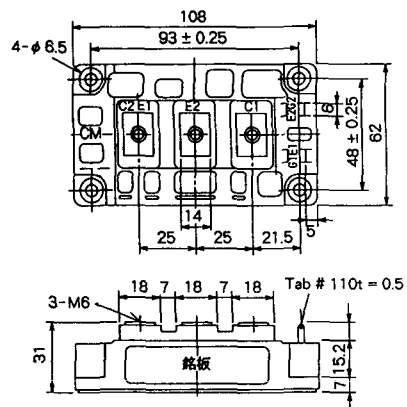

M-10A2C

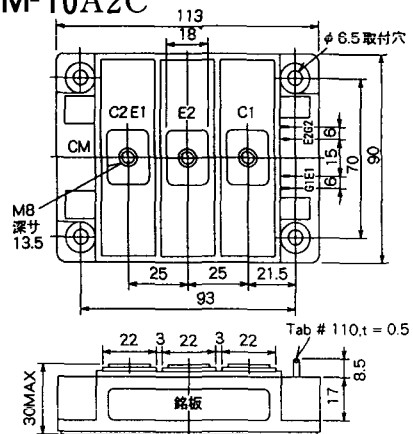

H-101

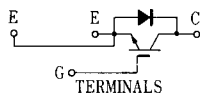
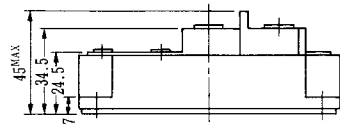
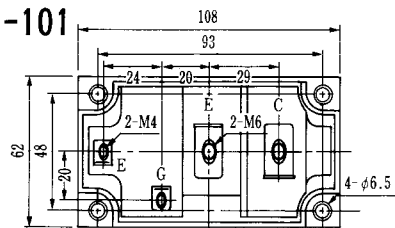

Weight :480g

TERMINALS

# H-201

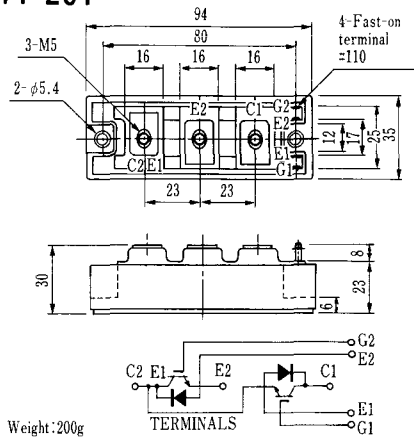

# H-202

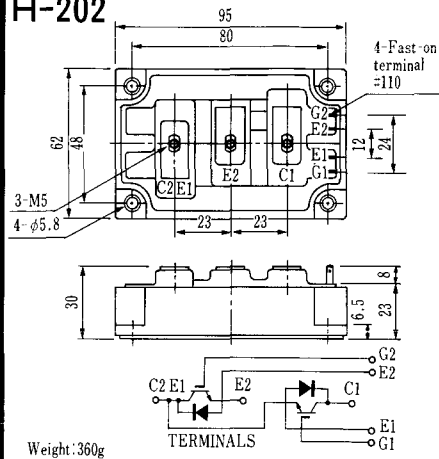

# LF-J

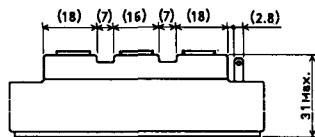
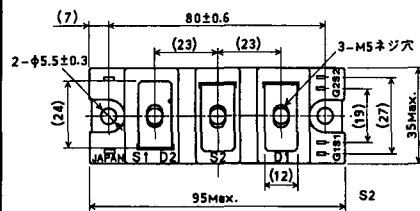

# LF-K

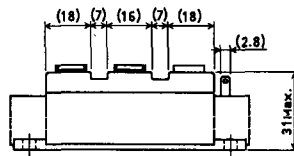
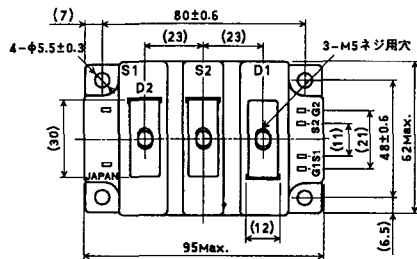

U-1

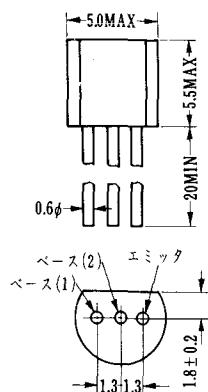

U-2

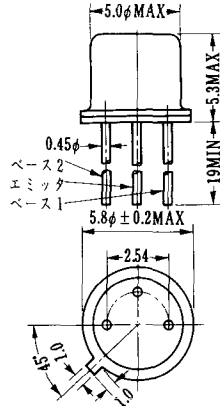

U-3

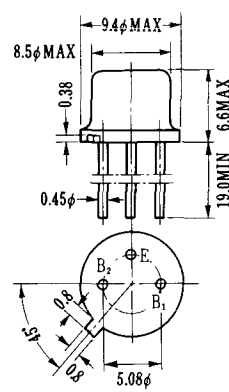

U-4

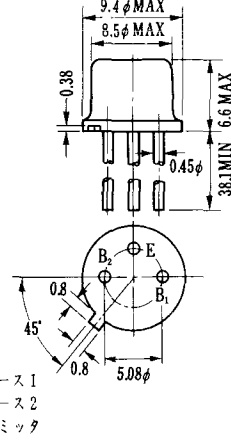

U-5

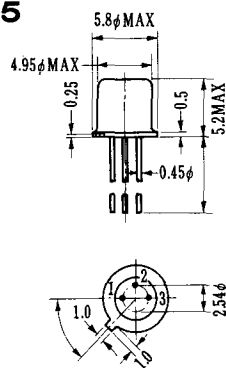

1. BASE 1  
2. EMITTER  
3. BASE 2 (CASE)

U-6

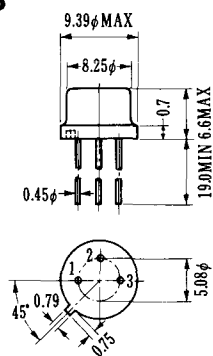

1. BASE (2)  
2. EMITTER  
3. BASE (1)

U-7

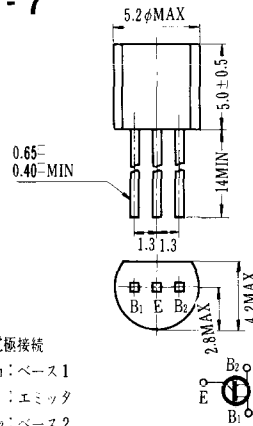

U-8

